

FOR SALE

£789,000

Conway Crescent, Perivale, Greenford, Greater London. UB6

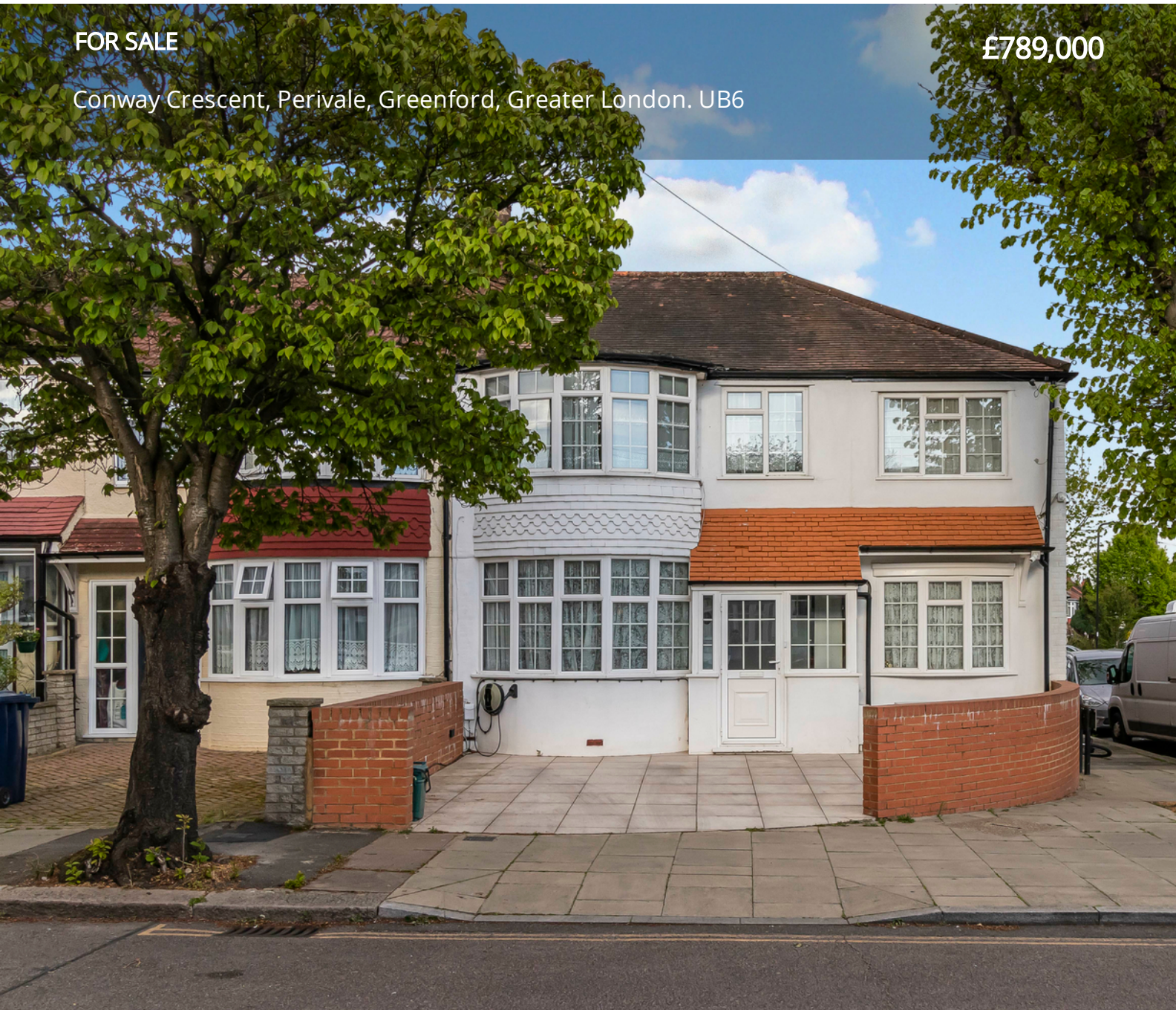

Peter Gamble & Co. offer to the market this beautifully presented 5 BEDROOM, 2 BATHROOM end of terrace home.

Situated in the popular Medway Village benefiting from local shops and well regarded schools with Perivale tube station just 9

minutes walk away.

To the ground floor the property comprises bright thru lounge, extended modern fitted kitchen with utility and laundry area.











## 82 Conway Crescent





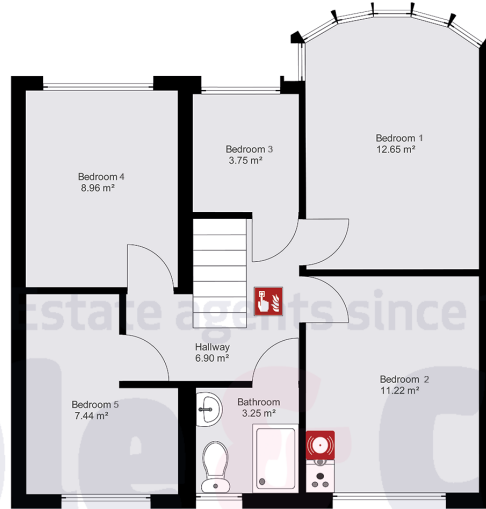

**Ground Floor**



**First Floor**

Key:

-  **Smoke/Fire Alarm**
-  **Carbon Monoxide Detector**
-  **Gas Boiler**
-  **Air Conditioning**

**APPROX. GROSS INTERNAL FLOOR AREA: 136 sq. m**

WHILST EVERY ATTEMPT HAS BEEN MADE TO ENSURE THE ACCURACY OF THE FLOOR PLAN CONTAINED HERE, NO RESPONSIBILITY IS TAKEN FOR ANY ERROR, OMISSION OR MIS-STATEMENT. THIS PLAN IS FOR ILLUSTRATIVE PURPOSES ONLY AND SHOULD BE USED AS SUCH

© Avasmo Energy