



Regal Court, Ainsdale,
PR8 3BU

**OFFERS OVER
£190,000**

SM

STEPHANIE MACNAB
ESTATE AGENT

Situated just a short walk from Ainsdale Village, this well-presented two-bedroom ground floor apartment forms part of the Regal Court development – a purpose-built scheme of 18 properties with attractive red brick façades, communal gardens and resident parking.

Built in 2002 and split across two blocks, the development is popular with those seeking peaceful yet conveniently located homes close to local shops, transport links and the coast.

The apartment is arranged as a hallway and features a spacious lounge with a bay window, and a fully fitted kitchen with integrated appliances and traditional cabinetry. There are two comfortable bedrooms, the main bedroom has a modern ensuite shower room, and a family bathroom, as well as useful built-in storage throughout, all set behind secure entry access and well-kept communal areas.

The property benefits from double glazing and gas central heating, and enjoys access to a shared garden space. Parking is provided at the rear as well as ample on street parking. Regal Court is a self-managed development with a strong community feel.

Call 01704 516 626 to arrange a viewing and follow us on Facebook and Instagram.





Ground Floor

Approx. 86.8 sq. metres (934.0 sq. feet)

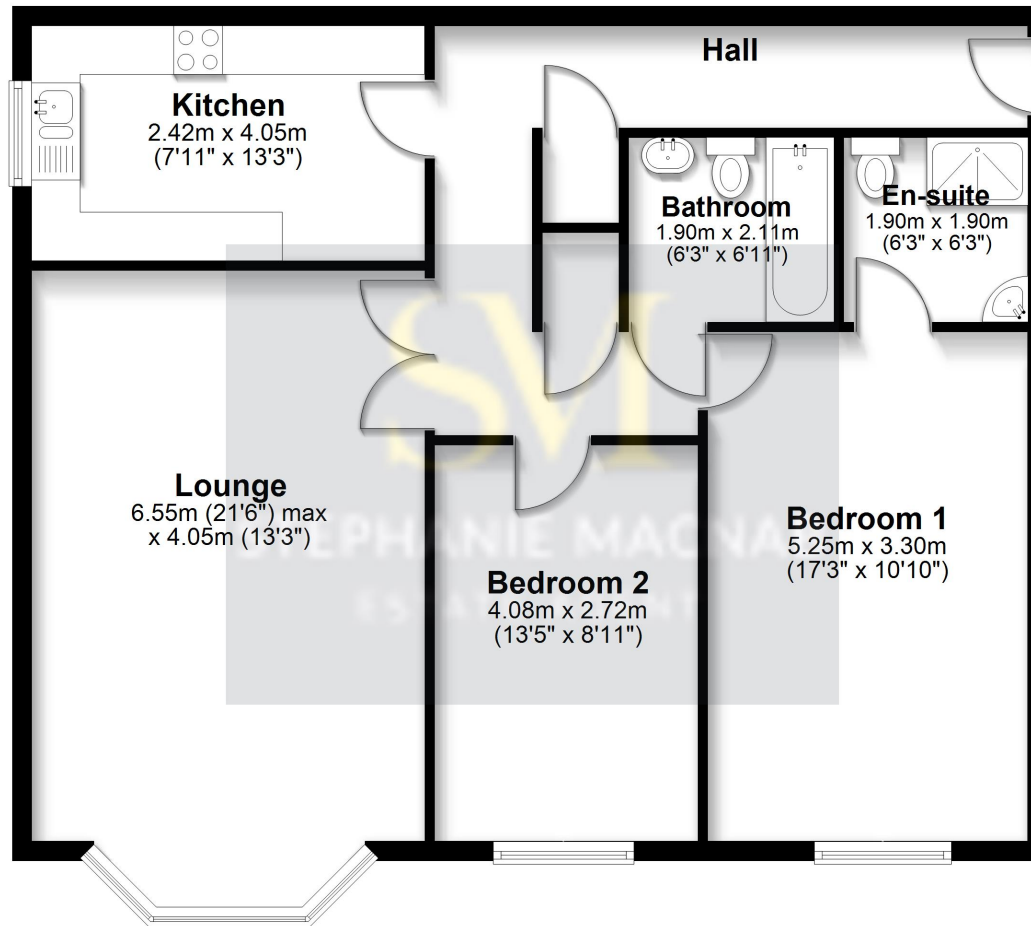

Total area: approx. 86.8 sq. metres (934.0 sq. feet)

This floorplan is for illustrative purposes only and is not to scale.
Plan produced using PlanUp.