



Hawthorn Croft, Stotfold, Hitchin, Hertfordshire. SG5 4RT





2 Bedroom Detached House

Guide Price £290,000 Freehold

Situated on the popular Beauchamp Mill development is this immaculate two bedroom detached FREEHOLD coach house with garden and parking for two cars.

Internally the accommodation comprises entrance hall with stairs rising to the first floor where the property has a landing with doors leading to a large, bright and airy open plan living space with lounge/dining area and a well-appointed kitchen with integrated appliances, two double bedrooms, one with fitted wardrobes, and a modern bathroom. Externally is a private, enclosed rear garden, a carport for one car with a further parking space in front and a secure storage area. Further benefits include gas central heating and double glazing. A super property that is ideal for first time buyers, investment buyers or a downsizer.

- Detached coach house
- Two double bedrooms
- Spacious open plan living space
- Fitted kitchen with integrated appliances
- Carport parking plus additional space
- Private rear garden
- Gas central heating
- Double glazing
- Estate charge approx. £240 per annum
- EPC rating B. Council tax band B

Ground Floor:**Front Door:**

Double glazed front door.

Entrance Hall:

Radiator. Stairs to first floor. Carpet as fitted.

First Floor:**Landing:**

Double glazed window to rear. Large storage cupboard.

Radiator. Inset ceiling lights. Carpet as fitted. Doors to all rooms.

Living/Kitchen/Dining Room:

Abt. 17' 11" x 17' 1" (5.46m x 5.21m) A spacious open plan living/kitchen/dining room with twin aspect double glazed windows to the front and a double glazed window to rear. The kitchen area is well appointed and comprises a good range of eye and base level units with ample roll edge work surfaces and an inset single drainer stainless steel one and half bowl sink unit. Built-in four ring gas hob, double electric oven and extractor hood. Integrated fridge/freezer, washing machine and dishwasher. Cupboard housing gas boiler. Tiled splashback area. The living/dining area has two radiators, television and telephone points. Inset ceiling lights. Wood effect flooring.

Bedroom One:

Abt. 14' 3" x 9' 7" (4.34m x 2.92m) Double glazed window to front. Radiator. Inset ceiling lights. Carpet as fitted.

Bedroom Two:

Abt. 14' 3" x 10' 8" (4.34m x 3.25m) Double glazed window to front. Built-in double wardrobe with sliding mirror doors. Radiator. Inset ceiling lights. Carpet as fitted.

Bathroom:

A white suite comprising panelled bath with mixer tap, shower over and a glass shower screen, pedestal wash hand basin and low level WC. Shaver point. Tiled splash back area. Double glazed window to rear. Extractor fan. Radiator. Vinyl flooring.

Outside:**Rear Garden:**

A private, enclosed courtyard garden that is fully paved. Large walk-in storage cupboard. Gated side access.

Parking:

A carport provides covered parking for one car with additional parking in front.





These particulars are a guide only and do not constitute an offer or a contract. The floor plan is for identification purposes only and not to scale. All measurements are approximate and should not be relied upon if ordering furniture, white goods and flooring etc. We have presented the property as we feel fairly describes it but before arranging a viewing or deciding to buy, should there be anything specific you would like to know about the property please enquire. Satchells have not tested any of the appliances or carried out any form of survey and advise you to carry out your own investigations on the state, condition, structure, services, title, tenure, and council tax band of the property. Some images may have been enhanced and the contents shown may not be included in the sale. Satchells routinely refer to 3rd party services for which we receive an income from their fee. If you would like us to refer you to one of these services please ask one of our staff who will pass your details on. We advise you check the availability of the property on the day of your viewing.

First Floor

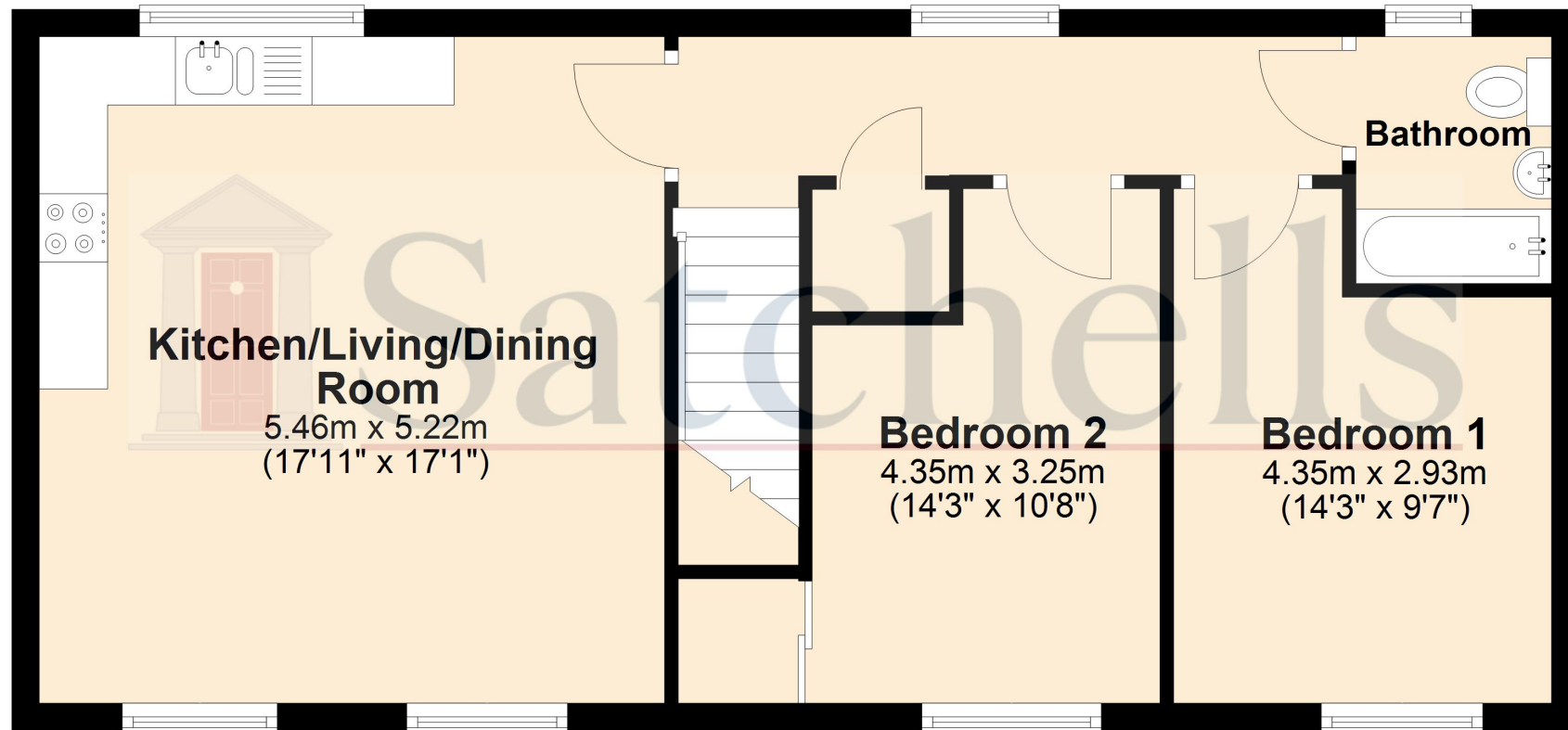

For illustrative purposes only - NOT TO SCALE - Measurements shown are approximate. The size and position of doors, windows, appliances and other features are approximate.

Plan produced using PlanUp.