



Day & Co  
ESTATE AGENTS

28 Cavendish Street  
Keighley  
BD21 3RG



54 Ling Park Avenue, Wilsden,  
Bradford, West Yorkshire, BD15  
0NE

£295,000

T: 01535 664609

W: [www.dayandcoestateagents.co.uk](http://www.dayandcoestateagents.co.uk)

E: [keighley@dayandcoestateagents.co.uk](mailto:keighley@dayandcoestateagents.co.uk)

- DETACHED BUNGALOW
- SPACIOUS LOUNGE/DINER
- GARDENS, UNDERHOUSE GARAGE

- THREE BEDROOMS
- ELEVATED POSITION
- EPC RATING D

## SUMMARY

\* DETACHED THREE BEDROOM BUNGALOW, SPACIOUS LOUNGE/DINER, ATTRACTIVE ACCOMMODATION, DRIVEWAY AND UNDERHOUSE GARAGE, POPULAR RESIDENTIAL LOCATION, ELEVATED POSITION, EPC RATING D \*

## FULL DESCRIPTION

Day & Co are pleased to be marketing this three bedroom detached bungalow situated in an elevated position in the popular village of Wilsden. Offering well presented living accommodation on one level, this property is well worthy of an internal inspection and benefits from both gas heating and uPVC double glazing.

The accommodation briefly comprises of an entrance hallway with storage cupboard, Cloaks/shower room with good sized shower, w.c., wash basin. A real feature of this property is its spacious lounge/diner with bay window to the front and French doors to the rear opening into the conservatory. The Kitchen has a range of fitted wall and base units, worktops, sink, built in oven, hob, microwave, integrated fridge freezer, integrated dishwasher. Three bedrooms and completing the accommodation is a house bathroom with modern suite comprising of a bath, vanity wash basin, storage cupboards, w.c and towel radiator.

Outside the property is complemented by good sized front garden with sitting area, driveway leading to an underhouse garage with power and light 6.5m x 2.5m. At the rear is a garden.

The property is situated in an elevated position with steps leading up to the property. Wilsden village offers a range of shops and amenities, public houses and a primary school.

EPC Rating D

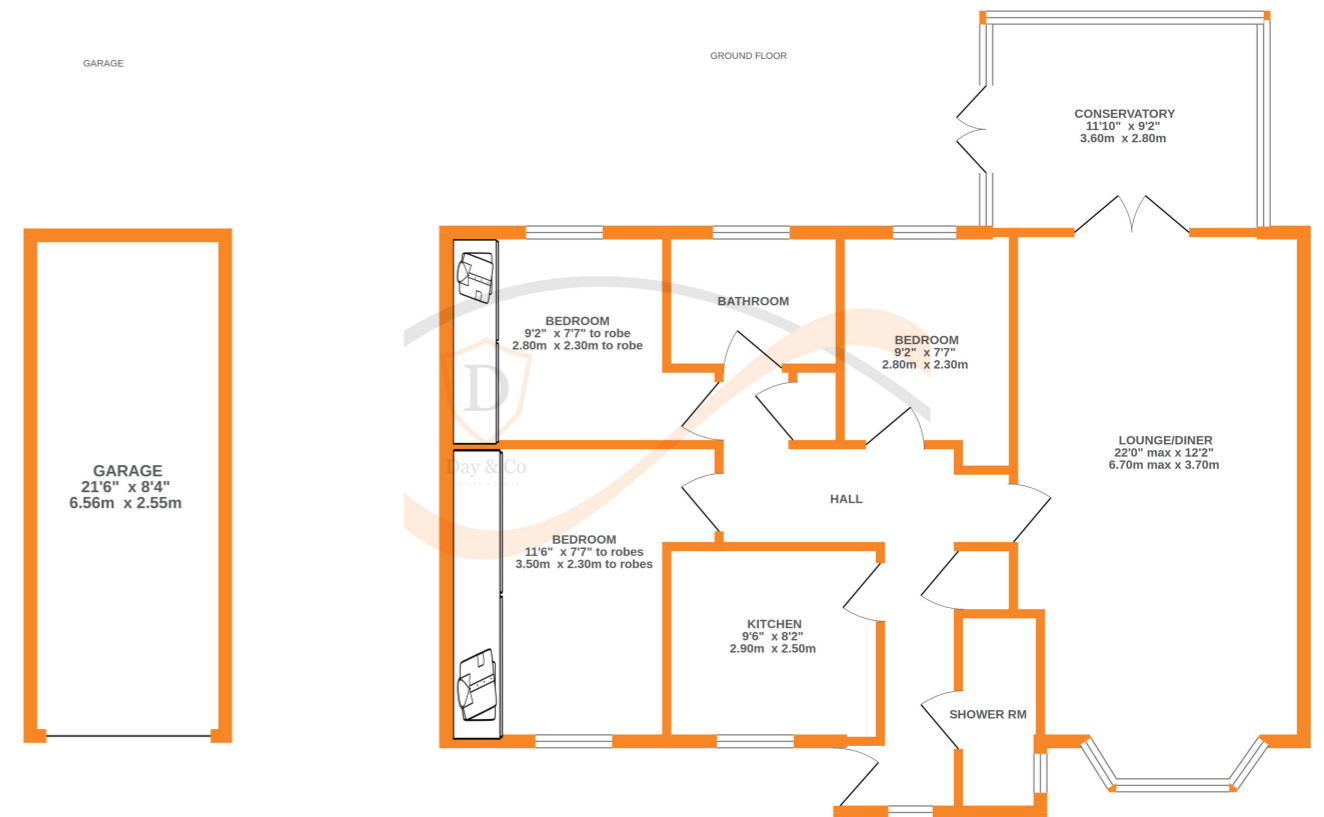

Whilst every attempt has been made to ensure the accuracy of the floorplan contained here, measurements of doors, windows, rooms and any other items are approximate and no responsibility is taken for any error, omission or mis-statement. This plan is for illustrative purposes only and should be used as such by any prospective purchaser. The services, systems and appliances shown have not been tested and no guarantee as to their operability or efficiency can be given.  
Made with Metropix ©2024