

FOR SALE

£375,000 Leasehold



Union House, Bunton Street. SE18

Oval Branch
36, Brixton Road, London, SW9 6BU

02078207950
info@davisandgibbs.com

ABOUT THE PROPERTY

Fantastic modern apartment situated on the second floor of a beautifully designed development. The property is comprised of a spacious open plan living area leading on to the private balcony, fitted kitchen with built in oven, hob and integrated appliances all finished to a high standard. With two double bedrooms, both with built in wardrobes with plenty of storage and large windows. The master bedroom also benefits from an en-suite shower room and there is also a second bathroom located off of the hallway. This apartment has a abundance of natural light.

EPC - C

Council Tax - Greenwich Band C

This bright and airy apartment is located in the heart of Woolwich Town Centre offering a wide range of supermarkets and shops as well as popular bars, restaurants, gyms and everyday amenities. For the busy commuter, you are spoilt with the fantastic transport facilities of Woolwich Arsenal, which has links into London Bridge and Charing Cross. As well as the Elizabeth Line and DLR that gets you into Canary wharf, Liverpool Street and Bond Street.

FEATURES

- Two Double Bedrooms
- Spacious Open Plan Layout
- Fitted Kitchen
- En Suite Bathroom
- Second Floor
- Great Transport Links
- Amazing Balcony
- Ideal Rental Investment



ROOM DESCRIPTIONS

Reception Room / Kitchen - 5.84m x 4.22m (19' 2" x 13' 10")

Spacious open plan lounge and kitchen with more than enough space to relax, cook and entertain.

Private Balcony

Over looking the centre of the development. A great place to enjoy a coffee in the sunshine.

Bedroom 1 - 3.56m x 3.25m (11' 8" x 10' 8")

The master bedroom features floor to ceiling windows a large built-in wardrobe and access to the en-suite bathroom.

Bedroom 2 - 3.71m x 2.59m (12' 2" x 8' 6")

A great size double bedroom featuring built-in storage, carpeted and a large floor to ceiling window.

Bathroom

The master bathroom has floor to ceiling tiles, bath with shower, heated towel rail and under counter storage units.

En-suite

The en-suite shower room has floor to ceiling tiles, large wall mounted mirror and under counter units.



FLOORPLAN

Union House, Bunton Street, London, SE18

Approximate Area = 670 sq ft / 62.2 sq m

For identification only - Not to scale

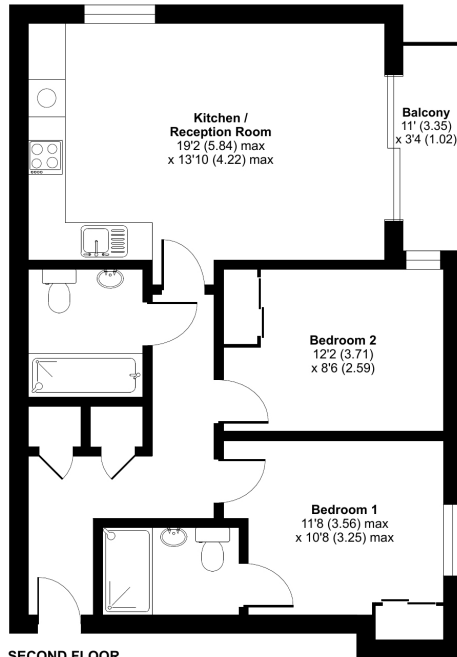

Floor plan produced in accordance with RICS Property Measurement Standards incorporating International Property Measurement Standards (IPMS2 Residential). © richrecom 2024. Produced for Davis & Gibbs. REF: 1074841

EPC

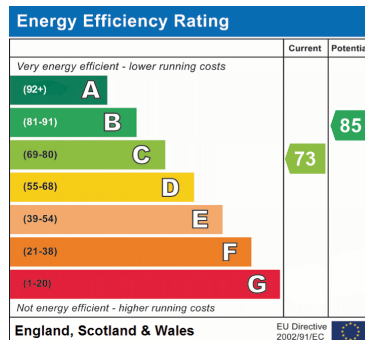

Davis & Gibbs

Oval Branch
02078207950

info@davisandgibbs.com

36, Brixton Road, London, SW9 6BU