

# FOR SALE

---

Lamington Street,  
Hammersmith, W6

---

End of Terrace House  
Brackenbury Village

---

£1,500,000 fh

---

5  2  3 



**horton  
andgarton**

SALES / LETTINGS / PROPERTY MANAGEMENT

hortonandgarton.co.uk | Sales 020 8819 0510 | Lettings 020 8819 0511  
172 King Street, Hammersmith, W6 0QU



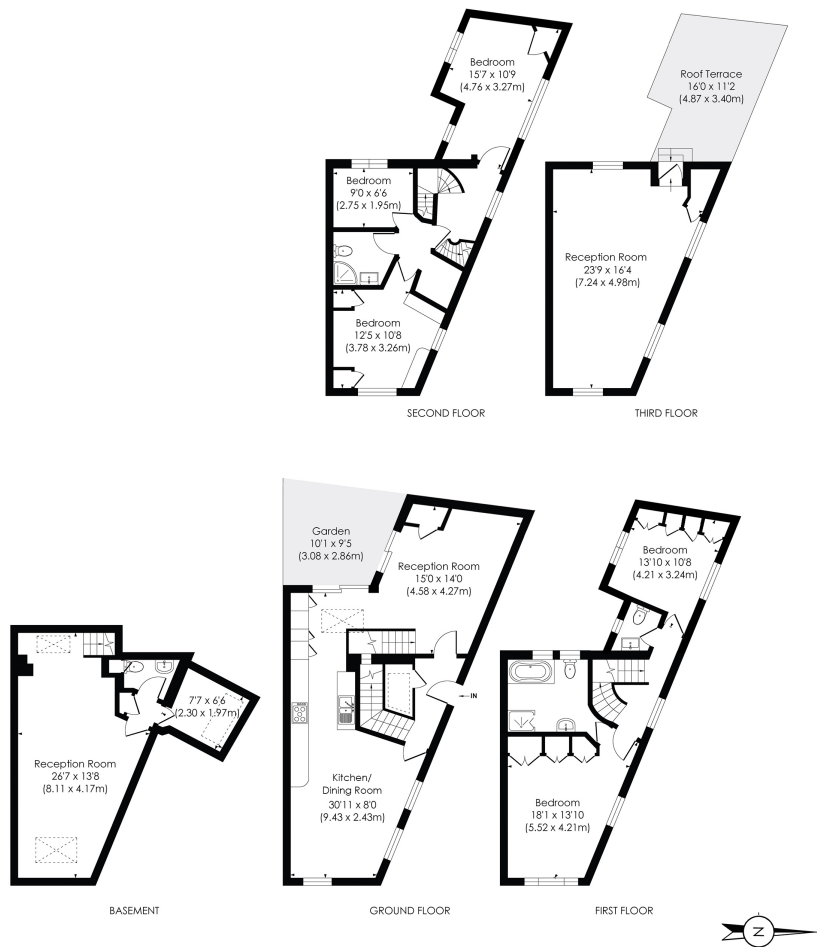

**LAMINGTON STREET, W6**

Approx. Gross Internal Floor Area

**2174 Sq' / 202.01 SqM**



© Pixangle Property Marketing Ltd. info@pixangle.com Tel: 0208 870 2118

This floor plan has been prepared for the purpose of illustration only in accordance with the latest RICS code of measuring practice and is not to scale. All measurements and areas are approximate and whilst every effort has been made to ensure the accuracy of the plan contained here, no responsibility is taken for any error, omission or misstatement.



Victorian family house | Three reception rooms | 2174 Sq' – 202.01 SqM | EPC rating D | Five bedrooms - Two bathrooms (one en-suite) | Brackenbury Village



hortonandgarton.co.uk

Sales 020 8819 0510

Lettings 020 8819 0511

172 King Street, Hammersmith, W6 0QU