



Day & Co  
ESTATE AGENTS

28 Cavendish Street  
Keighley  
BD21 3RG



21 Lime Street, Haworth,  
Keighley, West Yorkshire, BD22  
8BL

£164,995

T: 01535 664609

W: [www.dayandcoestateagents.co.uk](http://www.dayandcoestateagents.co.uk)

E: [keighley@dayandcoestateagents.co.uk](mailto:keighley@dayandcoestateagents.co.uk)



- Awaiting EPC
  - Two Double Bedrooms
  - Gas Central Heating & Double Glazing
  - Sought After Haworth Village/Excellent Access To Famous Cobbles
- Deceptively Spacious Through Terrace
  - Accommodation Over Three Floors
  - Pleasant Enclosed Private Garden

SUMMARY

**\*\*A DECEPTIVELY SPACIOUS 2 DOUBLE BEDROOM THROUGH TERRACE, SOUGHT AFTER HISTORIC VILLAGE LOCATION OF HAWORTH WITH EXCELLENT ACCESS TO THE FAMOUS COBBLED MAIN STREET!!\*\*** Having gas central heating, double glazing, accommodation over 3 floors, pleasant enclosed private garden - **VIEWING ESSENTIAL TO FULLY APPRECIATE!!** Awaiting EPC.

FULL DESCRIPTION

Of interest to a variety of buyers is this deceptively spacious two double bedroom through terrace situated in the sought after historic village of Haworth with excellent access to the famous cobbled Main Street and amenities including the Bronte Parsonage Museum and the Keighley and Worth Valley Steam Railway. Numerous countryside walks around the Bronte countryside are within easy access. The three storey accommodation comprises of an entrance porch, the lounge has an open fire, double glazed window to the front and a radiator. The kitchen has a range of base and wall mounted units, double glazed window and door to the rear. To the first floor there is a double bedroom with built in wardrobes, double glazed window to the front. The bathroom has a bath with shower over, WC, wash hand basin, double glazed window to the rear. To the second floor there is a spacious attic bedroom with two double glazed Velux windows, double glazed window to the side, radiator. Externally there is a pleasant enclosed private garden to the front, rear outbuilding for storage. Viewing essential to fully appreciate, awaiting EPC.

GROUND FLOOR

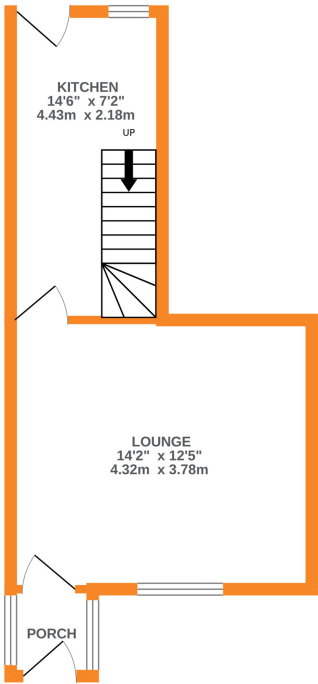

1ST FLOOR

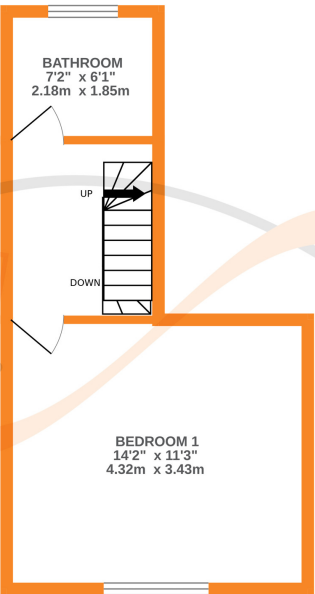

2ND FLOOR

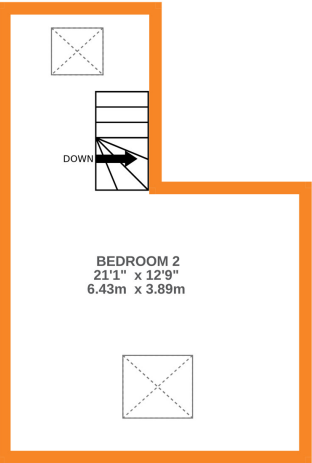

Whilst every attempt has been made to ensure the accuracy of the floorplan contained here, measurements of doors, windows, rooms and any other items are approximate and no responsibility is taken for any error, omission or mis-statement. This plan is for illustrative purposes only and should be used as such by any prospective purchaser. The services, systems and appliances shown have not been tested and no guarantee as to their operability or efficiency can be given.  
Made with Metropix ©2025