

TO LET

£875 pcm



Weavers House, Mannheim Quay, Maritime Quarter, Swansea, West Glamorgan SA1

- Elevated Ground Floor Position
- South-facing Marina Views
- Well Presented One Bedroom Apartment
- Allocated Parking



Bay Estate Agents Ltd
29, Camona Drive, Maritime Quarter, Swansea, SA1 1YJ

01792 645566
mail@bayestateagents.com



PROPERTY DESCRIPTION

Available March 2025

Bay is delighted to offer for rental, this well-presented elevated ground floor, one bedroom apartment with South-facing views over the Marina basin and boat moorings. The property briefly comprises a hallway leading to a separate kitchen in a contemporary design, living room with double doors opening onto a Juliet balcony overlooking the Marina, double bedroom with fitted wardrobe and stylish bathroom. Electric heating. Allocated underground parking. Good access to the City Centre, supermarket, Swansea Arena, and local amenities. Property is available furnished and on a Tenant Find basis.

Deposit: £1,312.50 (£1750 for student rental) Term: 12 months (+) Council Tax: Band D EPC: D Requested Holding £201.
Viewing is highly recommend



ROOM DESCRIPTIONS



FLOORPLAN & EPC



GROUND FLOOR

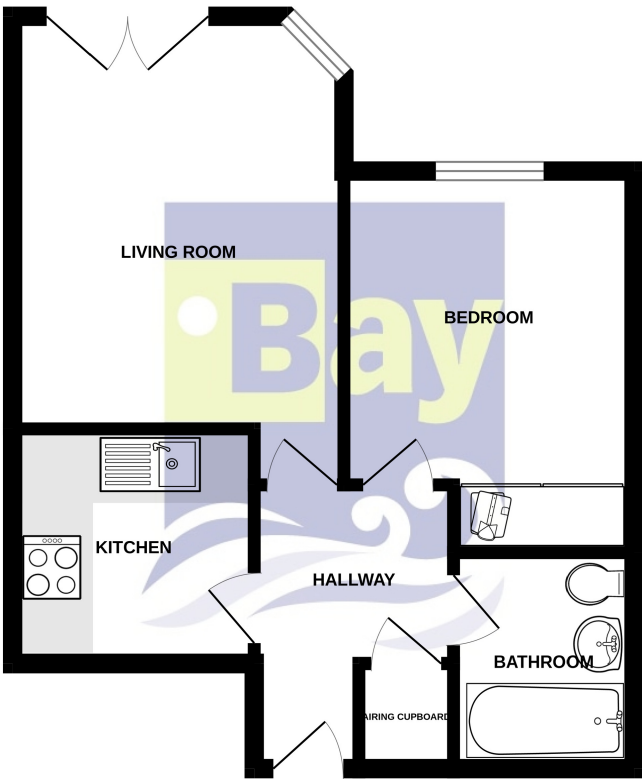

Whilst every attempt has been made to ensure the accuracy of the floorplan contained here, measurements of doors, windows, rooms and any other items are approximate and no responsibility is taken for any error, omission or mis-statement. This plan is for illustrative purposes only and should be used as such by any prospective purchaser. The services, systems and appliances shown have not been tested and no guarantee as to their operability or efficiency can be given.
Made with Metropix ©2023

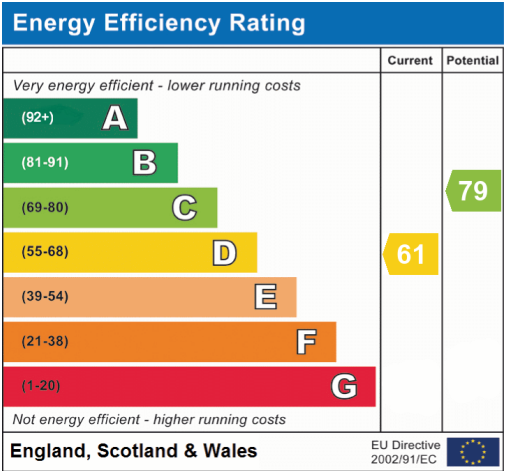

Bay Estates & Lettings Agents

29, Camona Drive, Maritime Quarter, Swansea, SA1 1YJ
01792 645566
mail@bayestateagents.com