



Day & Co  
ESTATE AGENTS

28 Cavendish Street  
Keighley  
BD21 3RG



46 Berrington Way, Oakworth,  
Keighley, West Yorkshire, BD22  
7SQ

£320,000

T: 01535 664609

W: [www.dayandcoestateagents.co.uk](http://www.dayandcoestateagents.co.uk)

E: [keighley@dayandcoestateagents.co.uk](mailto:keighley@dayandcoestateagents.co.uk)

- EPC Rating Is B
- Four Bedrooms & Master En Suite
- Generous Size Rear Garden
- Popular Village Of Oakworth/Excellent Access To The Local Primary School

- Spacious Detached Family Home
- Two Reception Rooms
- Drive & Integral Garage

## SUMMARY

**\*\*A SPACIOUS 4 BEDROOM (MASTER EN-SUITE) DETACHED FAMILY HOME, POPULAR 'TAYWOOD' DEVELOPMENT IN OAKWORTH VILLAGE - EXCELLENT ACCESS TO THE PRIMARY SCHOOL!!\*\*** Having 2 reception rooms, generous size rear garden, drive, integral garage - VIEWING ESSENTIAL TO FULLY APPRECIATE!! EPC rating Is B.

## FULL DESCRIPTION

An ideal purchase for the growing family is this spacious four bedroom (master en-suite) detached family home situated on the ever popular 'Taywood' development in Oakworth village with excellent access to the primary school. The well proportioned accommodation comprises of an entrance hall giving access to the integral garage and under stairs cloaks WC. The lounge has a living flame gas coal effect fire, double glazed window, radiator, double doors open into the dining room which in turn has double glazed sliding doors leading to the rear garden. The dining kitchen has a range of base and wall mounted units, integrated oven, hob and extractor fan, double glazed window to the rear. There is a separate utility room with plumbing for an automatic washing machine and door giving access to the side of the property. To the first floor there are four good size bedrooms, the master having fitted wardrobes and an en-suite shower room. The house bathroom has a bath with shower over, WC, wash hand basin. Externally there is a drive to the front leading to the integral garage, to the rear is a generous size well established enclosed garden

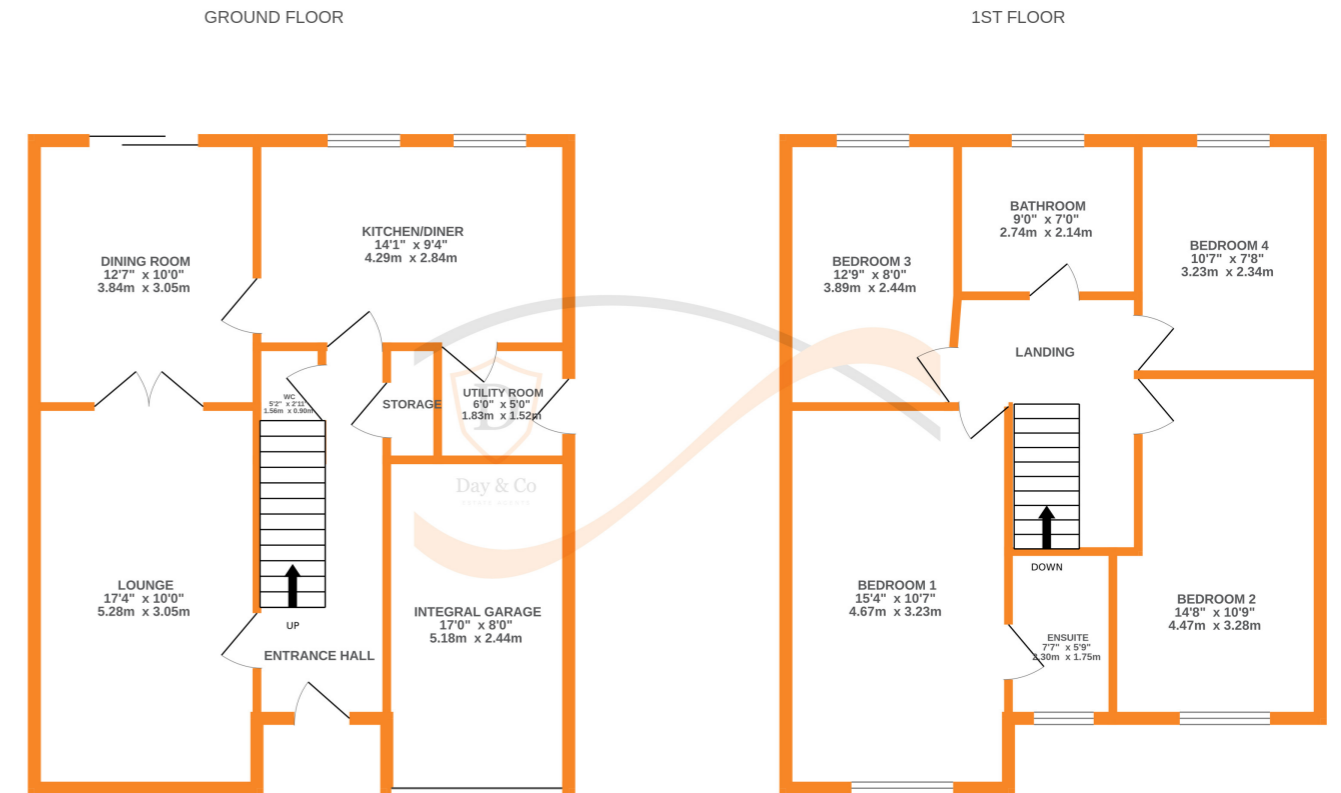

Whilst every attempt has been made to ensure the accuracy of the floorplan contained here, measurements of doors, windows, rooms and any other items are approximate and no responsibility is taken for any error, omission or mis-statement. This plan is for illustrative purposes only and should be used as such by any prospective purchaser. The services, systems and appliances shown have not been tested and no guarantee as to their operability or efficiency can be given.  
Made with Metropix 62024