



27 MIDDLE GREEVE  
WOOTTON | NORTHAMPTON  
£495,000 FREEHOLD



-  sales
-  lettings
-  town & country



## 27 Middle Greeve | Wootton | Northampton | NN4 6BB

Merrys are delighted to offer for sale this well presented and positioned four bedroom detached house located in a sought after area of Wootton Fields. Set back in the cul-de-sac and off the road this family home enjoys a nice plot with private rear garden and has accommodation over two floors to include a lounge, kitchen/breakfast room, dining room, conservatory, utility room, study and cloakroom WC on the ground floor and four bedrooms with en-suite shower room to master and family bathroom on the first floor.

The ground floor is well laid out with the addition of two built in double storage cupboards in the entrance hall and further storage under the stairs, with a refurbished kitchen complete with built in appliances and a separate utility room. The conservatory is a nice place to sit and enjoy the southerly facing rear garden. There is also a separate study ideal for home workers. Externally there is parking for 2-3 cars leading up to the double garage and the gated rear garden access, with generous side garden. The rear garden is south facing and feels private and has been mainly laid to lawn.

Location is ideal close to local good schooling and M1 / A45/A428 and A43 road links whilst enjoying short distances to nice walking routes such as Nettle Gap Spinney and Brackmills country Park.

Four bedroom detached with double garage | Sought after cul-de-sac location in Wootton Fields | Refitted Kitchen with appliances |

Built in Storage | Private south facing rear garden | Close to local schools and amenities



-  sales
-  lettings
-  town & country

Wootton Hope Drive, Northampton, NN4 6DY  
MERRYS.CO.UK















GROUND FLOOR  
1017 sq.ft. (94.5 sq.m.) approx.

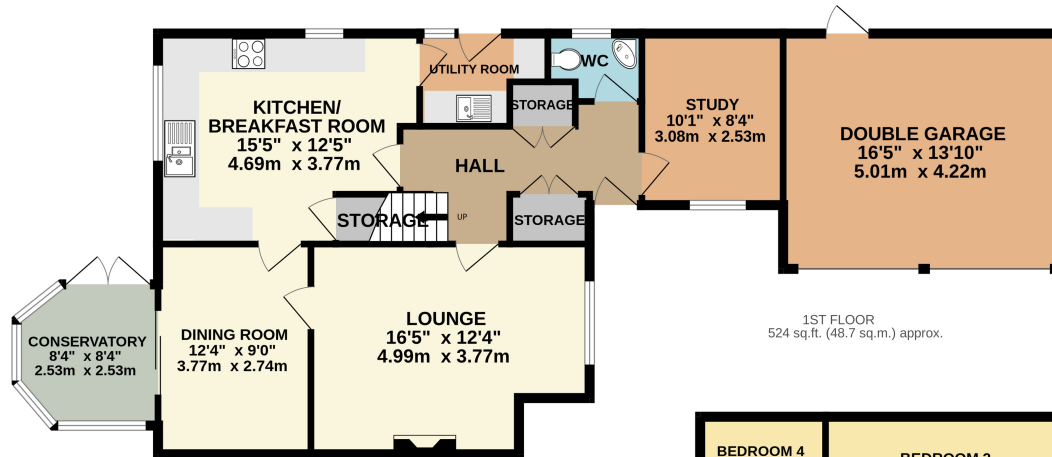

1ST FLOOR  
524 sq.ft. (48.7 sq.m.) approx.

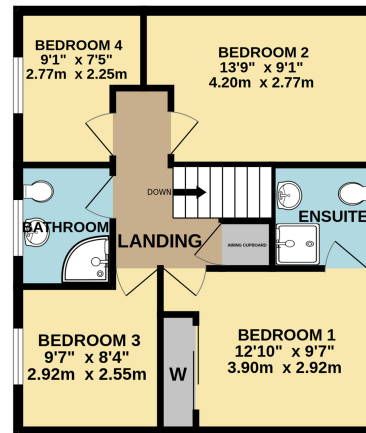

TOTAL FLOOR AREA : 1541 sq.ft. (143.2 sq.m.) approx.

Whilst every attempt has been made to ensure the accuracy of the floorplan contained here, measurements of doors, windows, rooms and any other items are approximate and no responsibility is taken for any error, omission or mis-statement. This plan is for illustrative purposes only and should be used as such by any prospective purchaser. The services, systems and appliances shown have not been tested and no guarantee as to their operability or efficiency can be given.  
Made with Metropix ©2025

Note: Merrys for themselves and for the vendors of this property, whose agents they are, give notice that:

1. The particulars are intended to give a fair and substantially correct overall description for the guidance of intending purchasers and do not constitute, nor constitute part of an offer or contract. No responsibility is assumed for the accuracy of individual items.
2. All descriptions, dimensions, area, reference to condition and necessary permission for use and occupation and their details are given in good faith and are believed to be correct, but any intending purchasers should not rely on them as statements or representations of fact, but must satisfy themselves by inspection, or otherwise as to the correctness of each of them.
3. No person in the employment of Merrys has any authority to make or give and representations or warranty whatever in relation to this property or these particulars or enter into any contract relating to this property on behalf of the vendor.
4. No responsibility can be accepted for any expenses incurred by intending purchasers or in inspecting properties which have been sold, let or withdrawn.