

Guide Price
£235,000



SOLD
Subject To Contact



Chilton Park, Bridgwater, TA6 3JW
2 Bedrooms, Park Home

- Omar Sandringham 40' x 20' - 2021
- Two Double Bedrooms
- Immaculately Presented Throughout
- L-Shape Open Plan Lounge/Dining
- Fully Equipped Kitchen

- Bedroom One with En-Suite
- Bedroom Two with Walk-In Wardrobe
- Garage & Driveway Parking
- Close to Town Amenities
- Located on a Sought After, Well Presented Site

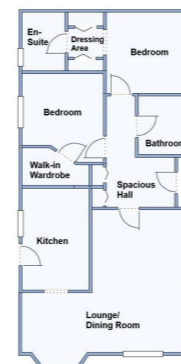

This property is exempt from an EPC

Council Tax Band: A
£1,511.00 for 2024/25

Material Information

Utilities Services:
Mains Water, Gas, Electricity & Drainage are Connected

Flood Risk:
<https://flood-map-for-planning.service.gov.uk/>

Broadband & Mobile Signal:
For an indication of specific speeds and supply or coverage in the area, we recommend potential Buyers use:-
<https://checker.ofcom.org.uk/en-gb/mobile-coverage>
<https://checker.ofcom.org.uk/en-gb/broadband-coverage>

Planning Applications:
https://sdc.somerset.gov.uk/planning_online

Em: residential@aandfproperty.co.uk

Office: 18 College Street, Burnham-on-Sea, TA8 1AE

Tel: 01278 782266