



121 Verona Apartments, 50 Wellington Street, SLOUGH, Berkshire. SL1 1YL.

£280,000

t: 01753 593888

w: www.flatmans.com

e: langleysales@flatmans.com

Features of Interest

- 995 YEAR LEASE
- IMPRESSIVE MODERN APARTMENT
- WALKING DISTANCE TO SLOUGH HIGH STREET WHICH IS SOON TO BE REDEVELOPED
- WALKING DISTANCE TO SLOUGH MAINLINE CROSSRAIL TRAIN STATION
- TWO DOUBLE BEDROOMS
- TWO BATHROOMS
- EASY ACCESS TO THE M4 & M25 MOTORWAYS
- ON SITE GYMNASIUM
- ALLOCATED PARKING
- CONCIERGE SERVICE

Description

An impressive modern two bedroom apartment located in the heart of Slough Town centre which is soon to be redeveloped and within a few minute's walk to Slough Mainline Train Station (Crossrail Station) and all other local amenities. The property benefits from an open plan living area with a fully fitted kitchen, master bedroom with en-suite shower and built-in wardrobes, a further double bedroom also with built-in wardrobes and stunning family bathroom. The property also has allocated parking, elevator access, on-site gymnasium, Concierge service and a 995 YEAR LEASE. Call us now to arrange an appointment.

GROUND FLOOR

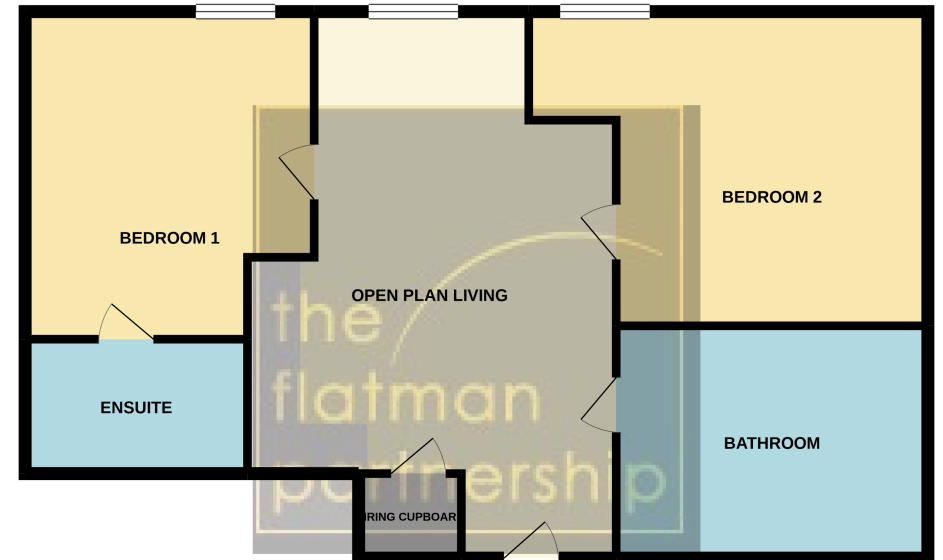

Whilst every attempt has been made to ensure the accuracy of the floorplan contained here, measurements of doors, windows, rooms and any other items are approximate and no responsibility is taken for any error, omission or mis-statement. This plan is for illustrative purposes only and should be used as such by any prospective purchaser. The services, systems and appliances shown have not been tested and no guarantee as to their operability or efficiency can be given.
Made with Metropix ©2020