

FOR SALE

£660,000 Freehold



Hertford Road, Stevenage, Hertfordshire. SG2 8SA

- DETACHED
- THREE BEDROOMS
- GARAGE
- DRIVE WAY
- CONSERVATORY
- HERTFORD ROAD
- TWO BATHROOMS
- LARGE ENTERTAINING KITCHEN/BREAKFAST ROOM



PROPERTY DESCRIPTION

A rarely available three bedroom detached family home is located on the popular Hertford Road in Stevenage.

On the ground floor you are welcomed into an entrance hallway, which provides access to the integral bedroom three, shower room, kitchen and the lounge. The kitchen opens to; a conservatory with French doors to the garden. Upstairs there are two well maintained bedrooms which are both double bedrooms with built in storage. There is a modern family three piece bathroom.

The large rear garden has access from the side and benefits from access into the garage.

Hertford Road is close to the following amenities:

MARYMEAD MEDICAL PRACTICE 0.2 Miles

CO-OP 0.2 Miles

ROEBUCK DOCTORS 0.4 Miles

SHEPHALBURY PARK SCHOOL 0.4 Miles

LONGMEADOW PRIMARY SCHOOL 0.4 Miles

TESCO SUPERSTORE 0.6 Miles

ROEBUCK PRIMARY SCHOOL 0.7 Miles

Barnwell Secondary 0.7 Miles

Knebworth train station 0.9 Miles

Knebworth Doctors surgery 1.0 Miles



ROOM DESCRIPTIONS

ENTRANCE HALL

1.566m x 4.842m (5' 2" x 15' 11")

LIVING ROOM

3.545m x 5.956m (11' 8" x 19' 6")

BEDROOM THREE

2.380m x 4.555m (7' 10" x 14' 11")

KITCHEN

7.226m x 3.510m (23' 8" x 11' 6")

CONSERVATORY

3.858m x 3.918m (12' 8" x 12' 10")

BATHROOM

1.570m x 2.407m (5' 2" x 7' 11")

FIRST FLOOR

MASTER BEDROOM

4.952m x 3.816m (16' 3" x 12' 6")

BEDROOM TWO

3.852m x 2.735m (12' 8" x 9' 0")

BATHROOM

2.807m x 2.075m (9' 3" x 6' 10")

GARAGE



FLOORPLAN & EPC

KALM
-ESTATE AGENTS-

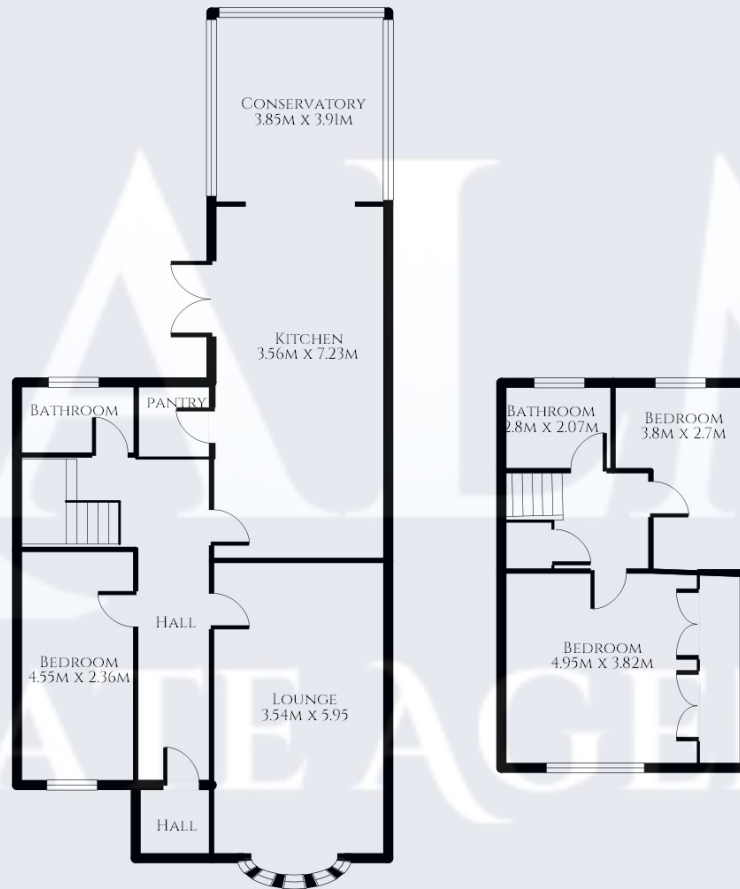

Energy Efficiency Rating		
	Current	Potential
Very energy efficient - lower running costs		
(92+) A		
(81-91) B		
(69-80) C		
(55-68) D		67
(39-54) E	42	
(21-38) F		
(1-20) G		
Not energy efficient - higher running costs		
England, Scotland & Wales		
	EU Directive 2002/91/EC	

Stevenage
29, Shephall Green, Stevenage, SG2 9XS
01438 572020
linzi.davis@kalmestateagents.co.uk