

Truuli



Harcourt Road, Thornton Heath, Surrey, CR7 6BU

£450,000 Freehold

- Lovely well maintained private garden
- No onward
- Upstairs shower room with W/C
- Versatile living layout
- Sought after location
- Well proportioned bedrooms

Southbridge Place, Croydon, Surrey, CR0 4HA

Tel: 0330 043 0002

Email: save@truuli.co.uk Web: www.truuli.co.uk

Harcourt Road, Thornton Heath, Surrey, CR7 6BU

£450,000 Freehold

This charming 1930s terraced family home is ideally situated on a popular and well-regarded residential road, offering a wonderful balance of character, space and practicality.

Offered to the market with the added advantage of no onward chain, this appealing home presents an excellent opportunity for buyers seeking a well-located property with period charm, versatile living space and scope to personalise in a highly desirable neighbourhood.

Harcourt Road

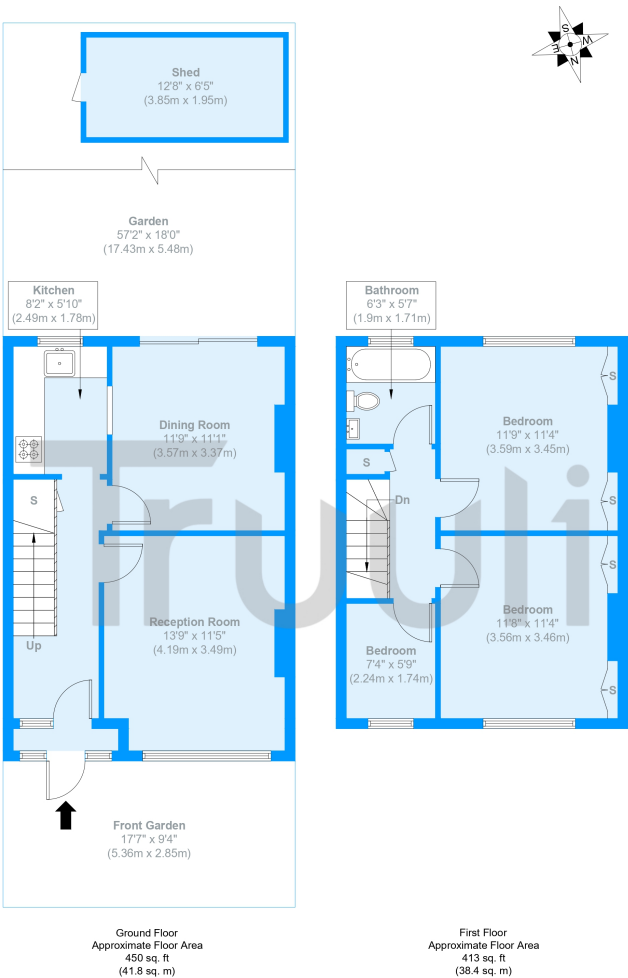

Approximate Gross Internal Area = 80.2 sq m / 863 sq ft

The Floor plan is not to scale and measurements and areas shown are approximate and therefore should be used for illustrative purposes only. The plan has been prepared in accordance with the RICS code of Measuring Practice and whilst we have confidence in the information produced it must not be relied on. Maximum lengths and widths are represented on the floor plan. If there is any aspect of particular importance, you should carry out or commission your own inspection of the property.
Copyright © BleuPlan

