



Laburnum Close,  
Kidsgrove, Stoke-on-  
Trent



**OneAgency**

01782 970222

[hello@oneagencygroup.co.uk](mailto:hello@oneagencygroup.co.uk)





# Offers in Region of £180,000

Semi detached house, situated in a popular residential location, conveniently located for both Bathpool Park & Clough Hall Park. The property benefits from ample off road parking, attractive gardens and no chain involvement. Viewing is recommended.





## GROUND FLOOR

### ENTRANCE LOBBY

Door to front.

### LIVING/DINING ROOM

7.69m max x 3.65m max (25' 3" x 12' 0")  
Double glazed window to front, double glazed french doors and windows to rear, radiator x 2, gas fire.

### INNER HALL

Radiator, under stairs storage, double glazed frosted window to side.

### SHOWER ROOM

Shower cubicle with electric shower, hand wash basin, WC, heated towel rail, tiled walls.

### KITCHEN

3.30m x 2.39m (10' 10" x 7' 10") Double glazed window to rear, door to side, fitted with a range of wall, base and drawer storage units, sink and drainer unit with mixer tap, tiled walls, radiator, fitted oven and hob with extractor fan above, radiator.

## FIRST FLOOR

### BEDROOM ONE

3.66m x 3.32m (12' 0" x 10' 11") Double glazed window to front, radiator.

### BEDROOM TWO

3.02m x 3.06m (9' 11" x 10' 0") Double glazed window to rear, radiator.

### BEDROOM THREE

1.59m limited head room x 2.71m (5' 3" x 8' 11") Double glazed window to side, radiator.

### BATHROOM

1.69m x 2.38m max (5' 7" x 7' 10") Bathroom suite comprising of hand wash basin, panelled bath with electric shower over, WC, heated towel rail, tiled walls, double glazed frosted window to side.

### INTEGRAL STORE (FORMER GARAGE)

3.40m x 2.61m (11' 2" x 8' 7") Wall mounted boiler, power and lighting, up and over door.

### OUTSIDE

Ample off road parking to the front with access to store (former garage area). Attractive gardens to front and rear.

### AGENTS NOTES

We understand that a probate application has been submitted but the grant of probate has not yet been granted.





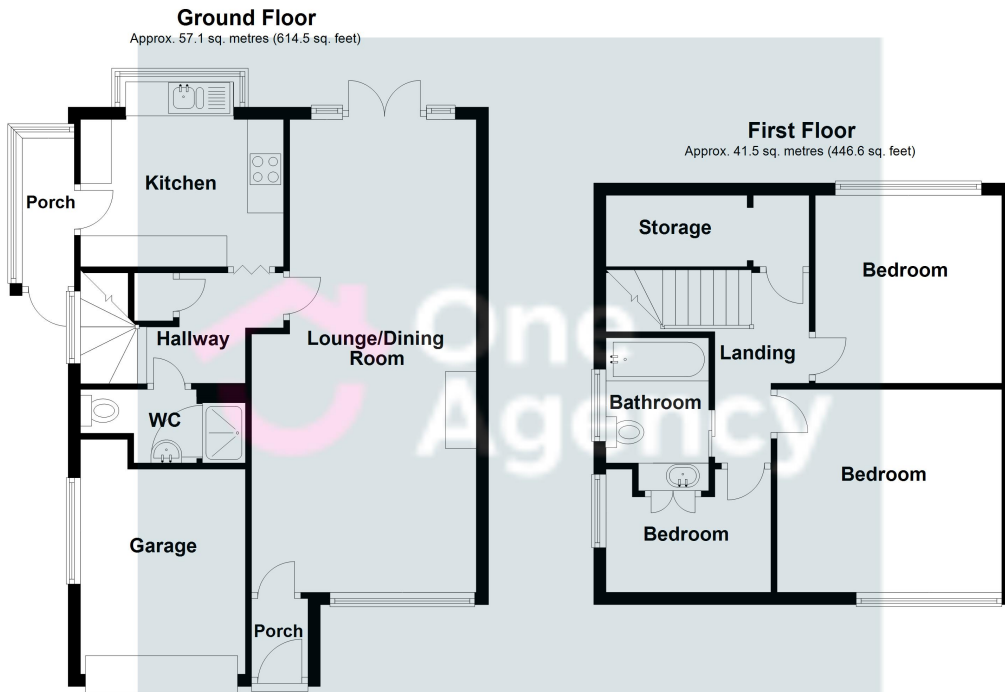

Total area: approx. 98.6 sq. metres (1061.1 sq. feet)

We accept no responsibility for any mistake or inaccuracy contained within the floorplan. The floorplan is provided as a guide only and should be taken as an illustration only. The measurements, contents and positioning are approximations only and provided as a guidance tool and not an exact replication of the property.  
Plan produced using PlanUp.

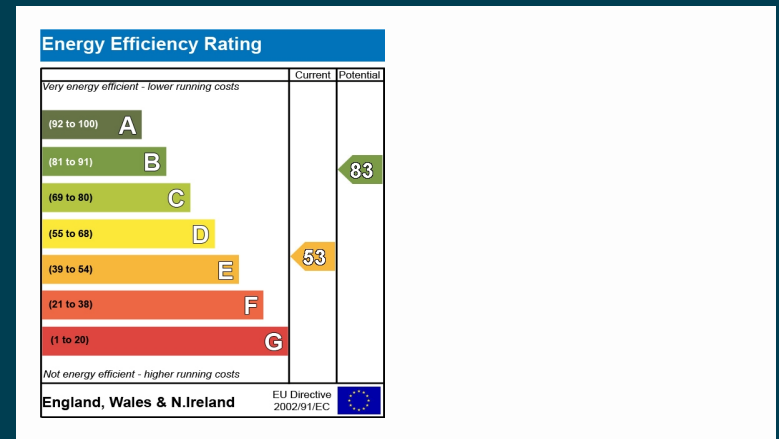

OneAgency, 9 & 10 Ridge House Drive, Festival Park, Stoke-on-Trent, ST1 5SJ

01782 970222

hello@oneagencygroup.co.uk

Every attempt has been made to ensure accuracy, however, all measurements are approximate and for illustrative purposes only. **Not to scale.**

In accordance with The Consumer Protection from Unfair Trading Regulations 2008 the following particulars have been prepared in good faith and they are not intended to constitute part of an offer or contract. We have not carried out a structural survey and the services, appliances and specific fittings have not been tested. All photographs, measurements, floor plans and distances referred to are given as a guide only and should not be relied upon for the purchase of carpets or any other fixtures and fittings. Lease details, service charges and ground rent (where applicable) are given as a guide only and should be checked and confirmed by your Solicitor prior to exchange of contracts.