

FOR
SALE



74 River View, Hereford HR2 6EA

£230,000 - Freehold

22, Broad Street, Hereford, HR4 9AP 01432 355455 hereford@flintandcook.co.uk

PROPERTY SUMMARY

A well presented three bedroom semi-detached house in a quiet cul-de-sac position in the Putson area of Hereford. Offering ideal family accommodation, the property has the added benefit of off road parking, garage, south-west facing rear garden, two reception rooms and gas central heating.

POINTS OF INTEREST

- *Well presented semi-detached house*
- *Quiet cul-de-sac position*
- *Off-road parking*
- *3 Bedrooms*
- *South-west facing rear garden*
- *Garage*
- *Gas central heating*
- *Close to amenities*



ROOM DESCRIPTIONS

Glazed Entrance Porch

with partially glazed entrance door, laminate flooring with fully glazed sliding doors to

Entrance Hall

with fitted carpet, good size storage cupboard with double doors, radiator and door to

Living Room

with feature log effect fireplace with hearth and surround, laminate flooring, radiator, double glazed window to rear aspect and partially glazed rear access door. Door to

Open plan Kitchen/Dining Room

with tiled flooring, double glazed windows to side and rear aspect, radiator, tiled work surfaces, fitted wall and base units, sink and drainer unit, space for fridge freezer, space for cooker, space and plumbing for washing machine, in-built storage cupboard with shelving, external side access door and door to entrance hall. A staircase from the entrance hall leads to the

First Floor Landing

with fitted carpet, double glazed window to the front aspect, access hatch to loft space, door to

Bedroom 1

with fitted carpet, radiator, double glazed window to the rear aspect

Bedroom 2

with feature exposed floorboards, radiator, double glazed window to the front aspect

Bedroom 3

with feature exposed floorboards, radiator, double glazed window to the rear aspect

Separate WC

with double glazed window to side, low flush WC

Bathroom

with tiled flooring, partially tiled walls, double glazed window to side, pedestal wash hand basin, panelled bath with wall mounted electric shower and glass shower screen

Outside

To the front there is a concrete drive providing off road parking facilities for at least two vehicles with a front garden laid to lawn and enclosed by fencing and wall to the front. The drive continues up the side of the property where there is an externally accessed under stairs store cupboard containing the gas fired central heating combination boiler. There is side access to the rear garden with patio area with steps down to large rear law which is south-west facing providing an ideal sun trap. Garage with up and over door, personal door to the side with windows and power and lighting, with further storage to rear with window. Useful outside lights and outside tap.

Services

Mains water, electricity, drainage and gas are connected. Telephone (subject to transfer regulations). Gas-fired central heating.

Outgoings

Council tax band C - payable 2024/25 £2050.97
Water and drainage - rates are payable.

Money laundering regulations

Prospective purchasers will be asked to produce identification, address verification and proof of funds at the time of making an offer.

Viewings

Strictly by appointment through the Agent, Flint & Cook, Hereford.

Directions

From Hereford City centre proceed southwards along the A49 to the ASDA roundabout taking the first exit (A49) and immediately turn left onto Hinton Road. Continue straight over the first mini roundabout, straight over the second mini roundabout and then immediately turn left onto Putson Avenue. Take the next left turn onto River View, turn left again and number 74 is last property on the left hand side as indicated by the Agent's for sale board.

what3words: ///tribes.dunes.train

Ground Floor

Approx. 45.6 sq. metres (491.0 sq. feet)

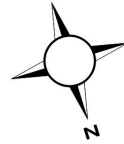
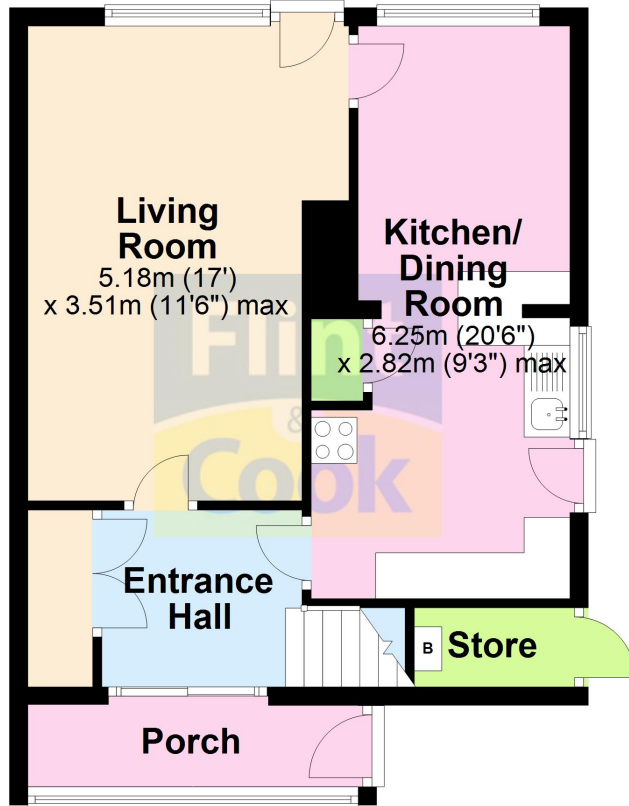

First Floor

Approx. 43.0 sq. metres (462.5 sq. feet)

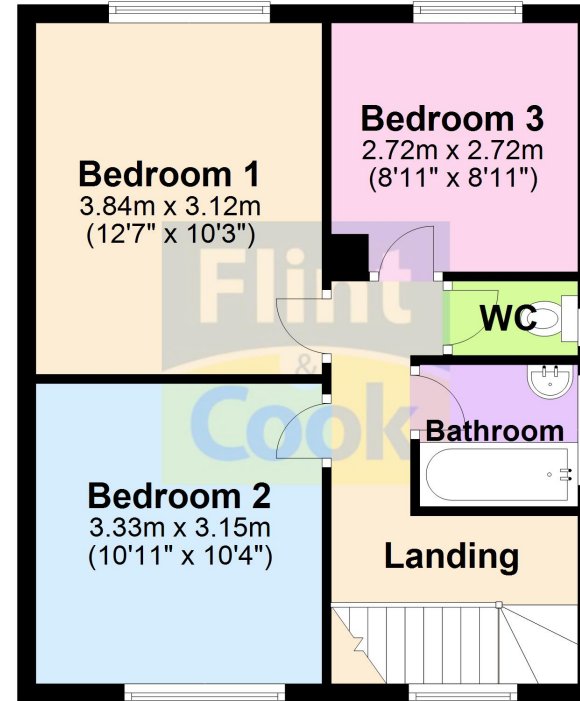

Total area: approx. 88.6 sq. metres (953.5 sq. feet)

This plan is for illustrative purposes only
Plan produced using PlanUp.

These particulars are prepared for the guidance only of prospective purchasers. They are intended to give a fair and overall description of the property and do not constitute the whole or any part of an offer or contract. Any information contained herein (whether in text, plans or photographs) is given in good faith but should not be relied upon as being a statement or representation of fact. Any plans provided by the agents and/or with the sales particulars are intended for guidance purposes only; we cannot guarantee the accuracy and scale of any plans, and they do not form any part of the sales contract. Nothing in these particulars shall be deemed to be a statement that the property is in good condition or otherwise nor that any services or facilities are in good working order. Any movable contents, fixtures and fittings, (whether wired or not) referred to in these property particulars (including any shown in the photographs) are, unless the particulars say otherwise, excluded from the sale. In the event that the buyer proposes to purchase any movable contents or include them in any offer for the property, the buyer cannot in any respect imply any such inclusion from the property particulars. Any areas, measurements or distances referred to herein are approximate only and may be subject to amendment. It should not be assumed that the property has all necessary planning, building regulation or other consents and these matters must be verified by an intending purchaser. The information in these particulars is given without responsibility on the part of the agents or their clients and neither the agents nor their employees have any authority to make or give any representations or warranties whatever in relation to this property.

Flint & Cook Privacy Statement: We take your privacy very seriously. Your data will not be shared with any other parties without your express permission. Our Data protection Policy can be read in full on the Flint & Cook website, www.flintandcook.co.uk

| Energy Efficiency Rating | | |
|---|----------|-----------|
| | Current | Potential |
| Very energy efficient - lower running costs | | |
| (92+) | A | |
| (81-91) | B | |
| (69-80) | C | |
| (55-68) | D | |
| (39-54) | E | |
| (21-38) | F | |
| (1-20) | G | |
| Not energy efficient - higher running costs | | |
| | 69 | 83 |
| England, Scotland & Wales | | |
| EU Directive 2002/91/EC | | |