



67/10, Henderson Street, Edinburgh, EH6 6ED

Light and Tastefully Presented, One-Bedroom, Third-Floor (Top) Flat

Up to date price and viewing info at mov8realestate.com/property

espc rightmove  **Zoopla**
find your happy

Property Description

Light and tastefully presented, one-bedroom, third-floor (top) flat forming part of a traditional stone-built tenement. Conveniently located in the fashionable Shore area of Leith, north-east of Edinburgh city centre.

Comprises an entrance hall, a living/dining room and kitchen, a double bedroom, and a shower room.

An ideal starter home or buy-to-let, featuring a fitted kitchen with appliances and a modern bathroom. In addition, there is gas central heating, double glazing, tall ceilings and period cornice work.

There is also a secure entry system, superb transport links, and zoned street parking on the surrounding streets.

The welcoming entrance hall provides access to all rooms within the property, creating a practical and well-laid-out living space. The spacious open-plan living area is thoughtfully designed to accommodate both lounge and dining furniture, featuring comfortable carpeted flooring, a central light fitting and a large window that floods the room with natural light, enhancing the bright and airy feel. This versatile space is ideal for both relaxing and entertaining. Open to the living area, the kitchen is neatly arranged and finished with stone-effect worktops, a tiled splashback surround and easy-maintenance flooring. The space is well equipped with integrated appliances including a fridge/freezer, oven and an electric hob with a canopy extractor above, along with a stainless-steel sink and drainer, providing both style and functionality.

The bedroom is generously proportioned and comfortably accommodates a double bed along with additional bedroom furniture. It benefits from soft carpeted flooring, a built-in wardrobe offering ample storage, and a pleasant, peaceful outlook, making it an ideal retreat at the end of the day. Completing the property is the modern fitted shower room, which features easy-maintenance flooring, a tiled splashback surround, contemporary spotlighting and a ladder-style radiator, creating a clean and functional finish throughout.

The Living Area has been virtually staged with our compliments.



67/10 Henderson Street, Edinburgh, EH6 6ED

Approximate Gross Internal Area: (431 sq ft - 40 sq m.)

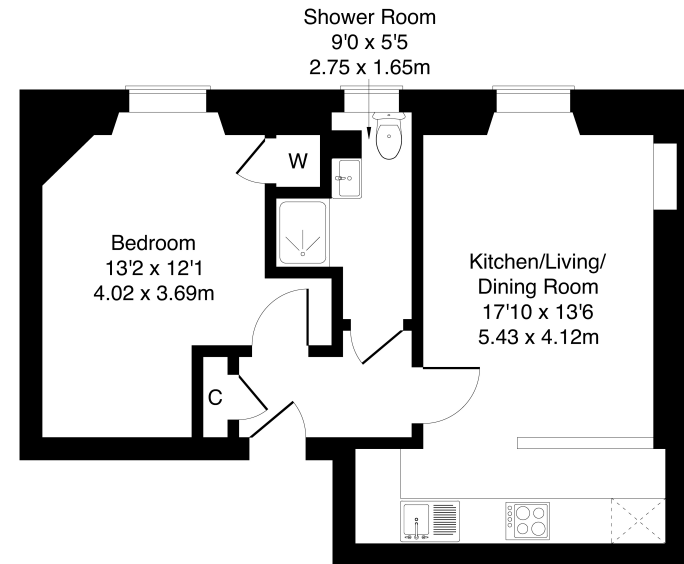

Third Floor

Legal Disclaimer : Floor-plan and measurements are for illustrative guidance only, and not intended to form part of any contract.

Area Description

The Shore is a fashionable and vibrant area located north of Edinburgh city centre, combining historic charm with modern developments. It is renowned for its exceptional selection of local artisan shops and eateries, including several Michelin-starred restaurants. Extensive shopping opportunities are found throughout Leith, with Great Junction Street and the foot of Leith Walk nearby, along with numerous supermarkets. The area hosts weekly markets that showcase local food stalls and

independent retailers. For broader retail and leisure options, the Ocean Terminal complex offers major high-street outlets, a multi-screen cinema, a gym, a spa, and a variety of restaurants. Scenic walks and cycle routes run along the Newhaven shore and the Water of Leith, while Leith Links park provides spacious green areas. Excellent transport connections include frequent services to the city centre and beyond, supported by the new tram extension reaching Newhaven.





Our Services

-  Free pre-sale property valuations
-  Great value fixed estate agency fees
-  Extensive buyer matching database
-  Purchase and sale conveyancing

Contact Us

0345 646 0208

sales@mov8realestate.com

www.mov8.com

Head Office

6 Redheughs Rigg, Edinburgh, EH12 9DQ

Glasgow Office

77 Renfrew Street, Glasgow, G2 3BZ



Estate Agents and Solicitors



These particulars do not form part of any contract and the statements or plans contained herein are not warranted nor are they to scale. All descriptions, dimensions, areas, reference to condition and necessary permissions for use and occupation and other details are given in good faith, and are believed to be correct, but any prospective purchaser should not rely on them as statements or representations of fact, and any prospective purchaser must satisfy themselves by inspection or otherwise as to the correctness of each of them. The Seller shall not be bound to accept the highest or any offer nor to accept a full offer of the Fixed Price where this is applicable. Approximate measurements have been taken by sonic device and measurements are most often taken to the widest point of any room or space. Services and appliances have not been tested for efficiency or safety and no warranty is given as to their compliance with any Regulations. Offers should be made using the Combined Standard Clauses.