



14 Alfred Road, Dartford, Kent, DA2 7SQ
£400,000 Freehold



Description

Guide Price £400,000 - £425,000

Offering no forward chain, this spacious two bedroom bungalow is located in ideal location. As you approach the home through the village you will appreciate the beautiful rural views as the home is surrounded by fields. The bungalow offers ample parking to the front and large detached garage to the side. The rooms are generous with a kitchen diner overlooking the garden.

We expecting a quick sale, so contact us now to arrange your viewing!

Perfectly located for easy access to Sutton at Hone village, Farningham and Eynsford villages, this has a rural feel to it with the property being surrounded by fields. It has excellent access to motorway networks and railway links, Farningham Road station 2.1 miles, Swanley 3.9 miles, Dartford 2.6 miles, Ebbsfleet International station 6.5 miles, (All distances are approximate). The M25 at Junction 3 offers access to Gatwick, Stansted and Heathrow. M20 provides convenient access to London and the Kent coast. The area boasts for its excellent range of schools including Dartford Grammar and The Leigh Academy. Sutton-at-Hone Primary School which is currently rated at good but aspiring to be outstanding and only 1.6 miles away. Locally there are many excellent leisure facilities including Bluewater shopping centre, The London Golf Club and Brands Hatch motor racing circuit. You will also find and a range of boutique shops, country pubs and restaurants in the surrounding villages.

GROUND FLOOR
1109 sq.ft. (103.0 sq.m.) approx.

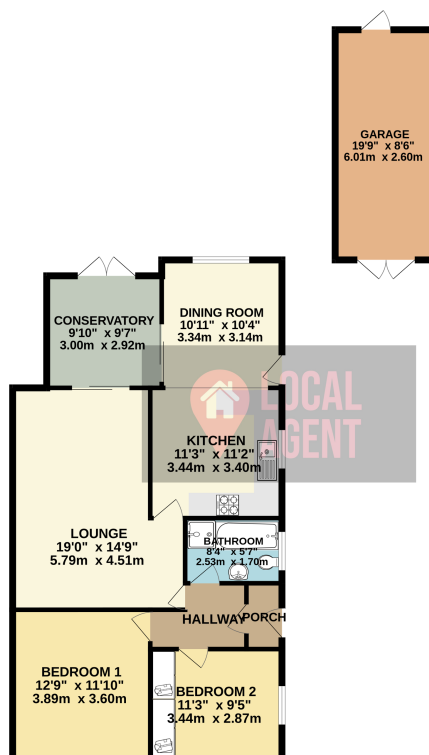

TOTAL FLOOR AREA: 1109 sq.ft. (103.0 sq.m.) approx.

Whilst every attempt has been made to ensure the accuracy of the floorplan contained here, measurements