



Bootham Road | Billericay | £399,995



Bootham Road

Billericay | Essex | CM12 9NG

Located within a short walk of both Billericay High Street and Station is this beautifully presented three bedroom semi detached bungalow. This property has been in the family since 1956 and is being sold with the added advantage of a NO ONWARD CHAIN.

On entering the property you are greeted by a light and bright T shaped entrance all with Amtico style flooring. The accommodation comprises of three bedrooms, a living room with double glazed double doors, a fully fitted kitchen with Worcester Bosch Combination boiler. The property benefits from a modern fitted shower room with separate w/c with matching fully tiled walls.

Outside the property there is a side porch / lobby which is accessed from the kitchen providing extra storage for a Fridge Freezer. To the front of the house there is a beautifully kept front garden with potential to add additional parking and a shared driveway leading to a detached garage with parking in front. The rear garden has several defined areas and with a feature lawn and many patio areas to soak up the summer sun.





- Semi Detached Bungalow
- Separate Bathroom And W/C
- Detached Garage
- Living Room With Double Glazed Patio Doors
- Fitted Kitchen With Range Of Fitted Units
- Double Glazed Side Porch / Lobby
- 60 Ft Rear Garden With Various Patio Areas
- Three Bedrooms (Two Fantastic Doubles)
- Modern Fitted Shower Room



Ground Floor

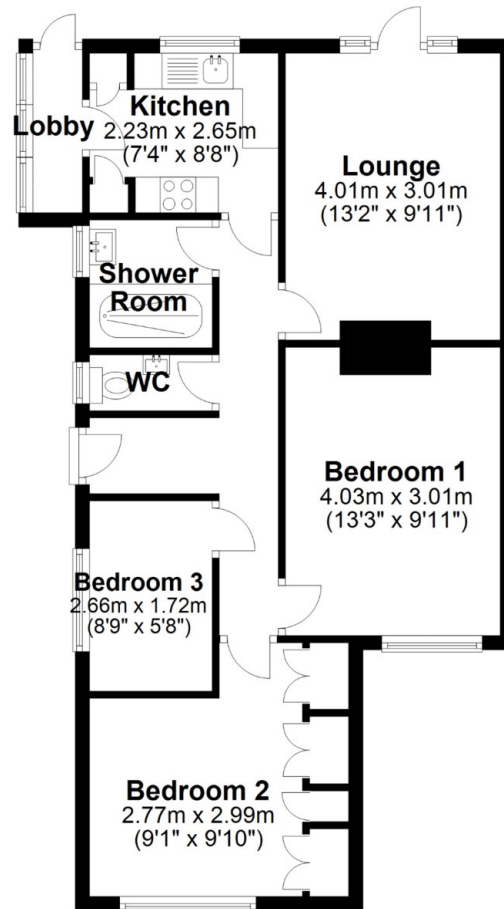

**APPROX INTERNAL FLOOR AREA
62 SQ M 667 SQ FT**

This plan is for layout guidance only and is
NOT TO SCALE

Whilst every care is taken in the preparation
of this plan, please check all dimensions,
shapes & compass bearings before making
any decisions reliant upon them.

Copyright The Property Specialists

Viewing strictly by appointment with The Property Specialists



Making Moving Home
Less Stressful

135 High Street, Billericay,
Essex, CM12 9AB

Tel: 01277 654446

sales@thepropertyspecialists.co.uk