



181 Shepherds Lane, Dartford, Kent, DA1 2PR
£525,000 Freehold



Description

Watch the Video Tour!

Situated in West Dartford, we have for sale a three bedroom chalet style semi detached home which offers great potential to extend to the side. We expecting a lot of interest for the property so please use our online diary to request your viewing.

Located in West Dartford and within walking distance to both Dartford and Crayford High Street. Crayford Retail Park and Crayford Station approximately 1 mile away with direct links to London and within the Oyster zone 6 has become popular for the London commuter and with easy access to the A2 and M25. Perfectly located for easy access to Dartford Grammar Schools and both Wentworth and West Hill Primary Schools. Crayford town centre is a short walk away with many shops, cafes, pubs and restaurants. Other local benefits include the recently refurbished Fairfield Pool & Leisure Centre, David Lloyd Club and Dartford Football Stadium. For Dog walkers and hikers Dartford Heath offers some great local trails.

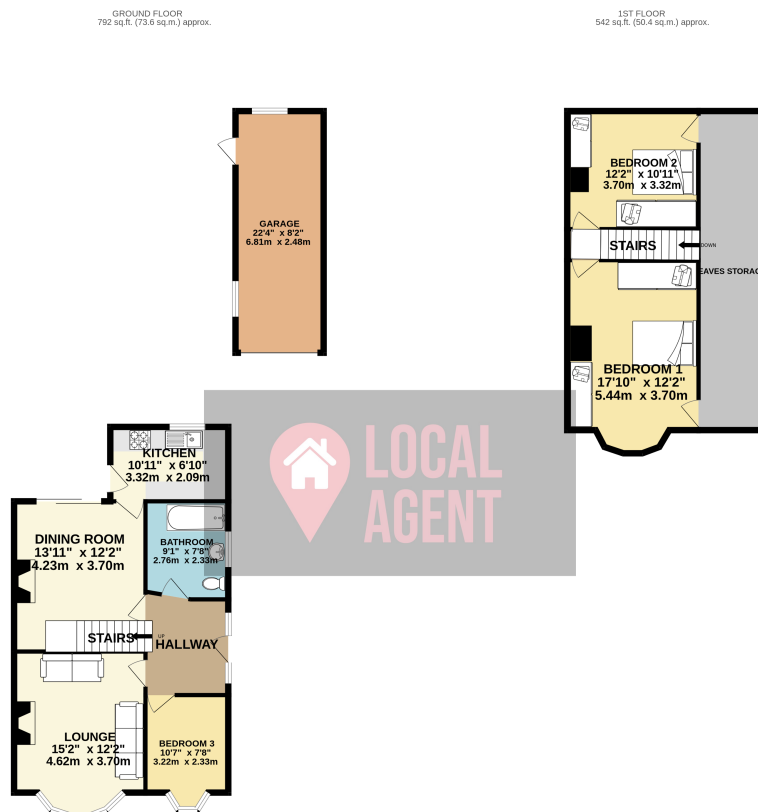

TOTAL FLOOR AREA: 1334 sq.ft. (123.9 sq.m.) approx.
Whilst every attempt has been made to ensure the accuracy of the floorplan contained here, measurements