







**Dale Road North, Darley Dale, Matlock, Derbyshire DE4 2FT**  
**£260,000 - Freehold**





## PROPERTY DESCRIPTION

Derbyshire Properties are delighted to introduce for sale this beautifully presented, stylish mid terraced property located in the highly regarded area of Darley Dale.

The property briefly comprises of spacious entrance hall, lounge, beautiful extended 'open-plan' living kitchen, rear hallway and downstairs guest room/WC. To the first floor a landing provides access to all three bedrooms and a modern bathroom suite. Externally, the property offers a landscaped frontage and enclosed private rear garden with large outside shed and parking to rear.

We believe the property will ideally suit couples and small families and we recommend an early internal inspection to avoid disappointment.

## POINTS OF INTEREST

- Beautiful Mid Terraced Cottage
- Superb Open Plan Dining Kitchen & Living Area
- Rear Hall & Guest Cloakroom
- Modern Fitted Kitchen (With AEG Appliances)
- Parking To Rear
- Landscaped Private Garden
- 3 Bedrooms & 1 Reception Room
- Large 4 Piece Bathroom Suite
- Sought After Location
- Council Tax Band B

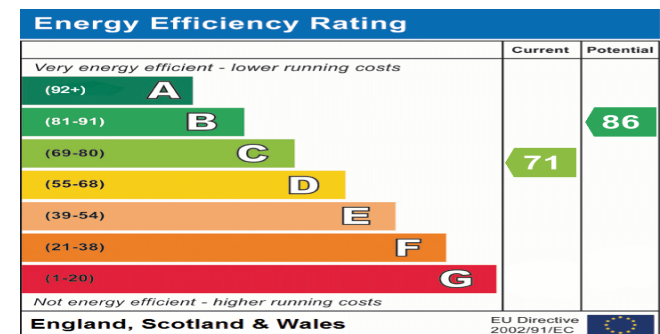

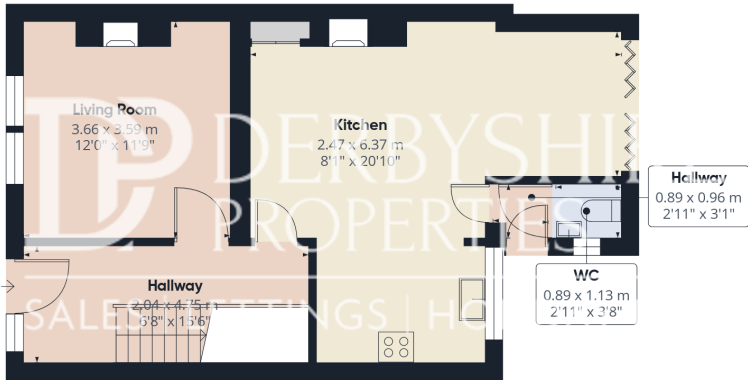

Ground Floor Building 1

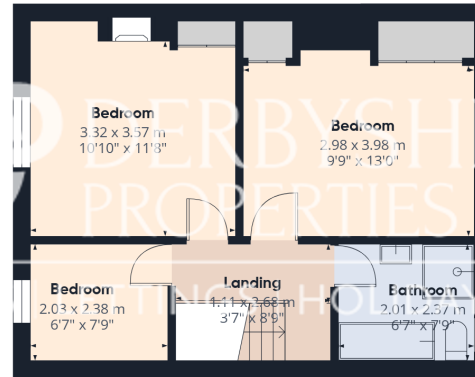

Floor 1 Building 1

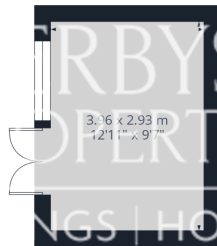

Ground Floor Building 2

Approximate total area<sup>(1)</sup>  
102.6 m<sup>2</sup>  
1104 ft<sup>2</sup>

(1) Excluding balconies and terraces

Calculations reference the RICS IPMS 3C standard. Measurements are approximate and not to scale. This floor plan is intended for illustration only.

GIRAFFE360