



35 The Crescent, Haversham, Milton Keynes, Buckinghamshire, MK19 7AN

£330,000 Freehold

- Three bedroom
- Sought after village of Haversham
- Off road parking for two vehicles
- Semi detached house
- Cul de sac location
- Bay fronted
- Green outlook
- Single garage
- EPC Rating





GROUND FLOOR

Entrance Hall

Doors leading to:

Lounge

5.80m x 3.31m (19' 0" x 10' 10")

Kitchen

Dining Room

3.79m x 3.62m (12' 5" x 11' 11")

FIRST FLOOR

Landing

Doors leading to:

Bedroom One

3.79m x 2.75m (12' 5" x 9' 0")

Bedroom Two

3.50m x 3.18m (11' 6" x 10' 5")

Bedroom Three

2.53m x 2.12m (8' 4" x 6' 11")

Family Bathroom

Fitted to comprise three piece suite

EXTERIOR

Front and Rear Garden

Off Road Parking

Space for two vehicles

Single Garage

Disclaimer

Whilst we have endeavoured to prepare our sales particulars accurately none of the services, appliances or equipment have been tested. A buyer should satisfy themselves on such matters prior to purchase. Any measurements or distances mentioned in these particulars are for guide reference only. If such particulars are fundamental to a purchase, buyers should rely on their own enquiries. All enquiries should be directed to Elevation Estate Agents in the first instance.

Ground Floor



First Floor

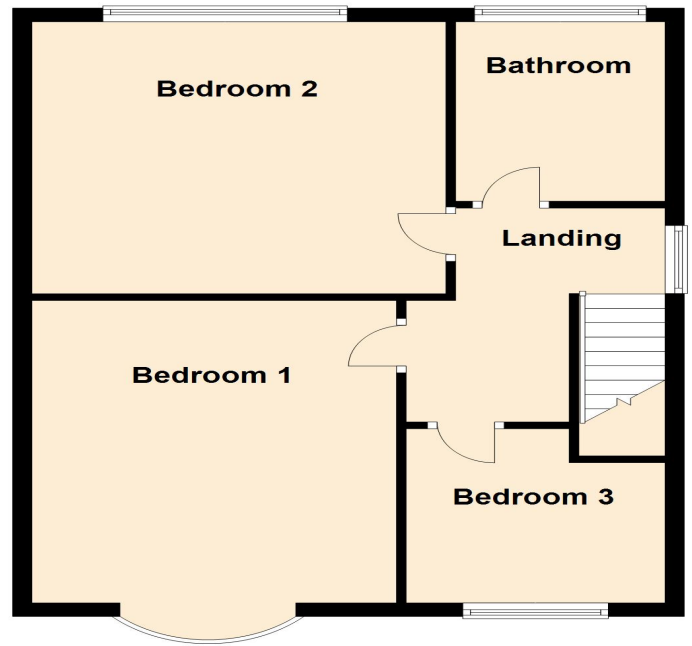

elevation estate agents
Plan produced using PlanUp.