



Tel: 01242 676767

[www.cotswoldestateagents.co.uk](http://www.cotswoldestateagents.co.uk)

41a Church Road, Bishops Cleeve, Cheltenham, GL52 8LP

66, Malleson Road  
Gotherington GL52 9EX

**£590,000**



FOR SALE



Occupying a prime position within a charming village setting with beautiful views to surrounding hills and countryside, is this substantial stone built three bedroom bungalow. The property is set on a large plot within mature enclosed gardens. The spacious well planned living accommodation features sitting room/snug with door to a secluded covered patio, large open plan lounge with vaulted ceiling, dining area, 25' kitchen/breakfast room and utility room. There is a cloakroom, modern shower room and three good size bedrooms. To the exterior a driveway offering ample hardstanding for a number of vehicles with room for a motorhome/caravan leads to a garage. There are mature and impressive gardens with outstanding views to Crane Hill, The Manor and the village of Woolstone.

Location: Gotherington is a thriving North Gloucestershire village which benefits from many amenities including a village shop/post office, community centre, popular primary school and public house, the village is also surrounded by lovely open farmland ideal for country walks. The larger regional centre of Bishops Cleeve is approximately 1 mile distance and providing an excellent range of day to day shops, supermarkets, doctor's surgery and excellent secondary school. The Spa town of Cheltenham is approximately 6 miles away with its fashionable range of amenities.









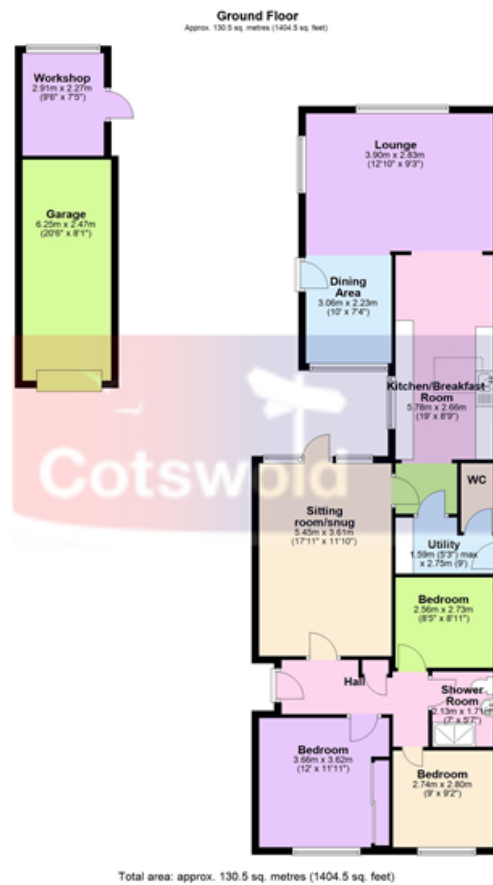

Energy Efficiency Rating		
	Current	Potential
Very energy efficient - lower running costs		
(92+) <b>A</b>		
(81-91) <b>B</b>		
(69-80) <b>C</b>		
(55-68) <b>D</b>	64	73
(39-54) <b>E</b>		
(21-38) <b>F</b>		
(1-20) <b>G</b>		
Not energy efficient - higher running costs		
<b>England, Scotland &amp; Wales</b> <div>EU Directive 2002/91/EC</div>		