

SOLE
AGENT

Serenity

Les Camps du Moulin | St Martin | GY4 6AD

Serenity is presented to the market in excellent condition having been recently upgraded by the current owners. This end-terrace cottage is located in the centre of the highly desirable St Martin village with the parish amenities on your doorstep. Accommodation comprises open plan lounge/diner, kitchen/breakfast room, two bedrooms and a bathroom. To the rear of the property is a low maintenance, south-facing garden laid predominantly to artificial grass with a small patio area. At the foot of the garden is a small workshop with power and lighting. There is also a partially renovated granite outbuilding, accessed from the side passage, which is ideal to house a motorbike or similar. There is parking for two cars on the tarmac driveway to the front.

£595,000

ESTATE AGENTS & PROPERTY MANAGERS

2 BEDROOMS

1 BATHROOM

1 RECEPTION

Shields
& Rutland

OPENING DOORS SINCE 1993

PHOTOS



PHOTOS



PHOTOS



SPECIFICATIONS

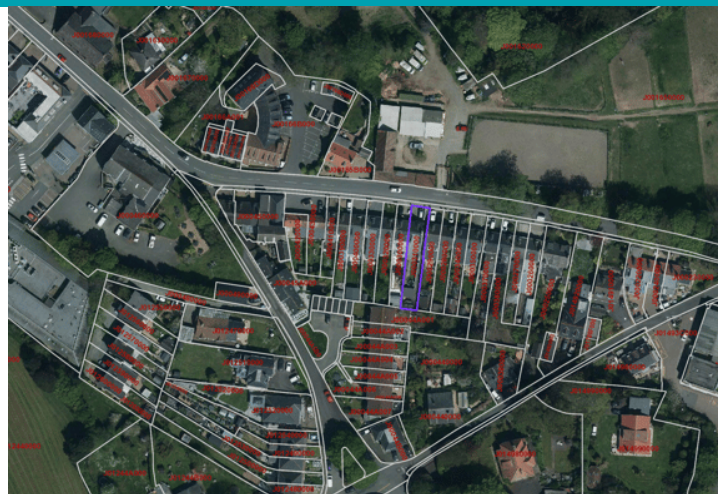
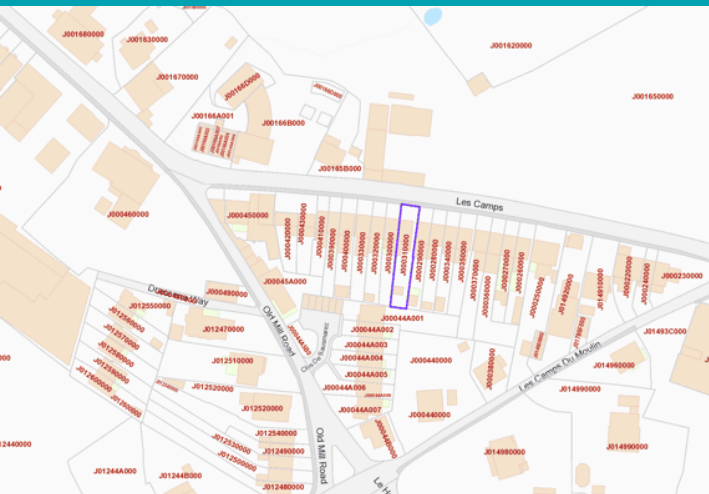

Entrance Porch

2.17m x 1.23m (7' 1" x 4' 0")

Entrance Hall

4.68m x 1.65m (15' 4" x 5' 5")

Lounge/Diner

4.68m x 1.65m (15' 4" x 5' 5")

Kitchen/Breakfast Room

4.78m x 3.18m (15' 8" x 10' 5")

Rear Hall

1.23m x 0.84m (4' 0" x 2' 9")

Bathroom

2.77m x 1.66m (9' 1" x 5' 5")

First Floor Landing

1.80m x 0.93m (5' 11" x 3' 1")

Bedroom 1

4.62m x 3.37m (15' 2" x 11' 1")

Bedroom 2

3.61m x 3.16m (11' 10" x 10' 4")

Garden

To the rear of the property is a low maintenance, south-facing garden laid predominantly to artificial grass with a small patio area. At the foot of the garden is a small workshop with power and lighting. There is also a partially renovated granite outbuilding, accessed from the side passage, which is ideal to house a motorbike or similar.

Parking

There is parking for two cars on the tarmac driveway to the front.

PRICE INCLUDES

Curtains, Carpets and Light fittings.

SPECIAL FEATURES

- Outbuilding/workshop
- Multifuel stove
- south-facing garden
- Recently upgraded

SERVICES

Mains drain, water and electricity. Gas fired central heating. uPVC double glazing.

APPLIANCES INCLUDED

- Four-ring hob
- Hotpoint double oven
- Integrated dishwasher
- Samsung fridge freezer
- Hotpoint washing machine
- Hotpoint tumble dryer

SCHOOL CATCHMENT

- St Martins Primary School
- Les Beaucamps High School

FLOORPLAN

GROUND FLOOR

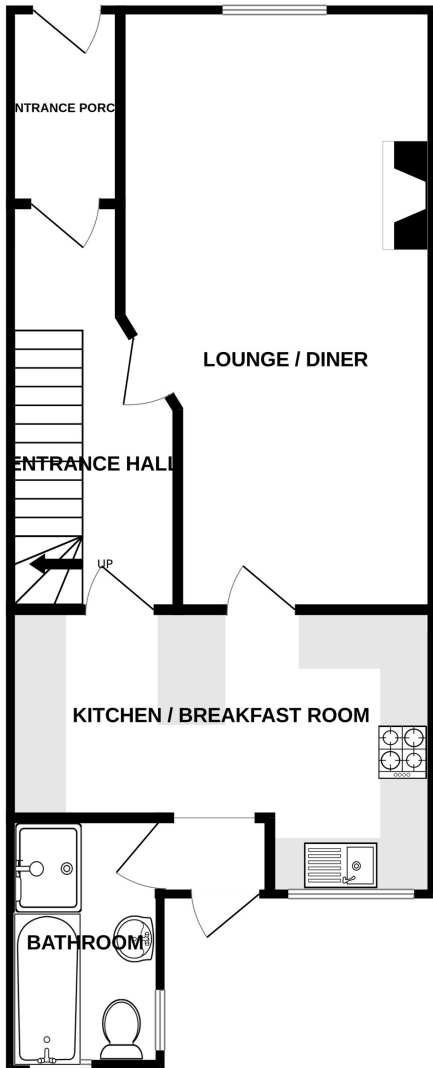

1ST FLOOR

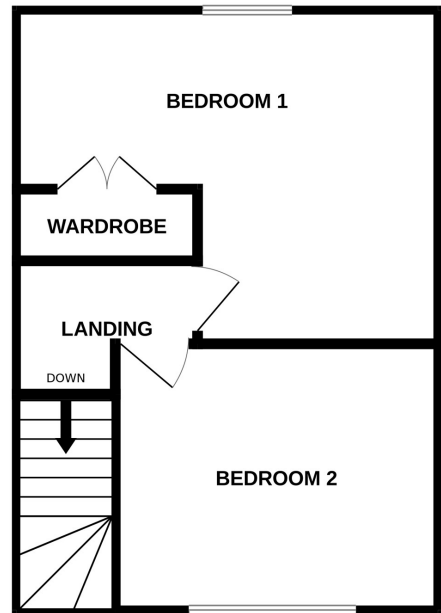

SERENITY

Whilst every attempt has been made to ensure the accuracy of the floorplan contained here, measurements of doors, windows, rooms and any other items are approximate and no responsibility is taken for any error, omission or mis-statement. This plan is for illustrative purposes only and should be used as such by any prospective purchaser. The services, systems and appliances shown have not been tested and no guarantee as to their operability or efficiency can be given.
Made with Metropix ©2026

T 01481 714445
E info@shieldsandrutland.gg

Shields & Rutland, Le Foulon Business Centre Le Foulon, St Peter Port,
GY1 1YR

shieldsandrutland.gg

Shields
& Rutland

OPENING DOORS SINCE 1993