



Flat 3 Cobthorn Sydney Street, Northwich, Cheshire, CW8 4AP

£100,000



A fully refurbished first floor apartment in convenient central location. The property boasts well-proportioned accommodation and is offered in excellent decorative condition throughout. With gas central heating and PVCu double glazing, comprises: Own private entrance to hall with staircase to landing area, box room, lounge, kitchen dining room, two good size bedrooms and luxury bathroom. Externally there is a private balcony off the lounge and there is an allocated parking space in an areas behind the property. The property is currently let on an Assured Shorthold Tenancy with a passing rent of £595pcm, making it an ideal investment. An internal appointment is advised.

GROUND FLOOR

ENTRANCE HALL

Private entrance door leading to hall with private staircase to first floor.

FIRST FLOOR

LANDING

1.76m x 2.33m (5' 9" x 7' 8")

BOX ROOM

LOUNGE

3.41m x 4.56m (11' 2" x 15' 0")

Aspect to front with door leading on to a private balcony.

KITCHEN & DINING AREA

2.44m x 4.56m (8' 0" x 15' 0")

Modern fitted kitchen units and wood effect worktops. Part tiled walls. space and plumbing for appliances. Built-in electric oven and ceramic hob. Space for dining table.

BEDROOM 1

3.40m x 3.35m (11' 2" x 11' 0")

Rear aspect. Built-in double wardrobe.

BEDROOM 2

2.39m x 3.35m (7' 10" x 11' 0")

Rear aspect.

BATHROOM

2.38m x 1.71m (7' 10" x 5' 7")

A luxury bathroom with panelled shower bath with shower and screen over, wash hand basin and WC. Built-in cupboard housing gas boiler.

EXTERNAL

GARDENS & PARKING

Communal garden and allocated parking space.



These particulars, whilst believed to be accurate are set out as a general outline only for guidance and do not constitute any part of an offer or contract. Intending purchasers should not rely on them as statements of representation of fact, but must satisfy themselves by inspection or otherwise as to their accuracy. All measurements quoted are approximate. We are unable to confirm the working order of any fixtures and fittings including appliances that are included in these particulars. No person in this firm's employment has the authority to make or give any representation or warranty in respect of the property.

First Floor

Approx. 61.5 sq. metres (662.1 sq. feet)

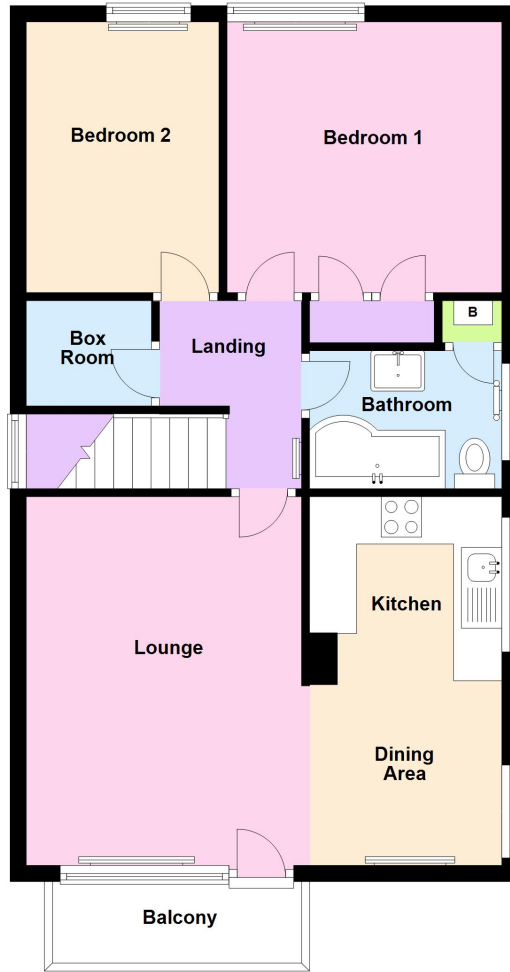

Total area: approx. 61.5 sq. metres (662.1 sq. feet)

This plan is included as a service to our customers and is intended as a GUIDE TO LAYOUT only. Dimensions are approximate. DO NOT SCALE.

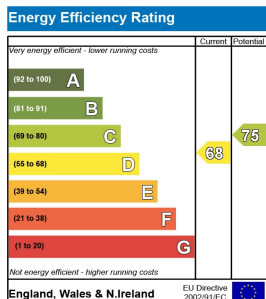

33, The Green, Hartford, Northwich, CW8 1QA

01606 331784

Email: enquiries@westates.co.uk

www.westates.co.uk

