



## Beckford Building, Heritage Lane, West Hampstead, NW6

£495,000



## Beckford Building, Heritage Lane, West Hampstead, NW6

An ideal first time purchase or Pied-à-terre is this modern 441 Sq Ft (40 Sq M) third floor apartment with balcony. Residents of this development have access to a state of the art gym, health spa with a sauna and steam room as well as landscaped communal gardens and 24/7 concierge.

This fine flat benefits from a contemporary fully fitted kitchen, stylish bathroom and a spacious bedroom area.

Beckford Building is located within West Hampstead Square and just yards away from the restaurants, vast transport links and local amenities that West End Lane has to offer.

### Features

- Located In The Heart Of West Hampstead
- Ideal First Time Purchase Or Pied-A-Terre
- Third Floor
- Access To Gym, Sauna & Steam Room
- Landscaped Communal Gardens
- 24/7 Concierge
- 441 Sq Ft (40 SQ M) Of Internal Space
- Modern Apartment
- Stylish Bathroom



Beckford Building,  
Heritage Lane, West  
Hampstead, NW6

Beckford Building,  
Heritage Lane, NW6

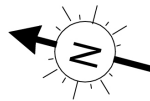

 - Ceiling Height

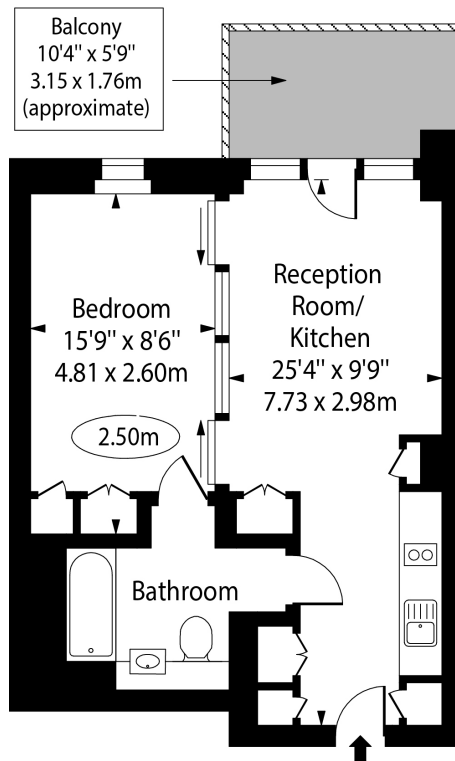

Third Floor

Approx Gross Internal Area 441 Sq Ft - 40.99 Sq M

For Illustration Purposes Only - Not To Scale Floor Plan by [www.nogaphotostudio.com](http://www.nogaphotostudio.com) Ref: No.49851

This floor plan should be used as a general outline for guidance only. Any intending purchaser or lessee should satisfy themselves by inspection, searches, enquiries and full survey as to the correctness of each statement. Any areas, measurements or distances quoted are approximate and should not be used to value a property or be the basis of any sale or let.