

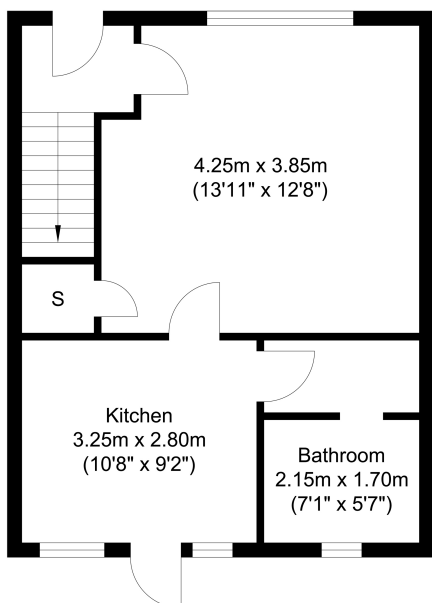

Walsall Road  
West Bromwich  
B71 3JD  
£215,000

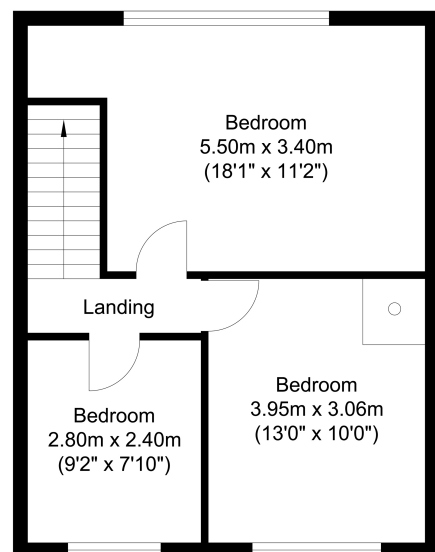

Ground Floor



First Floor







# Walsall Road

## West Bromwich, B71 3JD

Available with NO UPWARD CHAIN! This three-bedroom, terraced family home briefly compromises; spacious living with three double bedrooms, Front allocated parking and a mature rear garden. As well as being situated in a popular residential location, within walking distance of local amenities, plus exceptionally convenient travel links.

Internally, this excellent family home compromises of a spacious front lounge, fitted kitchen/Diner, three double bedrooms, as well as a downstairs bathroom suite. The rear garden is generously sized equipped with both a patio and lawn area. Furthermore, the property has double glazing throughout with huge potential for prospective purchasers. To register your interests and arrange an early viewing appointment, call our office today!



- Ground Floor
  - Lounge
    - 10' 11" x 13' 10" (3.33m x 4.22m)
  - Kitchen/diner
    - 9' 05" x 10' 04" (2.87m x 3.15m)
  - Family Bathroom
    - 5' 01" x 6' 06" (1.55m x 1.98m)
- First Floor
  - Landing Area
    - 7' 02" x 7' 10" (2.18m x 2.39m)
  - Bedroom One
    - 7' 09" x 9' 09" (2.36m x 2.97m)
  - Bedroom Two
    - 9' 11" x 12' 10" (3.02m x 3.91m)
  - Bedroom Three
    - 10' 10" x 14' 09" (3.30m x 4.50m)
  - Outside
    - Rear Garden