



**Fairhurst, Compayne Gardens, South Hampstead, NW6**

**£525,000**



## Fairhurst, Compayne Gardens, South Hampstead, NW6

A well presented and perfectly located two double bedroom, two bathroom duplex apartment offering 761 Sq Ft (70 Sq M) of internal space. This apartment would make an ideal first time purchase or buy to let investment.

Arranged over the second and third floors of a well maintained building, this generously proportioned flat offers a spacious reception room and a separate kitchen on the lower level with two double bedrooms and two bathrooms upstairs.

Additional key features include access to secure private parking (whereby you can rent a space) and access to communal storage units which can also be rented by residents.

Compayne Gardens is ideally located close to various travel links including Finchley Road Underground (Jubilee and Metropolitan), West Hampstead Underground (Jubilee), West Hampstead Thameslink and Swiss Cottage underground (Jubilee) with local amenities also within easy reach.

### Features

- Duplex Apartment
- Two Double Bedrooms
- Two Bathrooms
- 761 Sq Ft (70 Sq M) Of Internal Space
- Ideal First Time Purchase or BTL Investment
- Close To Several Transport Links
- Separate Kitchen
- Spacious Reception Room





Fairhurst, Compayne  
Gardens, South  
Hampstead, NW6

Fairhurst,  
Compayne Gardens, NW6

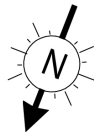

 - Ceiling Height

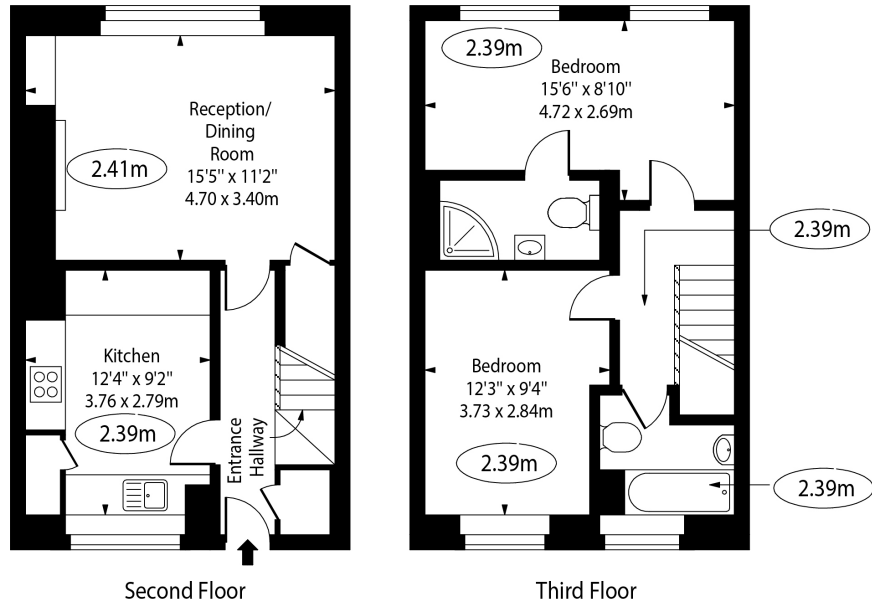

Approx Gross Internal Area 761 Sq Ft - 70.70 Sq M

For Illustration Purposes Only - Not To Scale Floor Plan by [www.nogaphotostudio.com](http://www.nogaphotostudio.com) Ref: No.47449

This floor plan should be used as a general outline for guidance only. Any intending purchaser or lessee should satisfy themselves by inspection, searches, enquiries and full survey as to the correctness of each statement. Any areas, measurements or distances quoted are approximate and should not be used to value a property or be the basis of any sale or let.