



Basement Flat, Zinzan Street, Reading.

£165,000 Leasehold

Arins Tilehurst - Offered to the market with no onward chain complications is this one bedroom basement flat. The property is located within walking distance of the town centre, in reach of the wide range of local shopping facilities and amenities available on both Oxford Road and the town centre. The property also has great access to the A4 Bath Road, leading to Newbury and the M4 motorway, with Reading West and Reading Central train stations being within convenient travelling distance. Accommodation includes a lounge kitchenette, one bedroom and a shower room. Other features include a communal garden, gas central heating and double glazed windows throughout.

- One Bedroom
- Lounge Kitchenette
- Shower Room
- No Onward Chain
- Close to Reading West Train Station
- Close to Reading Town Centre
- Communal Garden



GROUND FLOOR
391 sq.ft. (36.3 sq.m.) approx.

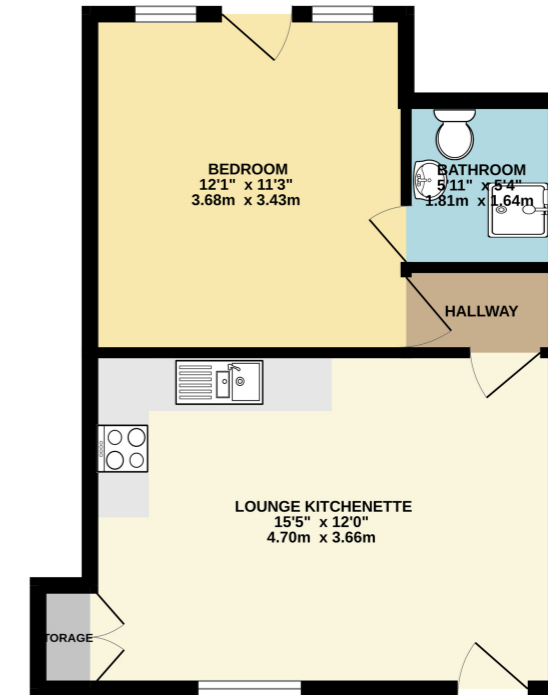

ZINZAN STREET
TOTAL FLOOR AREA : 391 sq.ft. (36.3 sq.m.) approx.
While every attempt has been made to ensure the accuracy of the floorplan compared to the measurements of doors, windows, rooms and any other items are approximate and no responsibility is taken for any error, omission or mis-statement. This plan is for illustrative purposes only and should be used as such by any prospective purchaser. The services, systems and appliances shown have not been tested and no guarantee as to their operability or efficiency can be given.
Made with Metropix ©2023

Property Description

Basement Level

Lounge Kitchenette

15' 5" x 12' 0" (4.70m x 3.66m)

Bedroom

12' 1" x 11' 3" (3.68m x 3.43m)

Bathroom

5' 11" x 5' 4" (1.80m x 1.63m)

Gardens

Council Tax Band

