





Lounge

16' 6" x 10' 11" (5.03m x 3.33m)

Kitchen

16' 6" x 11' 9" (5.03m x 3.58m)

Family Area

12' 1" x 8' 9" (3.68m x 2.67m)

W.C.

Bedroom One

11' 1" x 10' 6" (3.38m x 3.20m)

Dressing Room

8' 10" x 7' 9" (2.69m x 2.36m)

Bedroom Two

11' 10" x 9' 8" (3.61m x 2.95m)

Bedroom Three

Bathroom

11' 10" x 6' 6" (3.61m x 1.98m)

Garden

Off Street Parking

Off Street Parking For Two cars.

Area Information

The village of Lydden is found in beautiful surrounding landscape. The area is set in a steep sided valley with grazing pasture and pockets of woodland along the valley side facing north west and an extensive National Nature Reserve. There is a Doctors surgery and local public house, as well as a well regarded primary school. The Lydden Race Circuit is located between here and Wootton to the west of the village. There are excellent links to the A2 as well as the village being on the cusp of the historic seaside town of Dover with its schools, high street and high speed rail link into St Pancras, London.

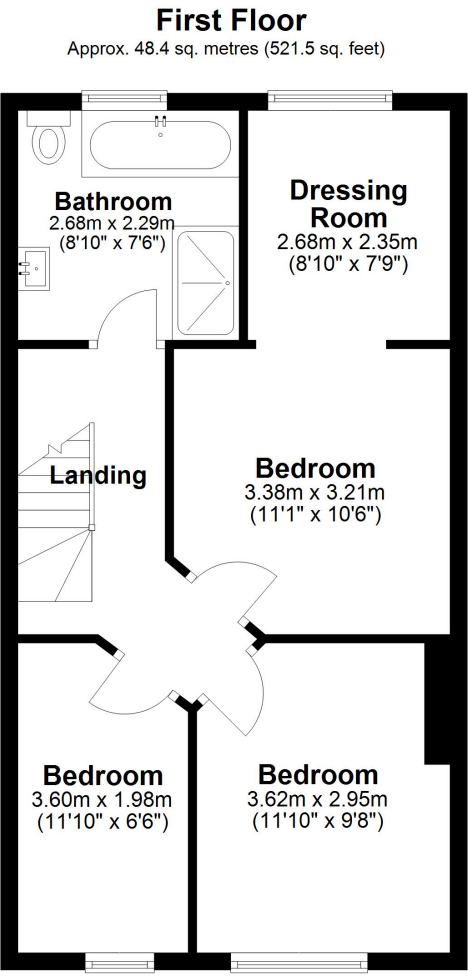
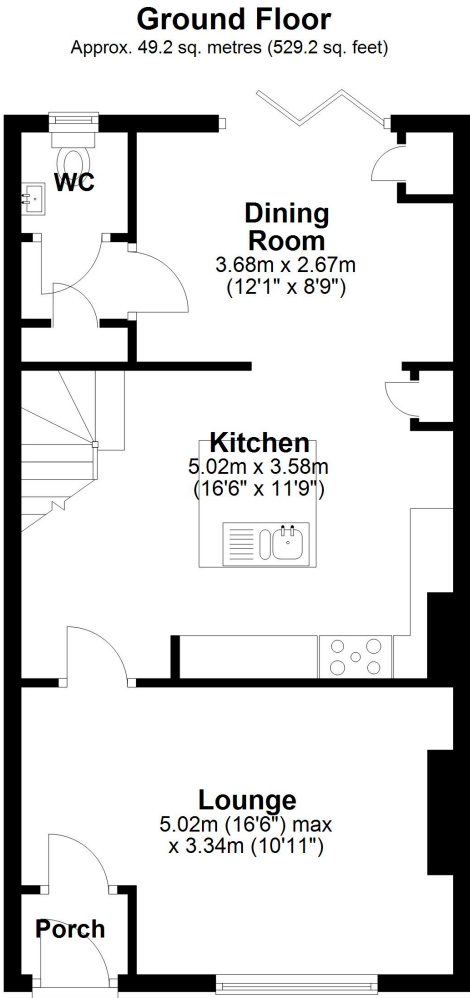

Total area: approx. 97.6 sq. metres (1050.7 sq. feet)

