



Offers Over £110,000
72 Centenary Court
Leven, KY8 4AL



DELMOR
01333 421 816
leven@delmor.co.uk



Centenary Court

Leven, KY8 4AL

Beautifully upgraded mid-terraced three-bedroom home set within the highly desirable Mountfleurie area of Leven. Recently refreshed throughout. The property features a brand-new kitchen and bathroom, offering a modern and move-in-ready feel. The private rear garden provides direct access to parking, adding to everyday convenience. Perfectly positioned for local primary schools, bus routes, and a wide range of nearby amenities, this appealing home will suit a variety of buyers.





Lounge

A generous, bright living space with a large window overlooking one of the grass areas within Centenary Court. Newly fitted grey wood-effect vinyl flooring adds a modern touch, and the room has been freshly redecorated throughout. Ornate cornicing and a decorative ceiling rose complete the finish. The UPVC front door opens directly from the lounge into the paved front garden.

Kitchen

Brand-new white gloss J-pull kitchen, featuring an integrated fridge-freezer, oven, four-burner gas hob, and extractor. Finished with stylish grey worktops and offering ample floor and wall-mounted storage. Includes a stainless-steel sink with mixer tap and drainer, plus a handy small breakfast bar. Grey wood-effect vinyl flooring completes the modern look. Access to the rear garden is provided via the UPVC door.

Bedroom 1

Large double carpeted bedroom with double in built storage. Boiler is housed within this room. Large window overlooking the rear of the property.



Bedroom 2

Carpeted double bedroom situated to the front of the property. Freshly decorated. Large window. In built original storage with double louvre doors.

Bedroom 3

Downstairs bedroom overlooking the rear garden. Large window giving an abundance of natural light. Newly fitted wood effect vinyl flooring.

Bathroom

Newly installed white bathroom suite featuring a space saving sink with vanity unit, low-flush WC, and a bath fitted with a mixer tap and handheld shower. Finished with modern grey wet-wall panels and tile-effect flooring. A window provides excellent natural light and ventilation.

Gardens

A small paved front garden leads to the UPVC front door.

The rear garden offers a private, fully paved space with high fencing and direct access to the parking area.

Both the front and rear gardens are low-maintenance and level, making them easy to manage.



Heating and glazing

Double glazing throughout.
Combi boiler, gas central heating.

Contact Details

Delmor Estate Agents
52 Commercial Road
Leven
KY8 4LA
Tel: 01333 421816
www.delmor.co.uk
leven@delmor.co.uk



Approx Gross Internal Area
72 sq m / 778 sq ft

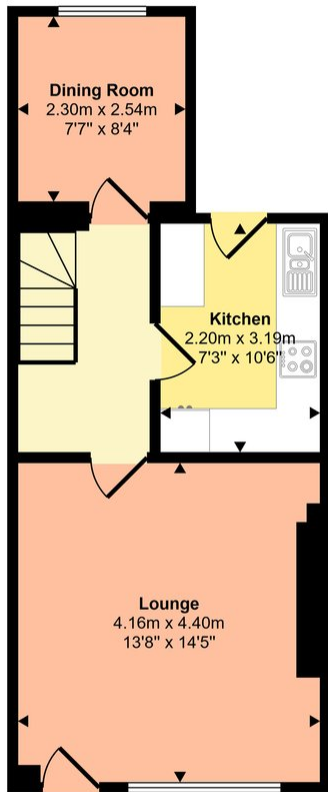

Ground Floor
Approx 39 sq m / 416 sq ft

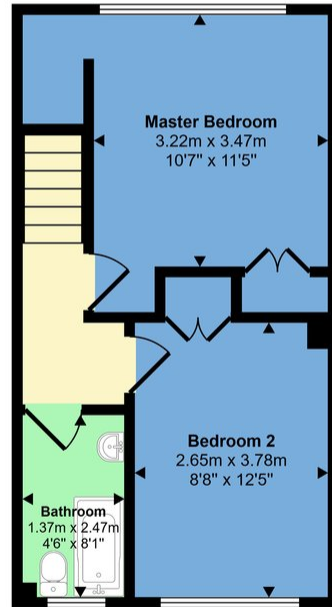

First Floor
Approx 34 sq m / 361 sq ft

This floorplan is only for illustrative purposes and is not to scale. Measurements of rooms, doors, windows, and any items are approximate and no responsibility is taken for any error, omission or mis-statement. Icons of items such as bathroom suites are representations only and may not look like the real items. Made with Made Snappy 360.



Energy Efficiency Rating		Current	Potential
Very energy efficient - lower running costs			
(92+)	A		
(81-91)	B		
(69-80)	C	73	79
(55-68)	D		
(39-54)	E		
(21-38)	F		
(1-20)	G		
Not energy efficient - higher running costs			
England, Scotland & Wales		EU Directive 2002/91/EC	

52 Commercial Street, Leven, KY8 4LA

01333 421 816

leven@delmor.co.uk