



Three Bedroom Terraced House  
Castle Road, Chatham, Kent, ME4 5JA

Guide Price £220,000  
Freehold

Castle Road, Chatham, Kent, ME4 5JA

Guide Price £220,000

Freehold

## Description

Guide Price £220,000 - £230,000

Excellent order throughout as recently refurbished by the current vendor. Ideal for a first time buyer to move straight into or an investor to rent out. Accommodation comprises: storm porch and door into the Lounge with newly fitted carpets and feature fireplace with grate. The dining room is separate to the Lounge and leads into the recently fitted kitchen with electric hob and fan assisted oven. The bathroom is to the rear of the property to the ground floor. Upstairs are three bedrooms. The third bedroom leads off of the second. All bedrooms are of a good size. The rear garden is laid to lawn with slabbed patio area and fence enclosed with rear gate access. Convenient for Chatham Town Centre and mainline railway station.

## Key Features

- No Chain
- Three bedroom house
- Convenient for Chatham Town Centre
- Refurbished
- Recently fitted kitchen
- Double glazing
- Central Heating
- Rear Garden

## Local Area

Chatham is located within the Medway towns with good transfer links by rail into Central London and Ebbsfleet International plus road connections to the M2/M25 & M20. Amenities include a bustling Town Centre, the Historic Dockyard, Capstone Ski & Snowboard centre and nearby Gillingham FC and Rochester Castle & Cathedral.

GROUND FLOOR  
374 sq.ft. (34.7 sq.m.) approx.

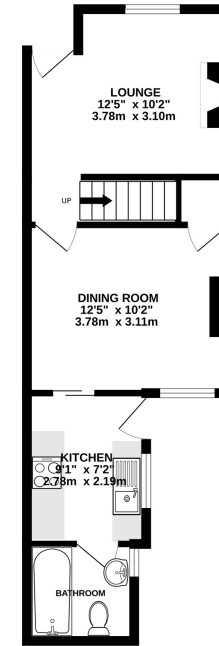

1ST FLOOR  
347 sq.ft. (32.2 sq.m.) approx.

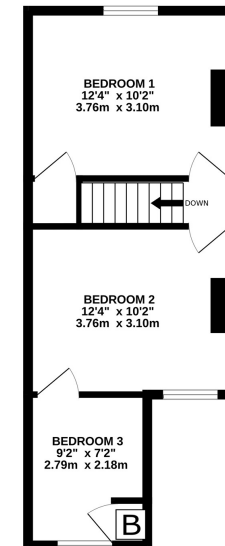

TOTAL FLOOR AREA : 721 sq.ft. (66.9 sq.m.) approx.

Whilst every attempt has been made to ensure the accuracy of the floorplan contained here, measurements of doors, windows, rooms and any other items are approximate and no responsibility is taken for any error, omission or mis-statement. This plan is for illustrative purposes only and should be used as such by any prospective purchaser. The services, systems and appliances shown have not been tested and no guarantee as to their operability or efficiency can be given.

Made with Metropix ©2024





## Property Location

Castle Road, Chatham, Kent, ME4 5JA

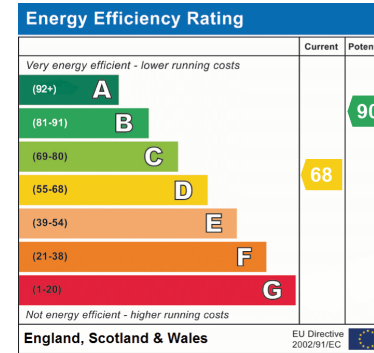
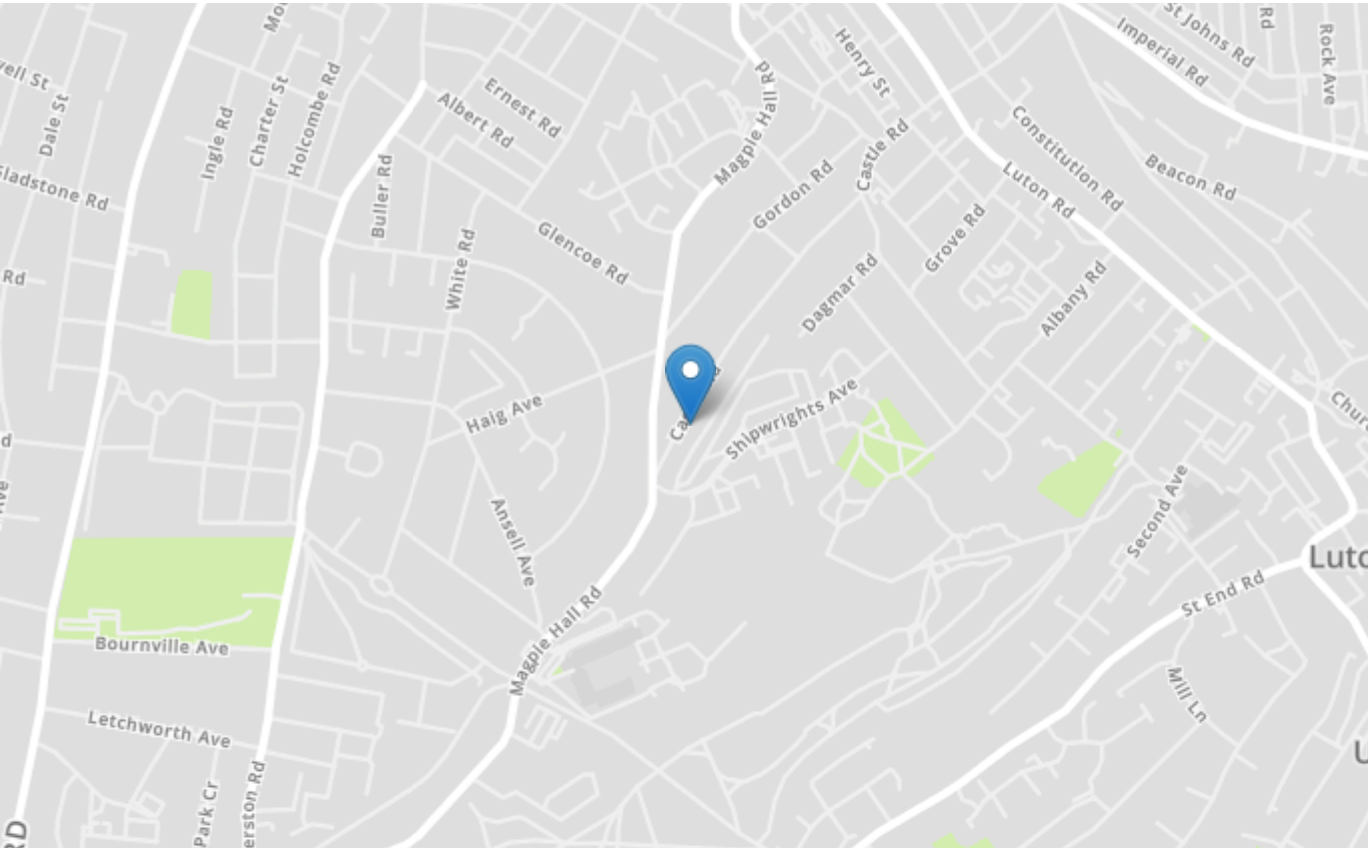

<b>Tenure</b>	Freehold
<b>Lease Term</b>	N/A
<b>Ground Rent</b>	N/A
<b>Service Charge</b>	N/A
<b>Local Authority</b>	Medway
<b>Council Tax</b>	Band B

### Greyfox Walderslade

Unit 2, Thetford House  
Walderslade Village Centre  
Walderslade Road  
Chatham  
Kent  
ME5 9LR  
Tel: 01634 672227 Email:  
walderslade@greyfox.co.uk

### Greyfox Rainham

67C High Street  
Rainham  
Kent  
ME8 7HS  
Tel: 01634 377737 Email:  
rainham@greyfox.co.uk

#### Agent Notes

These particulars are prepared as a general guide to a broad description of the property and should not be relied upon as a statement or representation of fact and do not constitute part of an offer or contract. The seller does not make or give nor do our employees or Greyfox have authority to make or give any representation or warranty to the property. We have not carried out a structural survey and the services, appliances and specific fittings have not been tested. All photographs, measurements, floorplans and distances referred to are given as a guide only and should not be relied upon for the purchase of carpets or any other fixtures or fittings. Lease details, service charges and ground rent (where applicable) and council tax are given as a guide only and should be checked and confirmed by you on inspection and your solicitor prior to exchange of contracts. If there are any points of particular importance to you we will be pleased to check the information for you and to confirm that the property remains available. This is particularly important should you be travelling some distance to view and where statements have been made by us to the effect that the information has not been verified. The copyright of all details, photographs and floorplans remain exclusive to Greyfox. For details of our privacy policy and referral fee arrangements with any of our selected partner companies please visit <https://www.greyfox.co.uk/legal/privacy> and <https://www.greyfox.co.uk/referral-fees>.