

494a London Road, Slough, Berkshire. SL3 8QX.
£280,000

- *No Onward Chain*
- Easy access to M4/ M25 Motorway Networks
- Short Distance from Heathrow Airport
- Two Bedroom Maisonette
- First Floor
- Generous front Garden
- Garage and Off Street Parking
- Lease of 125 Years
- No Service Charge & No Ground Rent

494a London Road, Slough, Berkshire. SL3 8QX.

£280,000

NO ONWARD CHAIN, two bedroom first-floor maisonette, with 125 YEAR LEASE, NO GROUND RENT or SERVICE CHARGE. Ideally located for HEATHROW AIRPORT & MOTORWAY NETWORKS. The property comes with a GARAGE and off-street parking as well as sole access to the front GARDEN. Ideal first purchase or investment opportunity.

GROUND FLOOR
34 sq.ft. (3.2 sq.m.) approx.

FIRST FLOOR
606 sq.ft. (56.3 sq.m.) approx.

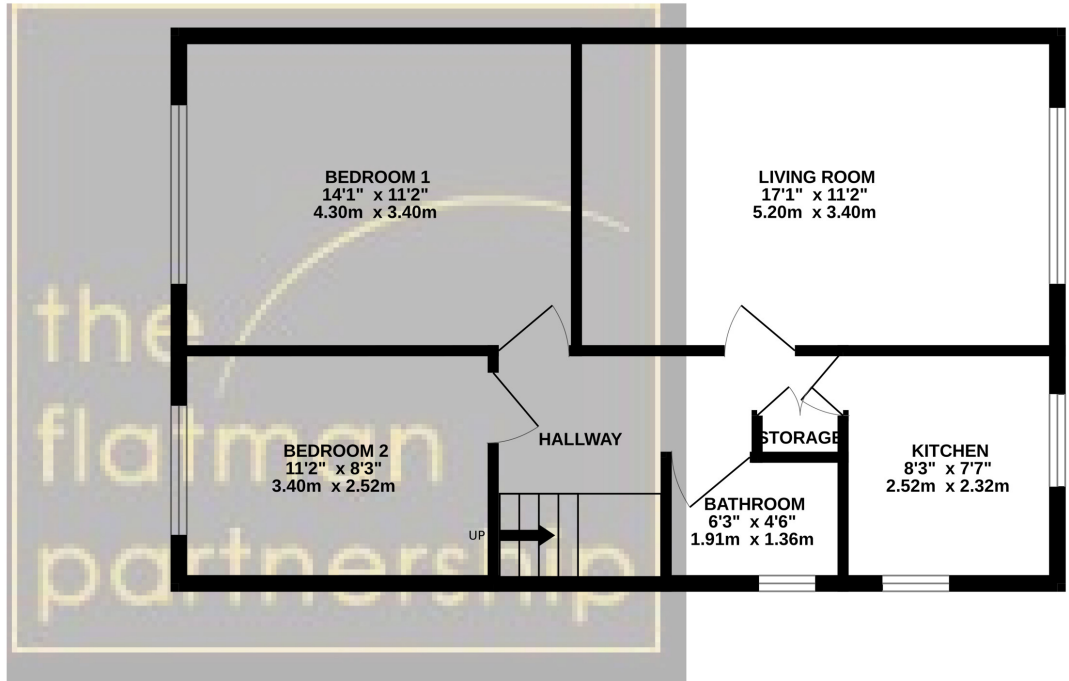
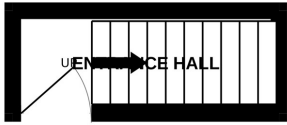

TOTAL FLOOR AREA : 640 sq.ft. (59.5 sq.m.) approx.

Whilst every attempt has been made to ensure the accuracy of the floorplan contained here, measurements of doors, windows, rooms and any other items are approximate and no responsibility is taken for any error, omission or mis-statement. This plan is for illustrative purposes only and should be used as such by any prospective purchaser. The services, systems and appliances shown have not been tested and no guarantee as to their operability or efficiency can be given.
Made with Metropix ©2023

