



Beulah Road, Thornton Heath, Surrey, CR7 8JG

£450,000 Freehold

- Three bedroom terraced house
- Close to transport links
- Cosmetic updating required
- Close to schools, parks and shops
- No onward chain
- Delightful private garden

Beulah Road, Thornton Heath, Surrey, CR7 8JG

£450,000 Freehold

This terraced Victorian home is well located to schools, and local amenities with the convenience of being a short distance away from Thornton Heath Station and bus links, which offer easy access to London, Crystal Palace and London Bridge.

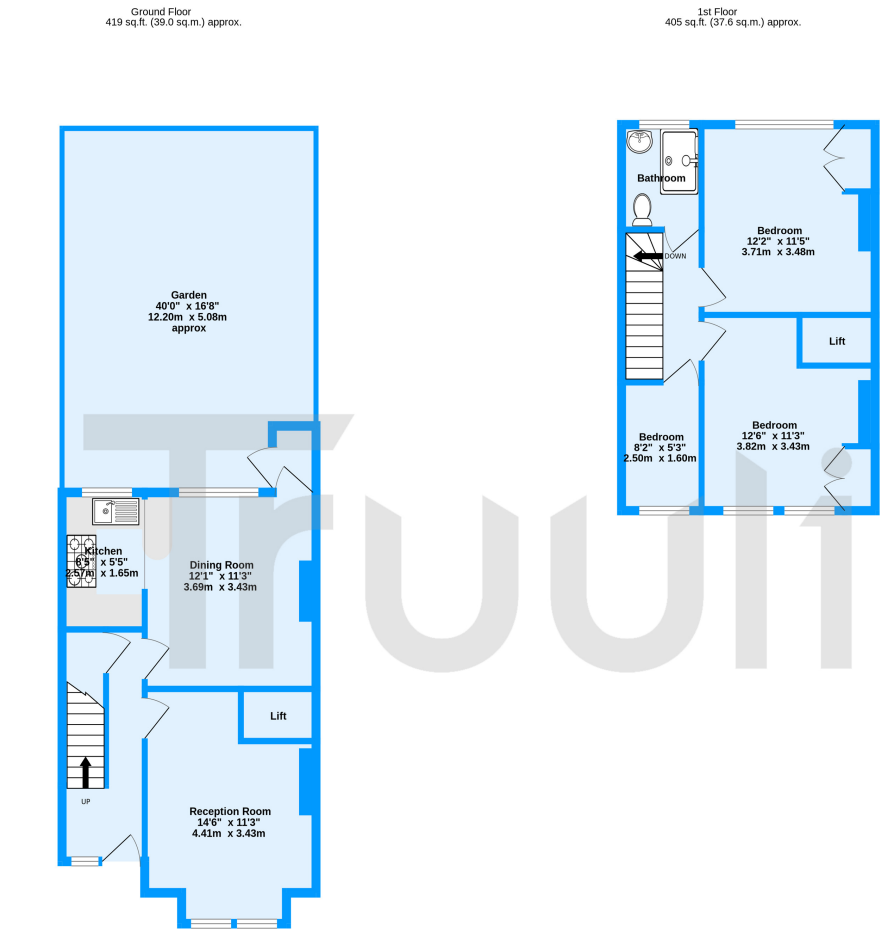

Beulah Road, Thornton Heath, CR7

TOTAL FLOOR AREA : 824 sq.ft. (76.6 sq.m.) approx.

Measurements are approximate. Not to scale. Illustrative purposes only

Made with MetroPix ©2024

