



Allerford Court, Bromley Road, London, SE6 2XL

£330,000 Leasehold

- Top-floor, two-bedroom apartment in a well-maintained purpose-built development
- Elevated second-floor position providing excellent natural light and privacy
- Large galley-style kitchen with ample workspace and storage
- Two generously sized double bedrooms
- Private balconies extending the living space outdoors
- Spacious reception room ideal for relaxing and entertaining
- Large attic offering valuable additional storage, plus communal

Southbridge Place, Croydon, Surrey, CR0 4HA

Tel: 0330 043 0002

Email: save@truuli.co.uk Web: www.truuli.co.uk

Allerford Court, Bromley Road, London, SE6 2XL

£330,000 Leasehold

Bright top-floor two-bedroom apartment in a well-maintained development, featuring a spacious reception room, large galley kitchen, two double bedrooms, private balconies and attic storage. Ideally located close to transport links and local amenities, perfect for first-time buyers or investors.

Allerford Court

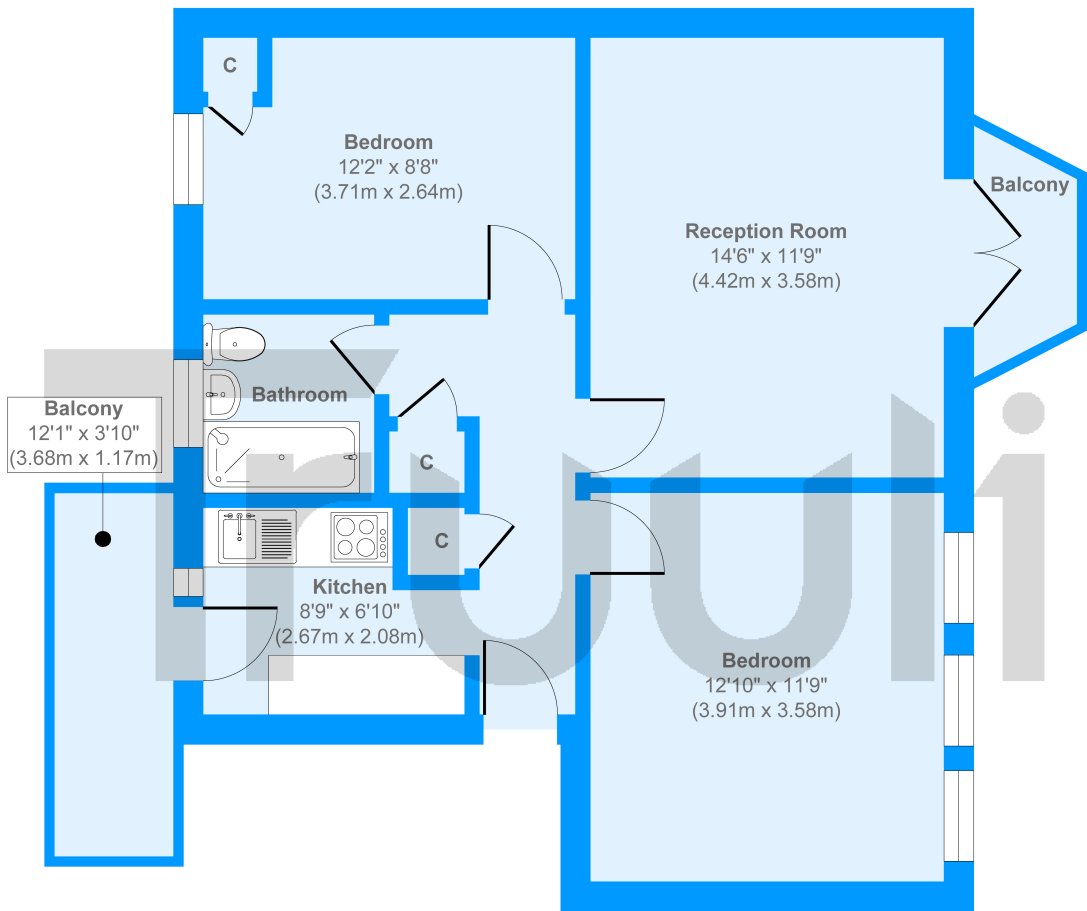

Second Floor

Approx. Gross Internal Floor Area 612 sq. ft / 56.80 sq. m

Produced by Elements Property

