



£1,395 pcm

Freehold

2 MOORE CLOSE QUARTER JACK PARK, WIMBORNE,
DORSET BH21 2GG



- ◆ SEMI-DETACHED HOUSE
- ◆ TWO DOUBLE BEDROOM
- ◆ OFF ROAD PARKING
- ◆ SOUTH FACING GARDEN

A very well-presented two bedroom semi-detached house within the new development of Quarter Jack Park, offering a south facing garden as well as a fully fitted kitchen and off road parking.

Room Description

The home sits towards the westerly edge of the development and the accommodation comprises a living room which in turn gives access to a modern fitted kitchen that enjoys an outlook over the south facing rear garden. There is also a ground floor cloakroom and the first floor boasts two double bedrooms which are served by a fitted family bathroom. The home is entirely double glazed throughout and also offers gas fired heating.

Gardens and Grounds

There are kept beds to the front elevation and there is a driveway to the right hand side, suited to two vehicles. There is a garden gate that denotes access to the rear garden, which is primarily laid to a kept lawn, and there is a small patio area adjoining the rear elevation to the property.

Location

Wimborne is a vibrant and thriving market town in East Dorset with a comprehensive mix of shopping facilities, restaurants, and attractions to appeal to everyone. Easily accessed by car from all directions via the A31, A35 and B3081 Wimborne has great public transport links to Bournemouth, Poole and surrounding areas including a comprehensive network of bus routes. Wimborne is immersed in a varied history, preserved and on-show in the c.705 AD Minster Church of Cuthburga with its chained library which is one of only four world-wide. The beautiful twin towers of the Minster provide an elegant backdrop to the town's historic architecture and alongside The Priest's House Museum & Gardens, Wimborne Model Town and the 1930's Art Deco Tivoli theatre, combine to make Wimborne a popular tourist attraction. Wimborne is well served by an excellent range of services for residents including doctors, a local hospital, a pyramid of sought-after schools and strong health and social care. Leisure facilities are well catered for and the town is within easy access to the county's areas of outstanding natural beauty offering miles of bridleways, footpaths and coastal routes to explore.



Size: 653 sq ft (60.6 sq m)

Heating: Gas fired (combi - less than 2 yrs old)

Glazing: Double glazed

Parking: Off road

Garden: South facing

Main Services: Electric, water, gas, drains, telephone

Local Authority: Dorset Council

Council Tax Band: C

GROUND FLOOR
326 sq.ft. (30.3 sq.m.) approx.

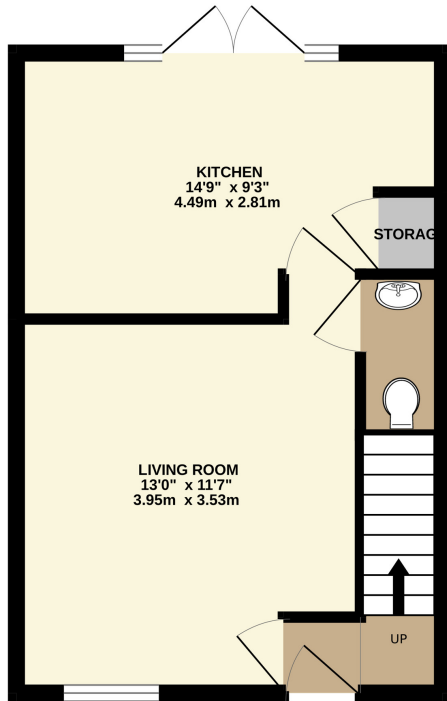

1ST FLOOR
326 sq.ft. (30.3 sq.m.) approx.

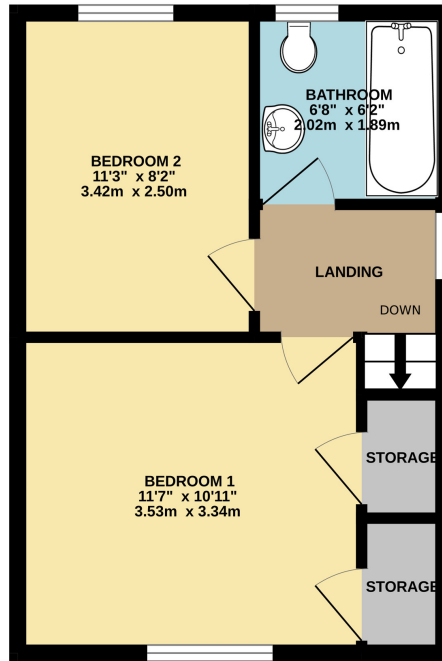

TOTAL FLOOR AREA : 653 sq.ft. (60.6 sq.m.) approx.
Measurements are approximate. Not to scale. Illustrative purposes only
Made with Metropix ©2023



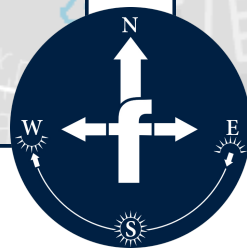
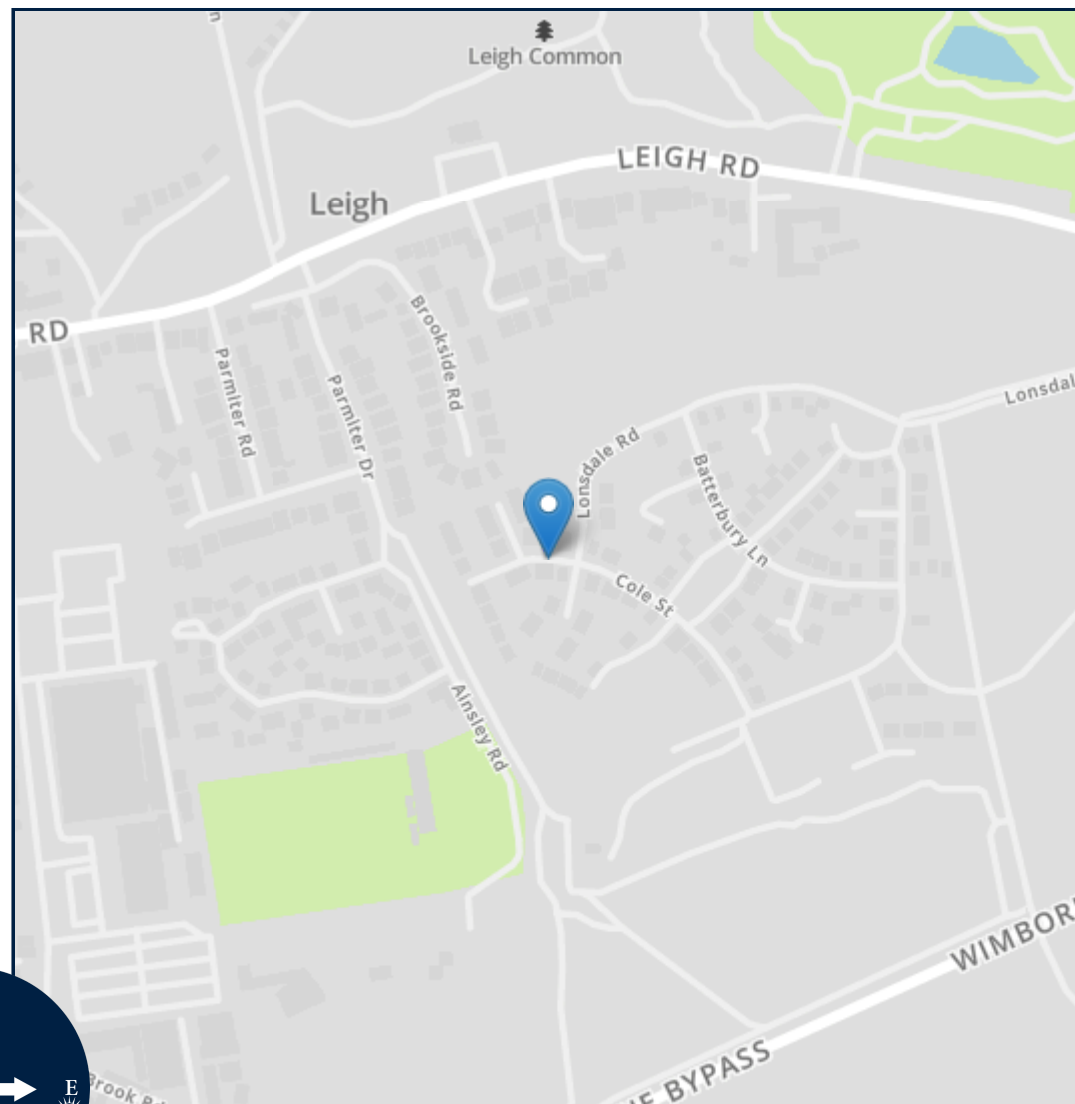
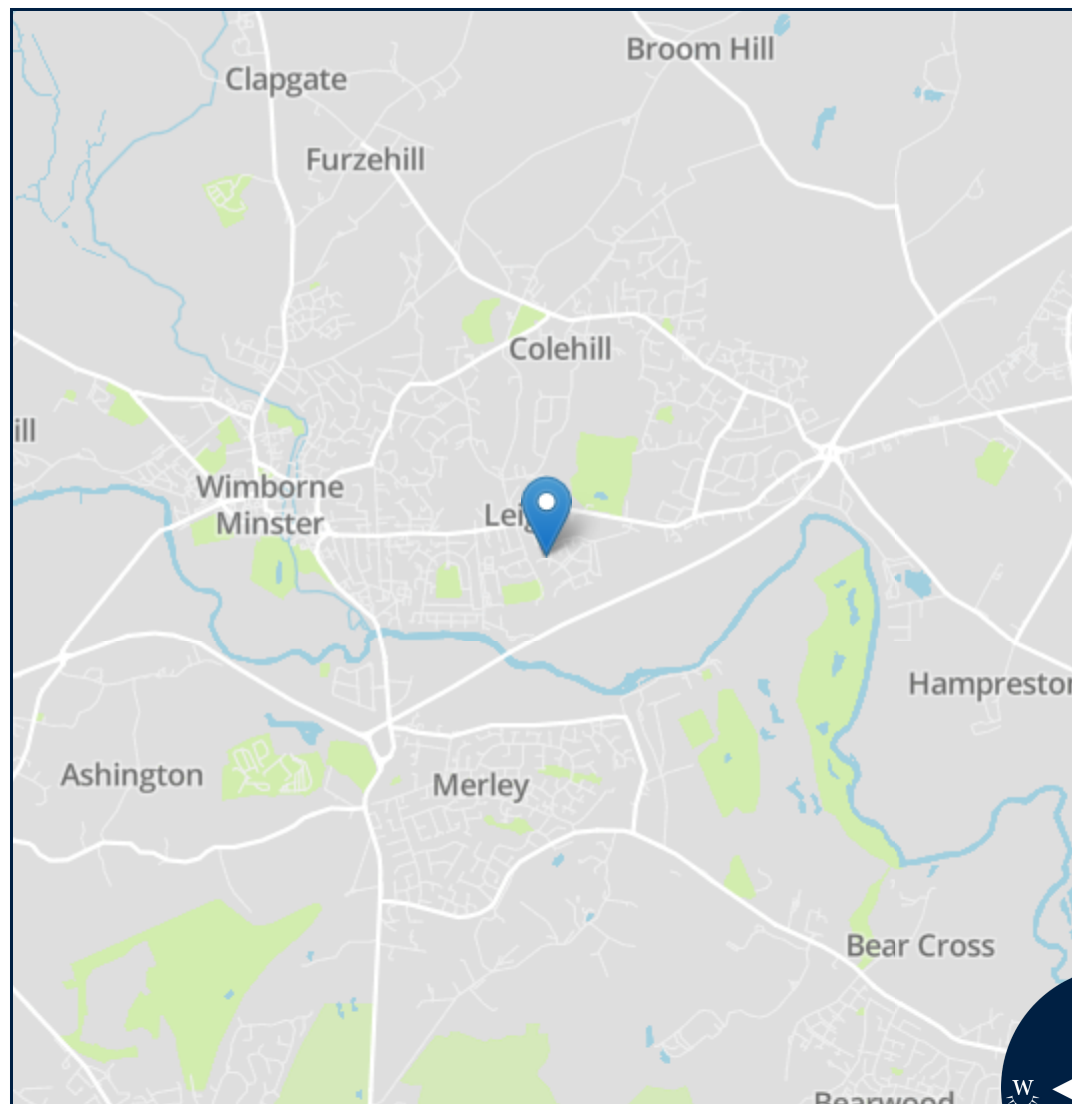

Energy Efficiency Rating	
	Potential
Very energy efficient - lower running costs	
(92-100) A	97
(81-91) B	84
(69-80) C	
(55-68) D	
(39-54) E	
(21-38) F	
(1-20) G	
Not energy efficient - higher running costs	
England, Scotland & Wales	EU Directive 2002/91/EC



Important notice: Fisks Estate Agents, their clients and any joint agents give notice that 1: They are not authorised to make or give any representations or warranties in relation to the property either here or elsewhere, either on their own behalf or on behalf of their client or otherwise. They assume no responsibility for any statement that may be made in these particulars. These particulars do not form part of any offer or contract and must not be relied upon as statements or representations of fact. 2: Any areas, measurements or distances are approximate. The text, photographs and plans are for guidance only and are not necessarily comprehensive. It should not be assumed that the property has all necessary planning, building regulation or other consents and Fisks Estate Agents have not tested any services, equipment or facilities. Purchasers must satisfy themselves by inspection or otherwise.



12 East Street, Wimborne,
Dorset, BH21 1DS
www.fisksestateagents.co.uk
01202 880000