

FOR SALE



16 Newlands, Letchworth Garden City, Hertfordshire. SG6 2JE

£925,000

-  Type: Detached House
-  Reception Rooms: 3
-  Tenure: Freehold
-  Council Tax: Band E
-  Bedrooms: 5
-  Bathrooms: 2
-  EPC Rating: D

cp

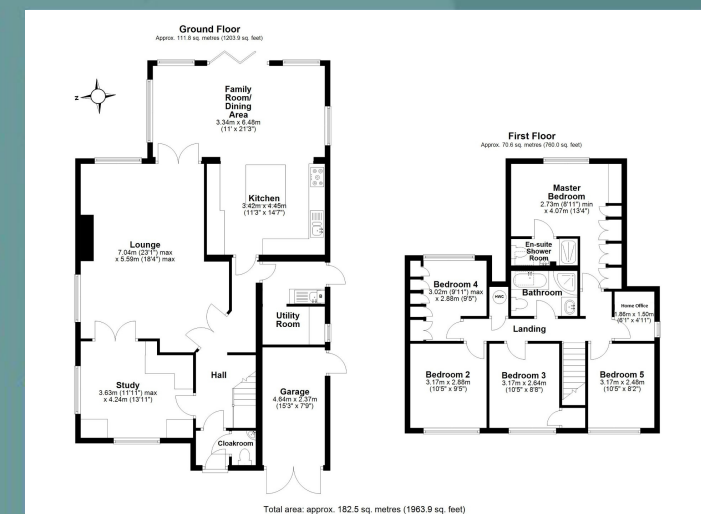

01462 481100 | simon.ellmers@country-properties.co.uk