





Over Lane, Belper, Derbyshire DE56 0HJ
£325,000 - Freehold



PROPERTY DESCRIPTION

Derbyshire Properties are pleased to present this detached dormer bungalow offered for sale with no upward chain. Occupying impressive plot with spacious and versatile living accommodation throughout, we recommend an early internal inspection to avoid disappointment.

Internally, the property briefly comprises; Front Porch, Entrance Hall, Lounge, Kitchen, Utility Room, Bathroom, Separate WC, Conservatory to the rear, two double Bedrooms and one single Bedroom/Study to the ground floor with further Loft Room to the first floor.

Externally, the property benefits from off street parking for several vehicles to the front and side elevation. The front lawn also houses the capacity to convert into further parking but is currently home to mature shrubbery. The rear enclosed garden is mainly laid to lawn whilst benefitting from patio which forms the ideal space to host or relax. The entire space is bordered by mature shrubbery allowing for privacy whilst timber fencing secures the space making it ideal for those with pets and young children.

POINTS OF INTEREST

- Spacious And Versatile Accommodation
- Extended Detached Bungalow
- Walking Distance into Belper Town
- Ideal For Access to A38
- Driveway Parking for several vehicles
- Rear Enclosed garden
- Family Home With Impressive Plot
- Family Home with Potential

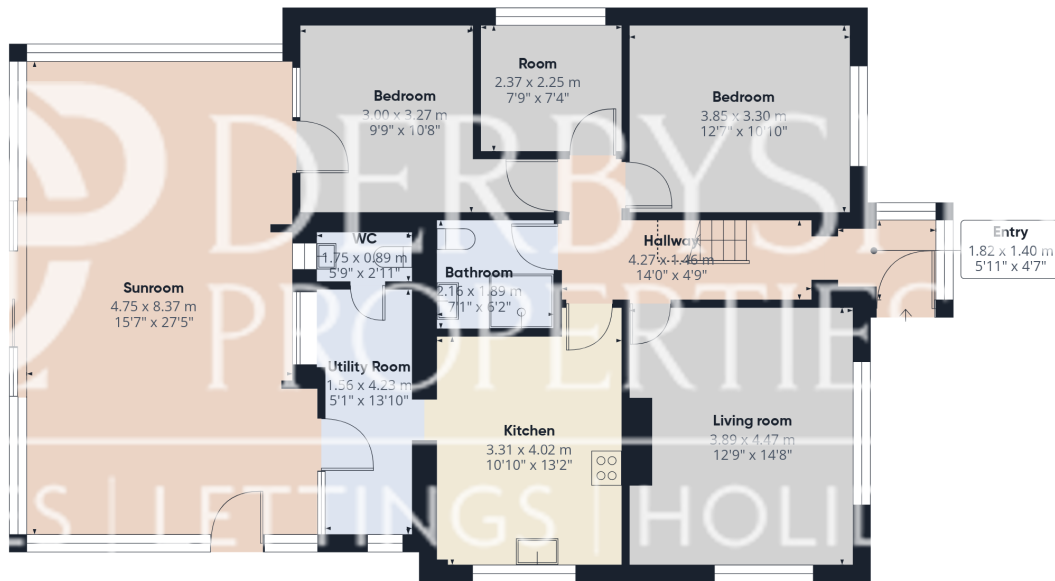

Ground Floor

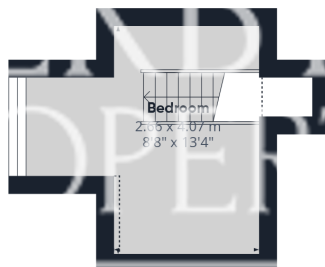

Floor 1

Approximate total area⁽¹⁾

135.5 m²

1457 ft²

Reduced headroom

1.4 m²

15 ft²

(1) Excluding balconies and terraces

Reduced headroom

..... Below 1.5 m/5 ft

Calculations reference the RICS IPMS 3C standard. Measurements are approximate and not to scale. This floor plan is intended for illustration only.

GIRAFFE360