

FOR SALE

Offers in Excess of £525,000

Manor Drive, Upton, Wirral. CH49 6JF



Stunning hidden gem! Tucked away down the private lane of The Stables off Manor Drive is this four bedroom, detached family home. Finished to a high specification throughout, the current owners have transformed this property to tick every box for a buyer. From the spacious reception rooms to the beautiful en-suite to the master and private rear garden, you also find yourself close to local amenities with great transport links and reputable schools on your doorstep. Spanning over 2,000sqft, this extensive home must be viewed to appreciate everything on offer.





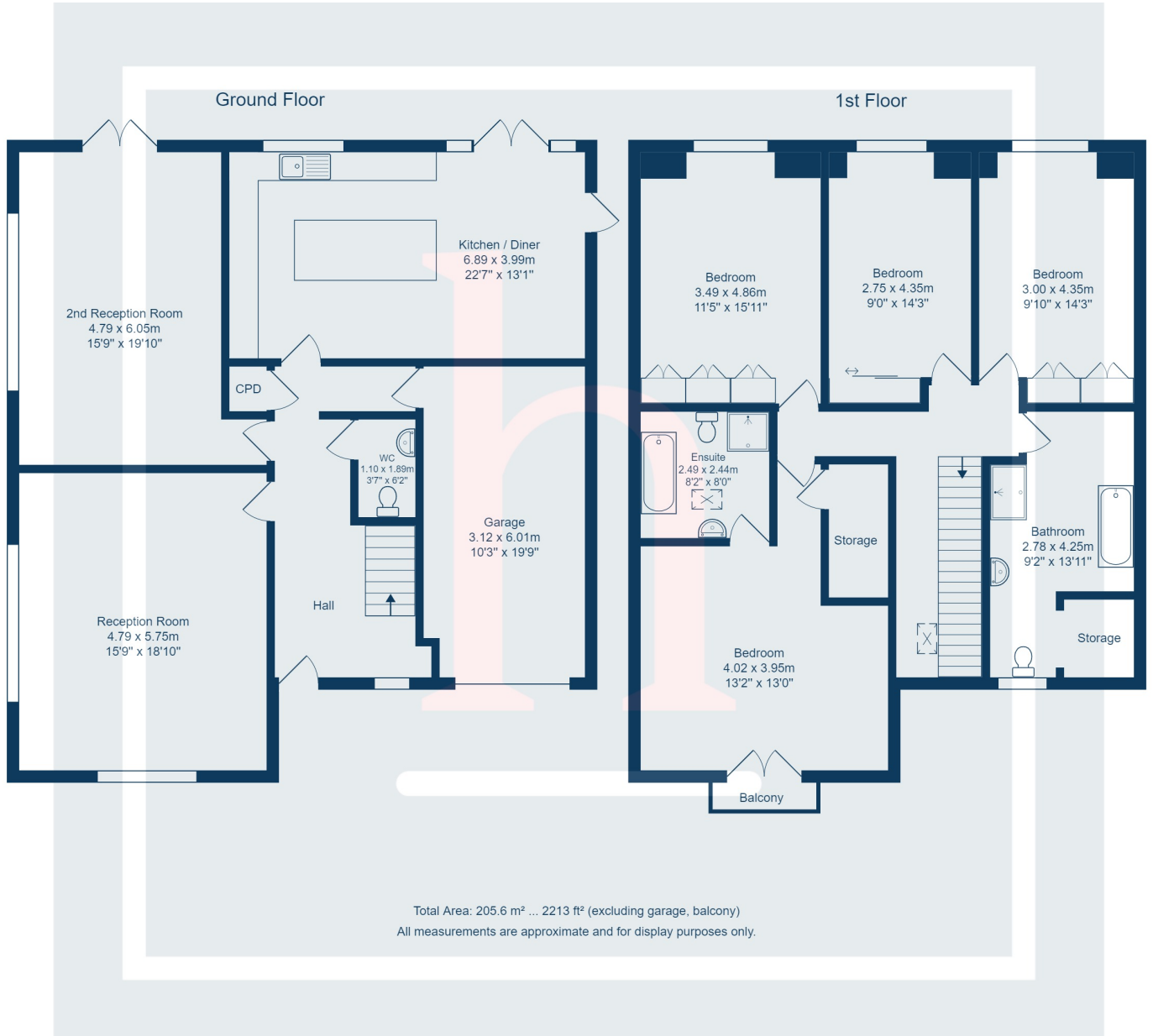

Energy Efficiency Rating		Current	Potential
Very energy efficient - lower running costs			
(92+)	A		
(81-91)	B		
(69-80)	C	78	85
(55-68)	D		
(39-54)	E		
(21-38)	F		
(1-20)	G		
Not energy efficient - higher running costs			
England, Scotland & Wales		EU Directive 2002/91/EC	