



Flat 7 Shellbourne House, Marina, Bexhill-on-Sea, East Sussex, TN40 1BL

£270,000



- Top Floor Apartment For Sale
- South Facing Balcony With Uninterrupted Views
- Spacious Lounge With South Facing Aspect
- Modern Fitted Kitchen
- Two Double Bedrooms
- Modern Fitted Bathroom
- Light & Airy Entrance Hall
- Stunning Panoramic Sea Views
- Long Lease
- Good Condition Throughout
- Viewing Highly Recommended





TOP FLOOR FLAT
729 sq.ft. (67.7 sq.m.) approx.

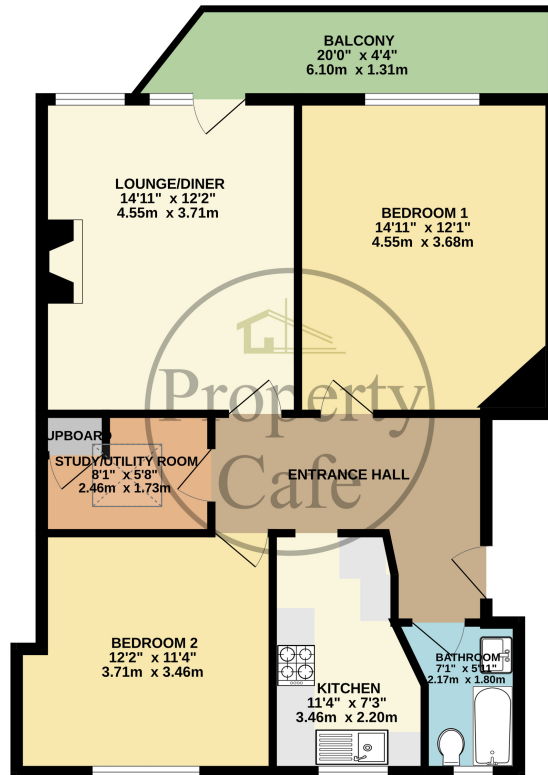

TOTAL FLOOR AREA : 729 sq.ft. (67.7 sq.m.) approx.

Whilst every attempt has been made to ensure the accuracy of the floorplan contained here, measurements of doors, windows, rooms and any other items are approximate and no responsibility is taken for any error, omission or mis-statement. This plan is for illustrative purposes only and should be used as such by any prospective purchaser. The services, systems and appliances shown have not been tested and no guarantee as to their operability or efficiency can be given.
Made with Metropix 12/2014