



FELLS GULLIVER  
ESTATE AGENTS

023 8028 4411  
[www.fellsgulliver.com](http://www.fellsgulliver.com)

70 Lyndhurst Park, Glasshayes Way, Lyndhurst, HampshireSO43 7ET

---

£650,000

- Brand new modern kitchen with Quartz worktops
- Integrated appliances including a dishwasher and washer / dryer
- Just a few minutes walk to Boltons Bench
- 10 year warranty
- Parking for two cars
- New development, by Hoburne Development with just six homes available
- Located on Lyndhurst High Street
- Investment opportunity
- Open plan living space
- Turf included to the rear garden

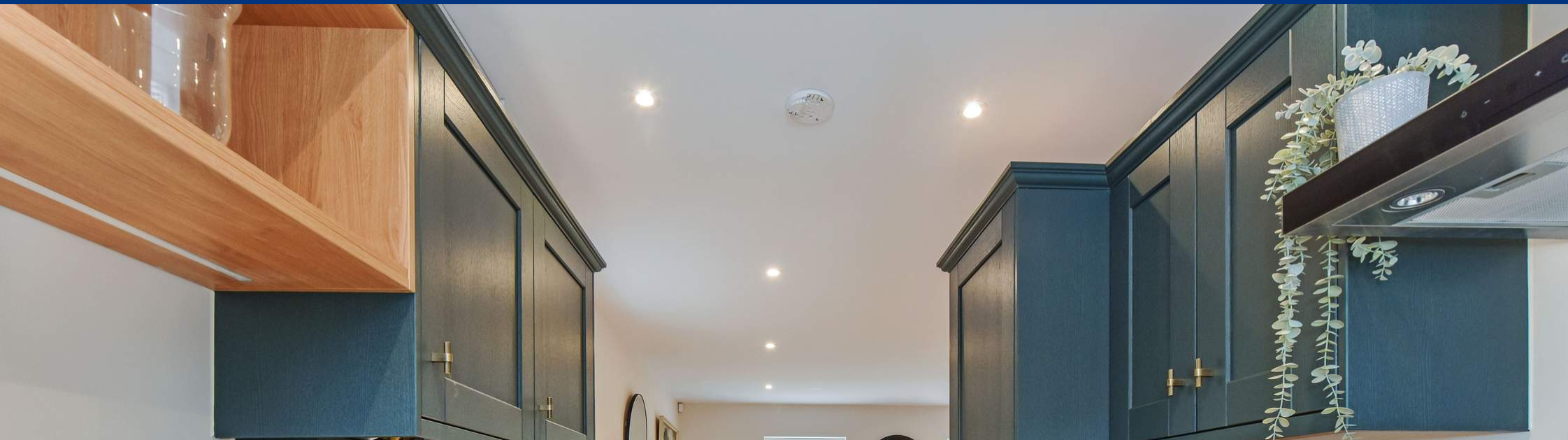



3



2



1

An opportunity to purchase a brand new house in this amazing development, with just six homes available. [Show home now available to view.](#)



Located on Lyndhurst High Street in the New Forest National Park, not only will Lyndhurst Park offer the tranquillity of country living, it also has the added convenience of amenities just steps away. With a range of independent boutiques, gift shops and eateries on your doorstep and open forest close by, you will have the best of both worlds.

Nearly complete, these stunning three-bedroom homes, offer open plan living space with underfloor heating throughout the ground floor. The lounge and bedrooms are fitted with carpets, whilst all wet areas, including the kitchen, feature contemporary LVT (Luxury Vinyl Tile) flooring. The kitchen includes shaker style doors with quartz work surfaces and a range of integrated appliances. These include an electric fan oven, microwave, induction hob, fridge/freezer, dishwasher and combination washer/dryer. French doors in the open plan living area lead directly to the rear garden, finished with turf. On the ground floor, there is also a convenient WC and storage space.

Upstairs you will find three double bedrooms with an en-suite shower room to the principal bedroom and a family bathroom. All bathrooms are fitted with Dornbracht sanitaryware with Water Efficient Valves.







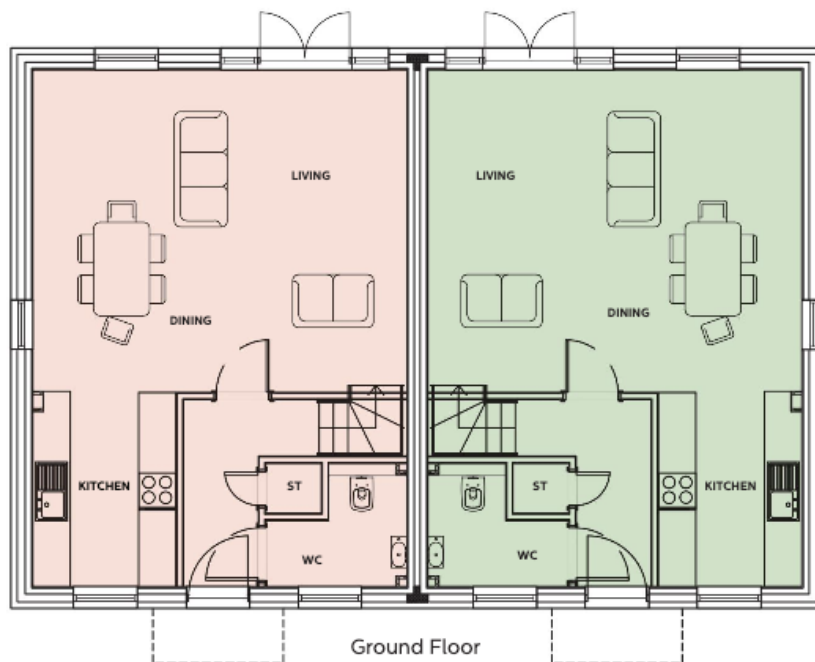

Kitchen Area: 9' 9" x 7' 6"

Living Area: 17' x 19' 5"

Bedroom 1: 11' 5" x 11' 5"

Bedroom 2: 11' 8" x 10' 5"

Bedroom 3: 11' 8" x 8' 9"

**1** Three bedroom  
semi-detached house (1076 ft<sup>2</sup>) **£650,000**

**2** Three bedroom  
semi-detached house (1076 ft<sup>2</sup>) **£635,000**

All measurements are approximate and for display purposes only.





FELLS GULLIVER  
ESTATE AGENTS

023 8028 4411  
[www.fellsgulliver.com](http://www.fellsgulliver.com)