

FOR SALE

£325,000

Sandringham Road, Maidenhead, Berkshire. SL6



Peter Gamble & Co. proudly offer to the market this spacious 2 bedroom maisonette with PRIVATE GARDEN and GARAGE!

Situated just round the corner from Furze Platt station. The property is set back from the main road and benefits from easy access to local convenience stores with Maidenhead town centre just 15 minutes walk and Cookham Village less than five minutes drive.

This first floor property has been modernised by the current owners, set out over 62 sq/m allows for a large flexible living space and a bright and airy feel.





Sandringham Road

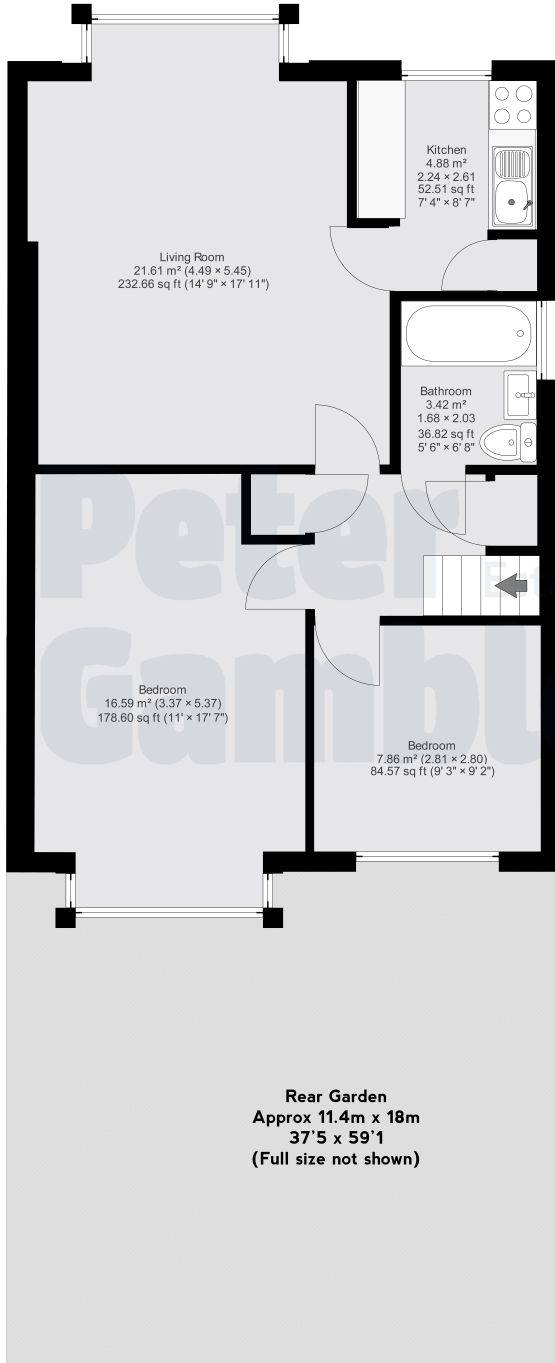

**APPROX. GROSS INTERNAL
FLOOR AREA: 62.8 sq. m / 676 sq.ft**

WHILST EVERY ATTEMPT HAS BEEN MADE TO ENSURE THE ACCURACY OF THE FLOOR PLAN CONTAINED HERE, NO RESPONSIBILITY IS TAKEN FOR ANY ERROR, OMISSION OR MIS-STATEMENT. THIS PLAN IS FOR ILLUSTRATIVE PURPOSES ONLY AND SHOULD BE USED AS SUCH CAN BE GIVEN
© Avasmo Energy

Rear Garden
Approx 11.4m x 18m
37'5 x 59'1
(Full size not shown)