



Hayfield Road
Birmingham
West Midlands
B13 9LQ

Offers in Excess of £122,000

bettermove 

Hayfield Road

Birmingham

Bettermove are proud to present this 1 bedroom Ground Floor Flat in Moseley, available with no forward chain.

The property benefits from double glazing, oil fired central heating throughout and has off street parking available. The council tax band is A.

This is a leasehold property with 129 years remaining on the lease; Ground rent & Service charges combined at £1,300 per annum.

The interior of this property comprises a spacious reception room, the fitted kitchen, one double bedroom and the bathroom located on the ground floor of the building.

Located in the popular residential area of Moseley, the property is close to a range of amenities, including shops, supermarkets, restaurants and pubs. Excellent transport connections can be found from Hall Green Train Station and many local bus routes providing easy access into Birmingham City Centre.

This exciting opportunity should not be missed! All enquiries can be made through Bettermove on 0330 004 0050.



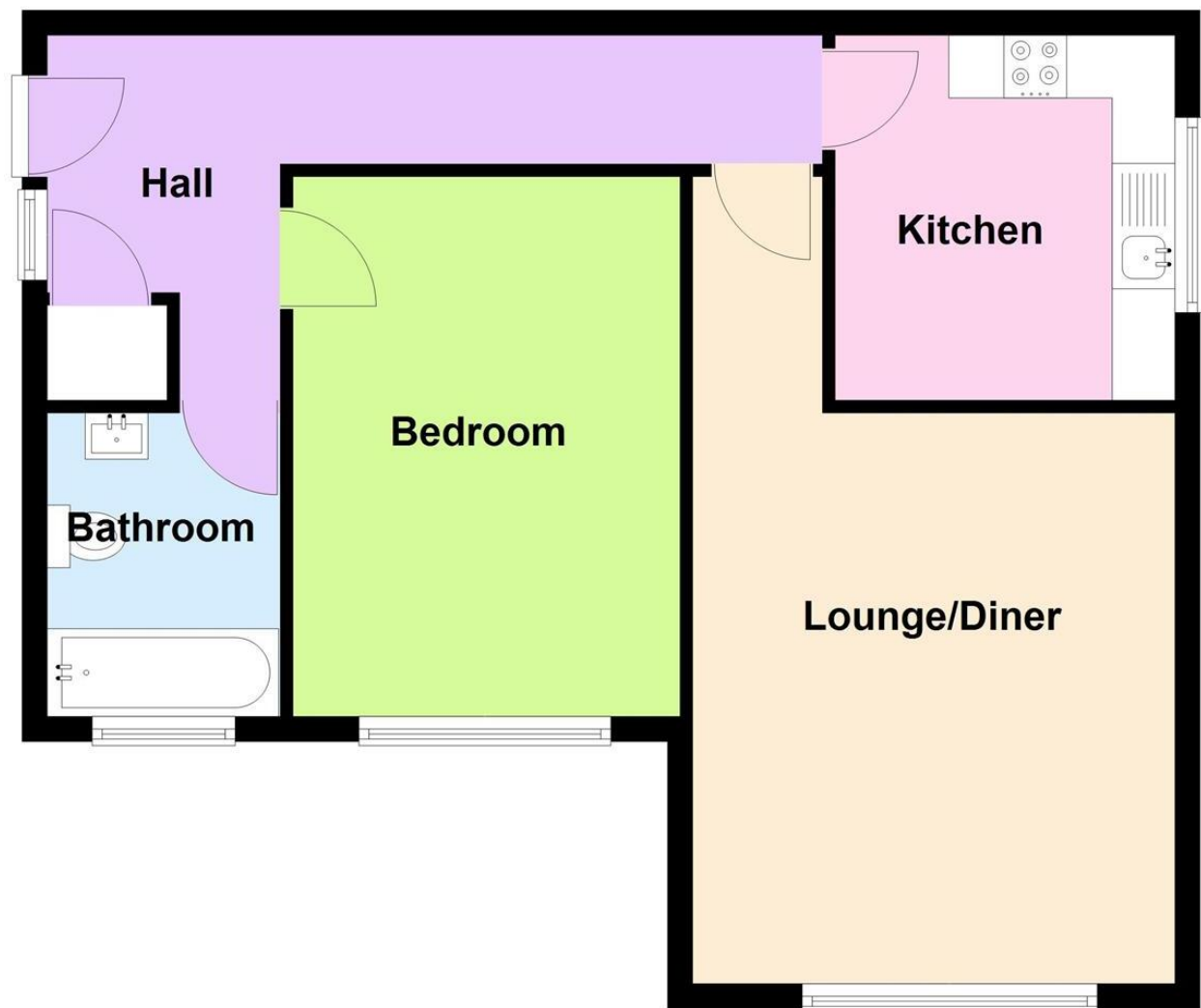



20-22 Bridge End, Leeds, LS1 4DJ
t: 0330 004 0050 e: hello@bettermove.co.uk
www.bettermove.co.uk

Please Note: These particulars, whilst believed to be accurate are set out as a general outline only for guidance and do not constitute any part of an offer or contract. Intending purchasers should not rely on them as statements of representations of fact, but must satisfy themselves by inspection or otherwise as to their accuracy. No person in this firm's employment has the authority to make or give any representation or warranty in respect of the property.