



28 Cavendish Street  
Keighley  
BD21 3RG



3 Fairfax Road, Cullingworth,  
Bradford, West Yorkshire, BD13  
5JQ

£249,995

T: 01535 664609

W: [www.dayandcoestateagents.co.uk](http://www.dayandcoestateagents.co.uk)

E: [keighley@dayandcoestateagents.co.uk](mailto:keighley@dayandcoestateagents.co.uk)

- MID TOWN HOUSE
- THREE BEDROOMS
- MODERN KITCHEN & BATHROOM

- WELL PRESENTED ACCOMMODATION
- DINING ROOM EXTENSION
- EPC RATING D

## SUMMARY

\*\* A BEAUTIFULLY PRESENTED THREE BEDROOM TOWN HOUSE, DINING ROOM EXTENSION, WELL APPOINTED MODERN KITCHEN WITH APPLIANCES, OUTSKIRTS OF THE POPULAR VILLAGE OF CULLINGWORTH, OPEN OUTLOOK TO THE FRONT, PLEASANT GARDENS, PARKING SPACE FOR 1 CAR, VIEWING ESSENTIAL TO FULLY APPRECIATE!! EPC Rating D \*\*

## FULL DESCRIPTION

Viewing is essential to fully appreciate this well presented, extended stone built three bedroom town house which has been much improved by its current owners, situated on the outskirts of the popular village of Cullingworth with an open outlook to the front. This desirable property offers accommodation which could suit a variety of buyers and is well worthy of an internal inspection. In brief comprises of an Entrance Porch, Hallway, Living Room with multifuel fire and windows to the front elevation, Kitchen which has a well appointed modern range of wall and base units, appliances that include, double oven, induction hob, extractor hood, fridge/freezer, dishwasher, washer, slim counter worktops. Dining Room which has windows to the rear and side along with entrance door. First Floor Landing which has loft hatch with drop down ladder, part boarded, roof window. Three Bedrooms and completing the accommodation is a modern shower room which comprises of a good sized shower, w.c., wash basin, window to the rear. Gas Central Heating & Double Glazing. Outside 1 parking space at the front, front garden, garden and patio to the rear, garden shed. No Onward Chain. EPC Rating D

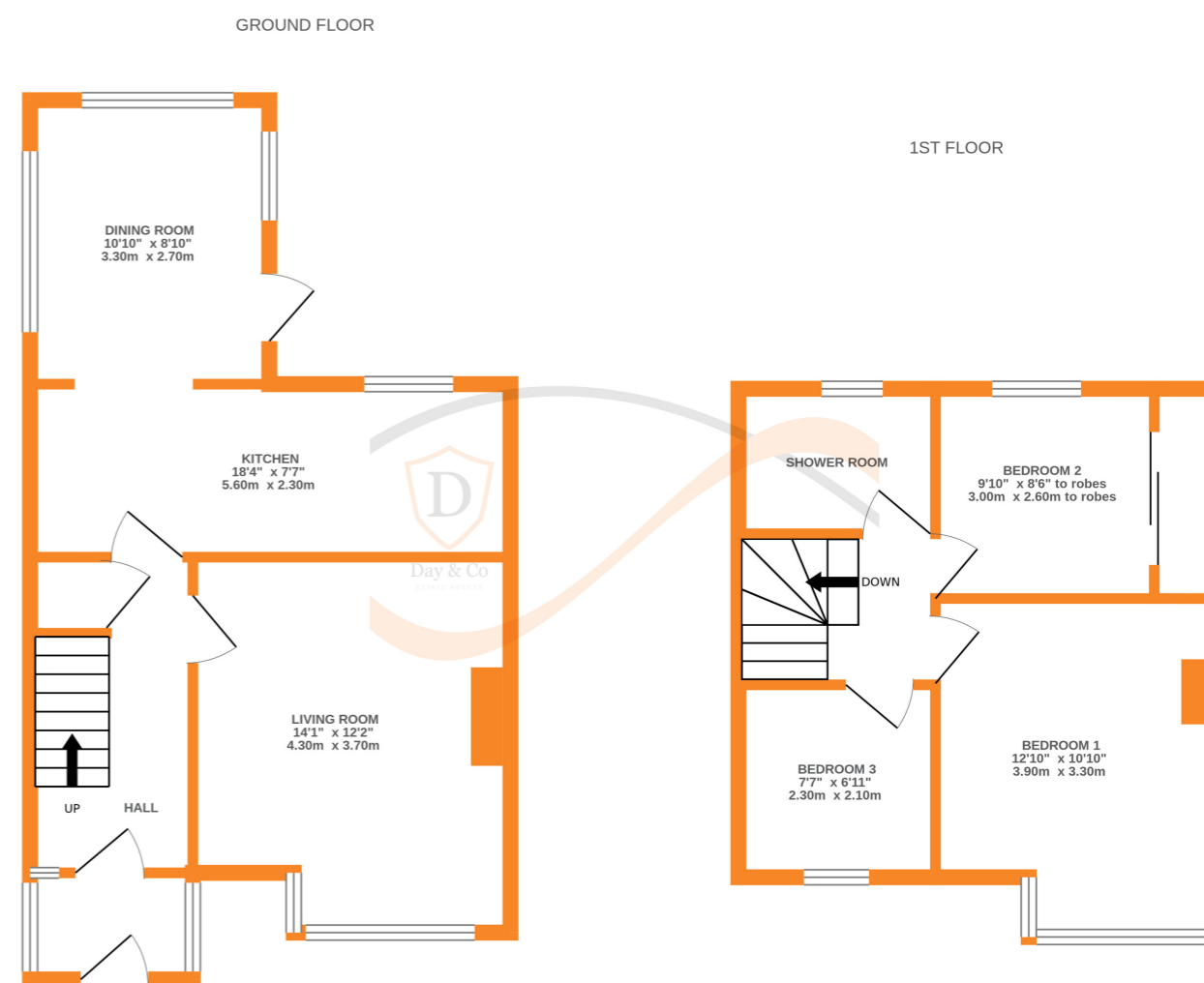

Whilst every attempt has been made to ensure the accuracy of the floorplan contained here, measurements of doors, windows, rooms and any other items are approximate and no responsibility is taken for any error, omission or mis-statement. This plan is for illustrative purposes only and should be used as such by any prospective purchaser. The services, systems and appliances shown have not been tested and no guarantee as to their operability or efficiency can be given.  
Made with Metropix ©2024