



Sale Drive, Clothall Common, Baldock, Hertfordshire. SG7





3 Bedroom End of Terrace House

£1,495 pcm

Additional charges may apply

A SUPERB three-bedroom end of terrace home located in the forever sought after location of Clothall Common. This property has been NEWLY decorated and has a good-sized living room that leads you through to a kitchen / diner and also benefits from a downstairs cloakroom just off the entrance hall. Upstairs there are TWO double bedrooms, a smaller third bedroom and a three-piece bathroom suite. Further compliments are a GARAGE & DRIVEWAY for one car to the side of the property and an enclosed rear garden.

- ****PETS CONSIDERED****
- THREE bedroom house
- Garage & parking to the side
- Walking distance from mainline station
- End of Terrace House
- Good sized lounge with separate kitchen
- Popular Clothall Common Estate
- Enclosed rear garden
- Available Early April!
- EPC Rating D

A SUPERB three-bedroom end of terrace home located in the forever sought after location of Clothall Common. This property has been NEWLY decorated and has a good-sized living room that leads you through to a kitchen / diner and also benefits from a downstairs cloakroom just off the entrance hall. Upstairs there are TWO double bedrooms, a smaller third bedroom and a three-piece bathroom suite. Further compliments are a GARAGE & DRIVEWAY for one car to the side of the property and an enclosed rear garden. This fantastic home is available Early April! View ASAP to avoid disappointment!

LOCATION

Located on the popular Clothall Common Estate in Baldock this property is in an ideal spot for those that commute via train or car. The mainline train station is just over a 5-minute walk away (0.3 miles) offering fantastic rail links into London's Kings Cross & Cambridge. There is easy access to all the main roads such as the A1, A505 & A507 and all are a few minutes' drive away. The hustle and bustle of Baldock's vibrant town centre is again only a short walk away offering coffee shops, pubs, restaurants, hair salons and so much more.

ABOUT BALDOCK

Baldock is a vibrant town with a strong sense of community and is a beautiful place to live.

There are many local events and festivals that take place throughout the year, including the Baldock Festival, which is a celebration of the town's history and culture. The town also has a thriving arts scene, with many local artists and musicians showcasing their work in galleries and venues around the town. Baldock is also home to a number of excellent restaurants and cafes, serving a range of delicious cuisines from around the world. Baldock town has a friendly and welcoming atmosphere, and there is always something to see or do. Whether you are interested in history, culture, or simply enjoying the great outdoors, Baldock has something to offer everyone. With its beautiful countryside, rich history, and vibrant community, Baldock town is a fantastic place to live.

Council Tax Band - D

A security deposit is payable at the time of your offer being accepted by the landlord/s. This is equivalent to one week's rent and for this property is £344.40. This does then form part of your five-week holding deposit meaning once all satisfactory references are passed you will then be required to pay £1,377.60. For more information, please contact the office.



These particulars are a guide only and do not constitute an offer or a contract. The floor plan is for identification purposes only and not to scale. All measurements are approximate and should not be relied upon if ordering furniture, white goods and flooring etc. We have presented the property as we feel fairly describes it but before arranging a viewing or deciding to let, should there be anything specific you would like to know about the property please enquire. Satchells have not tested any of the appliances or carried out any form of survey and advise you to carry out your own investigations on the state, condition, structure, services, title, tenure, and council tax band of the property or the tenancy terms. Some images may have been enhanced and the contents shown may not be included in the letting. Satchells routinely refer to 3rd party services for which we receive an income from their fee. If you would like us to refer you to one of these services please ask one of our staff who will pass your details on. We advise you check the availability of the property on the day of your viewing.



Ground Floor

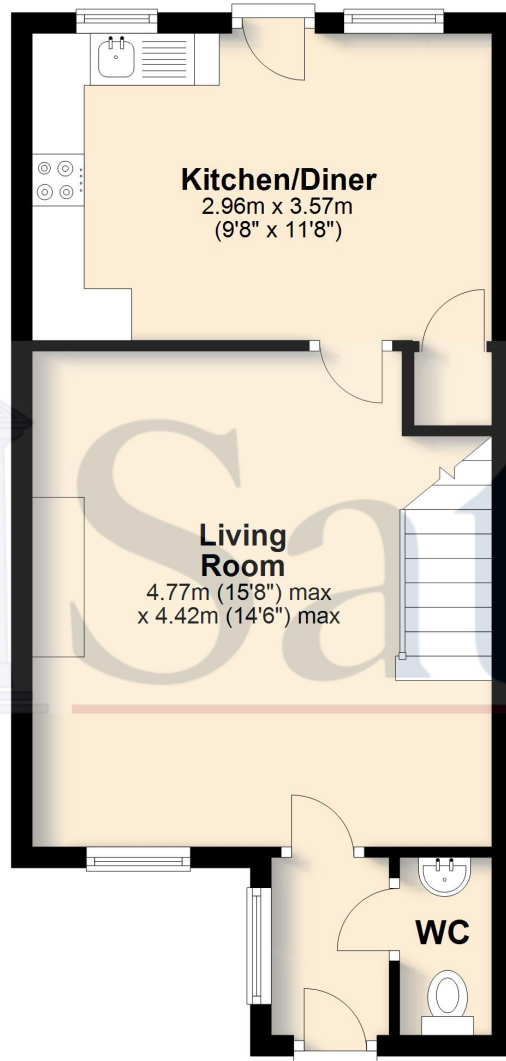

First Floor

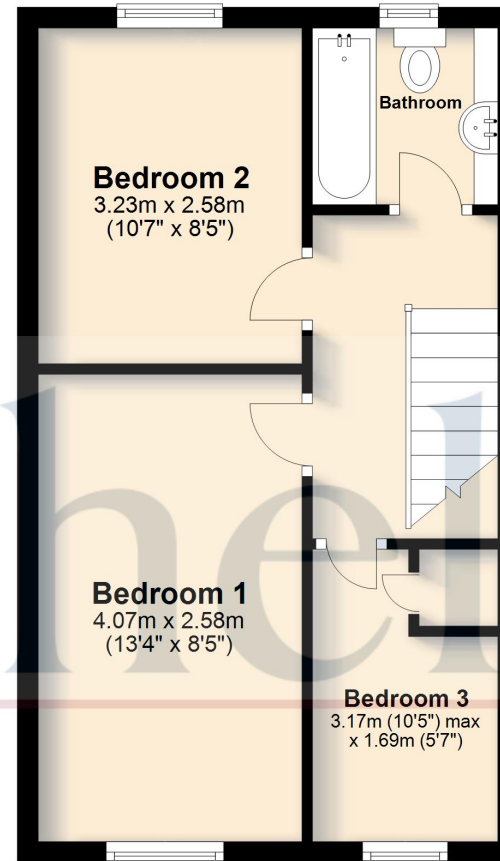

For illustrative purposes only - NOT TO SCALE - Measurements shown are approximate. The size and position of doors, windows, appliances and other features are approximate.
Plan produced using PlanUp.