

3 Bedroom(s), End of Terrace House, Freehold

Norman Crescent, New Rossington.



- 3D Virtual Tour Available
- Entrance Porch
- Kitchen
- Spacious End of Terrace Property

- Sold with No Onwards Chain
- Open plan Lounge and Dining Area
- Three Bedrooms
- Fantastic Renovation Opportunity

£85,000
For Sale

Book your viewing today Tel: 01302 247754

Owner's View

3D Virtual Tour Available- Take a closer, more detailed look around via our 3D Virtual Tour! Don't forget that you can also check availability for viewings online via a visit to our website...

Ground Floor

Floor Plan

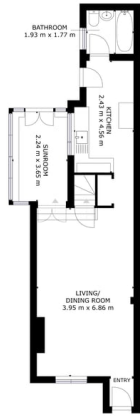

FLOOR 1

GROSS INTERNAL AREA
FLOOR 1: 25 m²; FLOOR 2: 37 m²
TOTAL: 62 m²
SIZES AND DIMENSIONS ARE APPROXIMATE. ACTUAL MAY VARY.



Open Plan Lounge Diner



Kitchen



Conservatory



Bathroom

First Floor

Floor Plan

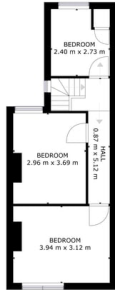

FLOOR 2

GROSS INTERNAL AREA
FLOOR 1: 25 sqm FLOOR 2: 37 sqm
TOTAL: 62 sqm
SIZES AND DIMENSIONS ARE APPROXIMATE. ACTUAL MAY VARY.



Bedroom



External

Front



Bedroom



Bedroom



Rear Garden

Property Information Form

Council Tax Band - A

Utilities - Mains Gas, Mains Electricity, Mains Water

Water Meter - Yes

Average Annual Electricity Bills -

Average Annual Gas Bills -

Average Annual Water Bills -

Tenure - Freehold

Solar Panels - No

Space Heating System -

Approximate Heating System Installation Date -

Water Heating System - Gas combi boiler

Approximate Water Heating Installation Date -

Boiler Location -

Approximate Electrical System Installation Date -

Approximate Electrical System Test Date -

Fires/Heaters -

Permanent Loft Ladder -

Loft Insulation -

Loft Boarded out -



We make it happen.

Tel: 01302 247754

Email: info@thepropertyhive.co.uk

Web: www.thepropertyhive.co.uk

Whilst every effort is made to ensure that the information contained in these particulars is reliable, they do not constitute or form part of an offer or any contract. The Property Hive accept no liability for the accuracy of the contents, and therefore they should be independently verified by prospective buyers or tenants before agreeing an offer. All measurements provided are approximate and should be verified before exchange of contracts. No appliances, fixtures or fittings have been tested and should be checked by the buyer before exchange of contracts to ensure they are in good working order.

All measurements provided are approximate and should be verified before exchange of contracts. No appliances have been tested and should be checked to ensure they are in good working order.

Energy Performance Certificate

