



Aspen Place, Bushey Heath, WD23

**£1,700
pcm**



Aspen Place, Bushey Heath, WD23

Situated within a modern and sought-after development is this luxurious and generously proportioned one bedroom second floor (with lift) apartment offering 700 Sq Ft (65 Sq M) of internal space with key features including two allocated parking spaces and landscaped communal gardens.

This stylish apartment boasts a stunning kitchen/reception area with dining area, a spacious principal bedroom with a dedicated fitted wardrobe area and a contemporary en-suite featuring both a bathtub and separate walk-in shower. Further highlights include a separate guest WC, underfloor heating throughout, high-quality fixtures and fittings, and ample natural light.

Features

- Second Floor (with lift)
- Modern Development
- Two Allocated Parking Spaces
- Landscaped Communal Gardens
- Open Plan Kitchen/Reception
- Offered Furnished or Unfurnished
- Available From Early December
- Bedroom With Excellent Storage
- En-suite Featuring Bath & Shower
- Separate WC



Aspen Place, Bushey
Heath, WD23

Oak View, WD23 1FW

Approx Gross Internal Area = 65.3 sq m / 703 sq ft

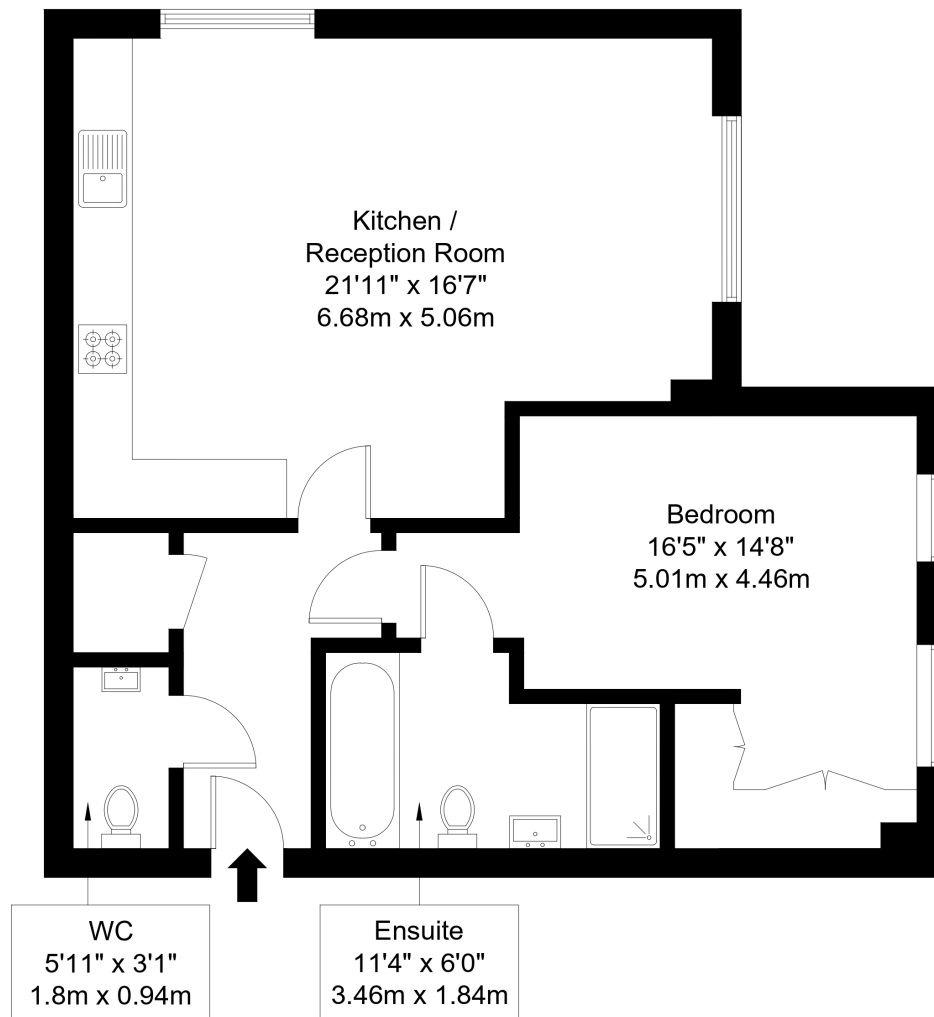
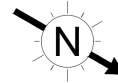

Second Floor

Ref :

Copyright **BLEU
PLAN**

The Floor plan is not to scale and measurements and areas shown are approximate and therefore should be used for illustrative purposes only. The plan has been prepared in accordance with the RICS code of Measuring Practice and whilst we have confidence in the information produced it must not be relied on. Maximum lengths and widths are represented on the floor plan. If there is any aspect of particular importance, you should carry out or commission your own inspection of the property.

Copyright @ BleuPlan