



5 Clifton Road, Henlow, Bedfordshire, SG16 6BL

£315,000

Well presented two bedroom period cottage situated on the outskirts of Henlow village. The spacious accommodation includes a living room with log burner, a separate dining room and a modern fitted kitchen. Upstairs there are two good size bedrooms as well as a useful loft room and shower room. Outside there is a front garden and a large private rear garden which includes a brick built garden office which has been recently renovated by the current owners.



5 Clifton Road, Henlow

Approximate Gross Internal Area
893 sq ft - 83 sq m

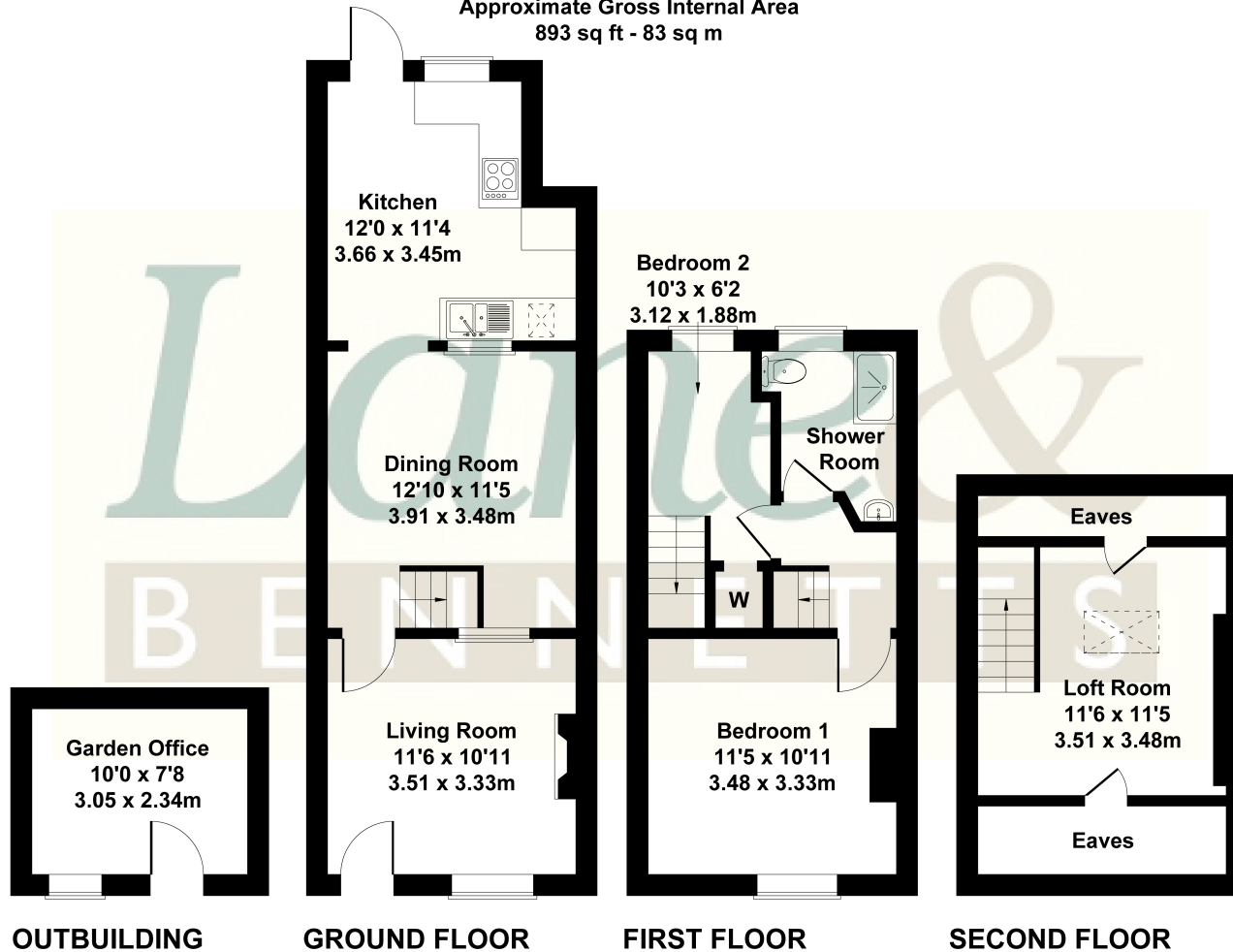

Not to Scale. Produced by The Plan Portal 2025
For Illustrative Purposes Only.

- TWO BEDROOM TERRACED PERIOD COTTAGE
- LARGE PRIVATE REAR GARDEN
- LIVING ROOM WITH LOG BURNER
- SEPARATE DINING ROOM
- MODERN FITTED KITCHEN
- TWO GOOD SIZE BEDROOMS
- SPACIOUS LOFT ROOM
- RENOVATED BRICK BUILT GARDEN OFFICE

