

Glebe Way, Mendlesham, Stowmarket



- THREE BED SEMI DETACHED HOUSE
- OPEN PLAN KITCHEN / DINER
- GARAGE AND OFF ROAD PARKING
- CLOSE TO LOCAL AMENITIES
- SOUTH FACING REAR GARDEN
- SPACIOUS LOUNGE
- POPULAR VILLAGE LOCATION
- OIL FIRED CENTRAL HEATING

MARKS & MANN



### Glebe Way, Mendlesham, Stowmarket

Offered for sale is this SEMI-DETACHED Three bedroom house with a SINGLE GARAGE, off road parking and SOUTH FACING rear garden. The home comprises of an OPEN-PLAN Kitchen/Dining room with French doors to the garden, spacious lounge, sizable main bedroom and family bathroom.

MARKS & MANN

99-101 Penshurst Rd, Ipswich, Suffolk, IP3 8QB.

01473 396 296

contactipswich@marksandmann.co.uk

Website www.marksandmann.co.uk

£260,000 Offers in Excess of

# Glebe Way, Mendlesham, Stowmarket

# Glebe Way, Mendlesham, Stowmarket

## GROUND FLOOR

### Hall

Plastered ceiling, overhead lighting, carpeted stairs leading to first floor and carpeted flooring.

### Lounge

4.36m x 3.37m (14' 4" x 11' 1")  
Plastered ceiling, overhead lighting, front aspect window, radiator, under stairs storage cupboard and wood effect flooring.

### Kitchen/Diner

4.25m x 3.21m (13' 11" x 10' 6")  
Plastered ceiling, overhead lighting, rear aspect window, rear aspect French doors, radiator and wood effect flooring.

## FIRST FLOOR

### Landing

Plastered ceiling, overhead lighting, airing cupboard and carpeted flooring.

### Bedroom One

4.38m x 2.69m (14' 4" x 8' 10")  
Plastered ceiling, overhead lighting, loft access hatch, front aspect window, radiator and carpeted flooring.

### Bedroom Two

2.55m x 2.39m (8' 4" x 7' 10")  
Plastered ceiling, overhead lighting, rear aspect window, radiator and carpeted flooring.

### Bedroom Three

2.39m x 2.29m (7' 10" x 7' 6")  
Plastered ceiling, overhead lighting, side aspect window, radiator and carpeted flooring.

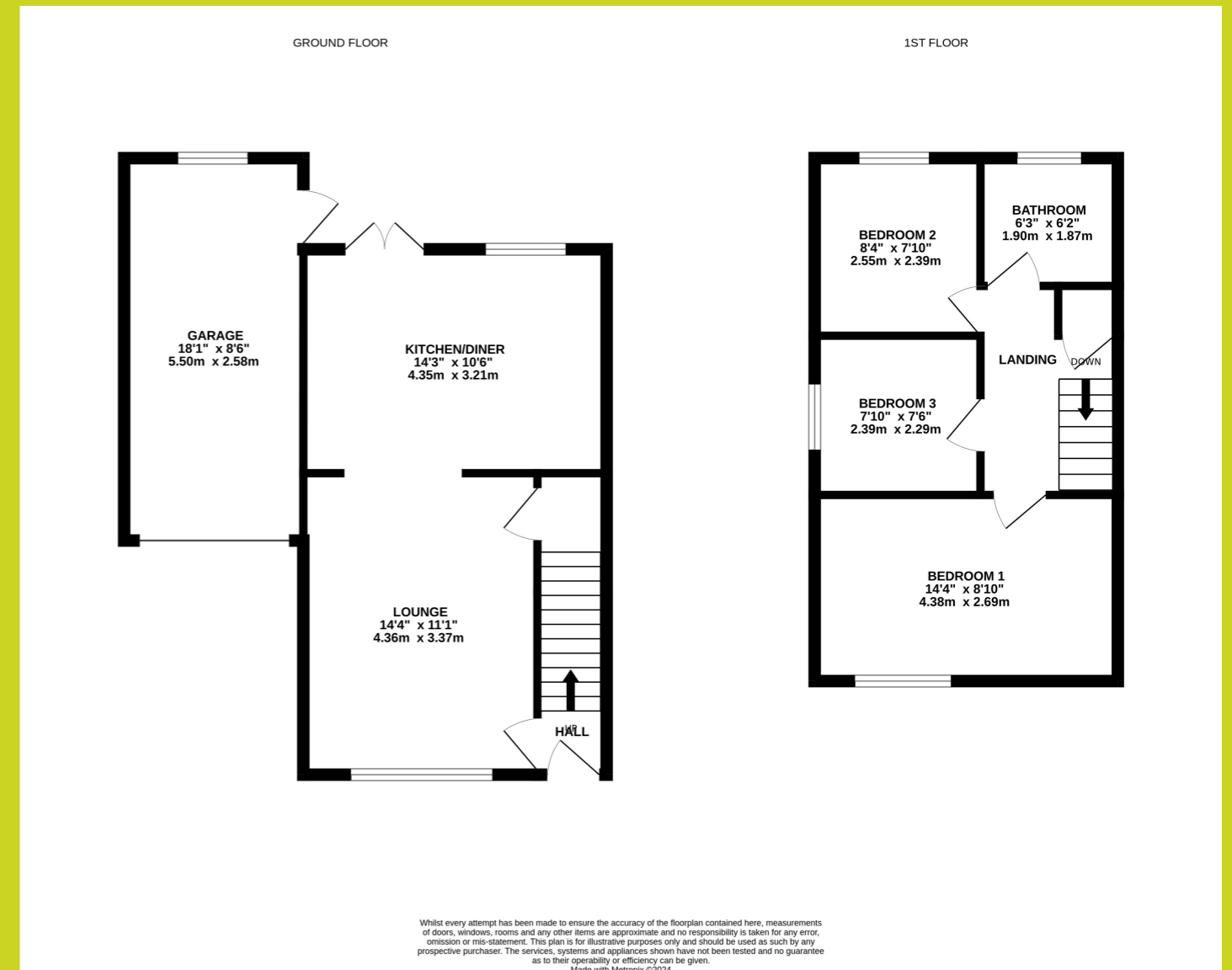

The above floor plans are not to scale and are shown for indication purposes only.

