

Located with close proximity to a local park and schools and just over 2 miles to Atria Watford shopping centre.

Bushey is a small residential town in the Hertsmere borough of Hertfordshire. With Watford on its doorstep and London a 30 minute train ride away. Excellent transport links via the M1 make the suburb easily accessible to surrounding areas.

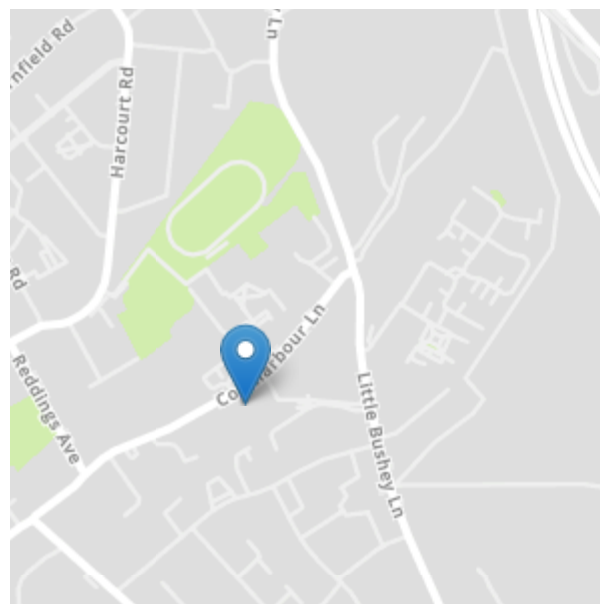

Coldharbour Lane, Bushey, Hertfordshire. £669,950 Freehold

A 1930's Built 3 Bedroom Semi Detached House set behind a deep 105ft frontage and boasting a 128 ft rear garden, situated in a sought after location close to local schools and a local park.

The property offers excellent scope for extension to the side and rear subject the usual planning permissions.

- 105ft Frontage
 - Ample Forecourt Parking
 - Garage
 - Bathroom - Separate WC
- 128ft Rear Garden
 - Extension Potential
 - Guest Cloakroom
 - Double glazed

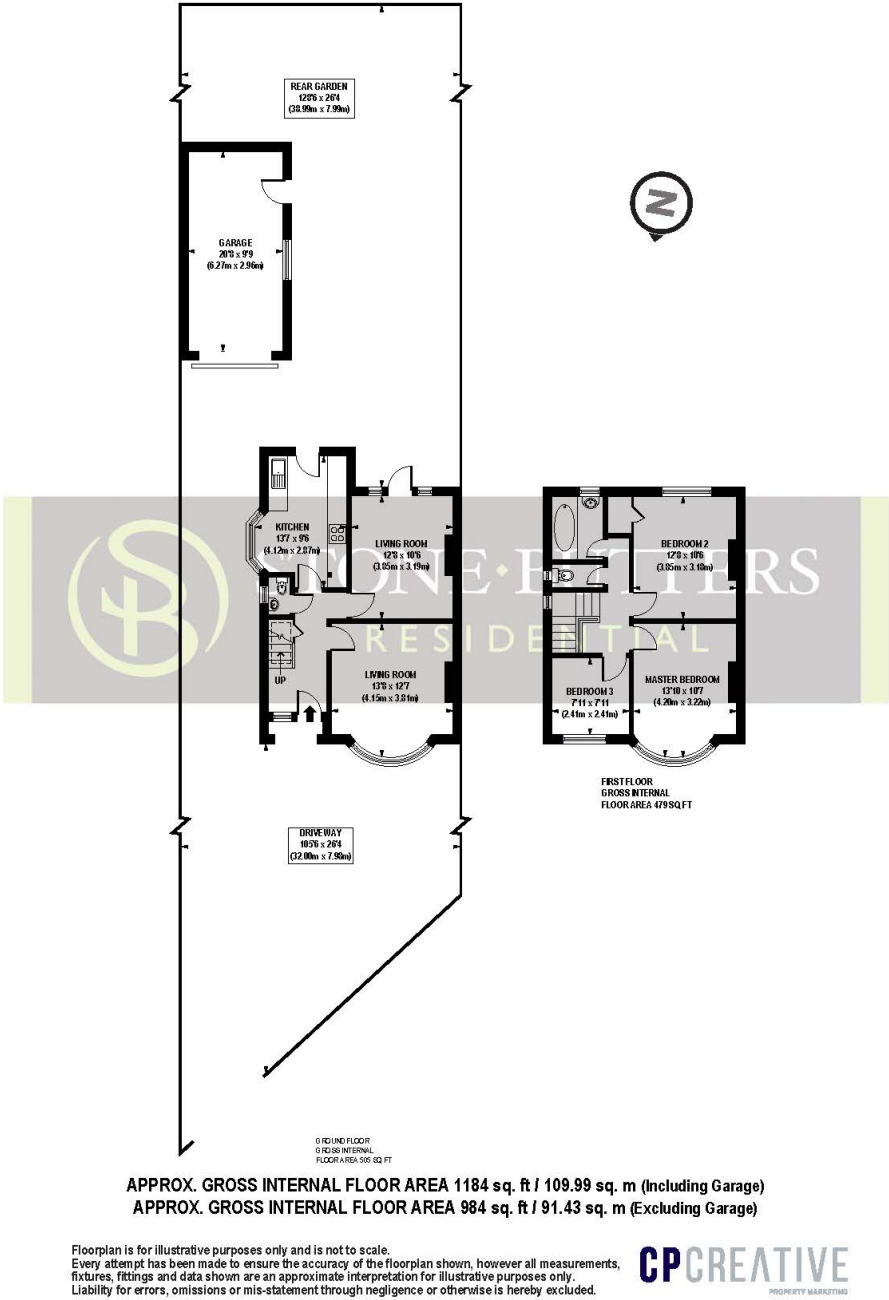

(Floor plans are not to scale and measurements are given for guidance only)

